

COOLEY ROAD 60'

N. 86°57'23"W

11

12

13

N. 86°57'23"W

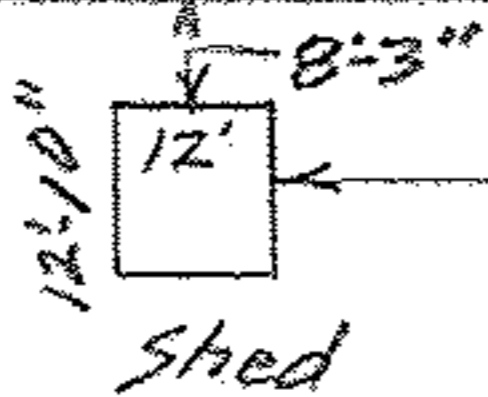

220'-8"

339.14'

200.02'

60'

HAWKE ROAD  
N. 2°08'37"E

N. 3°02'37"E

100'

14

Edward O. & Kathleen  
Gallagher

Sleg Drive

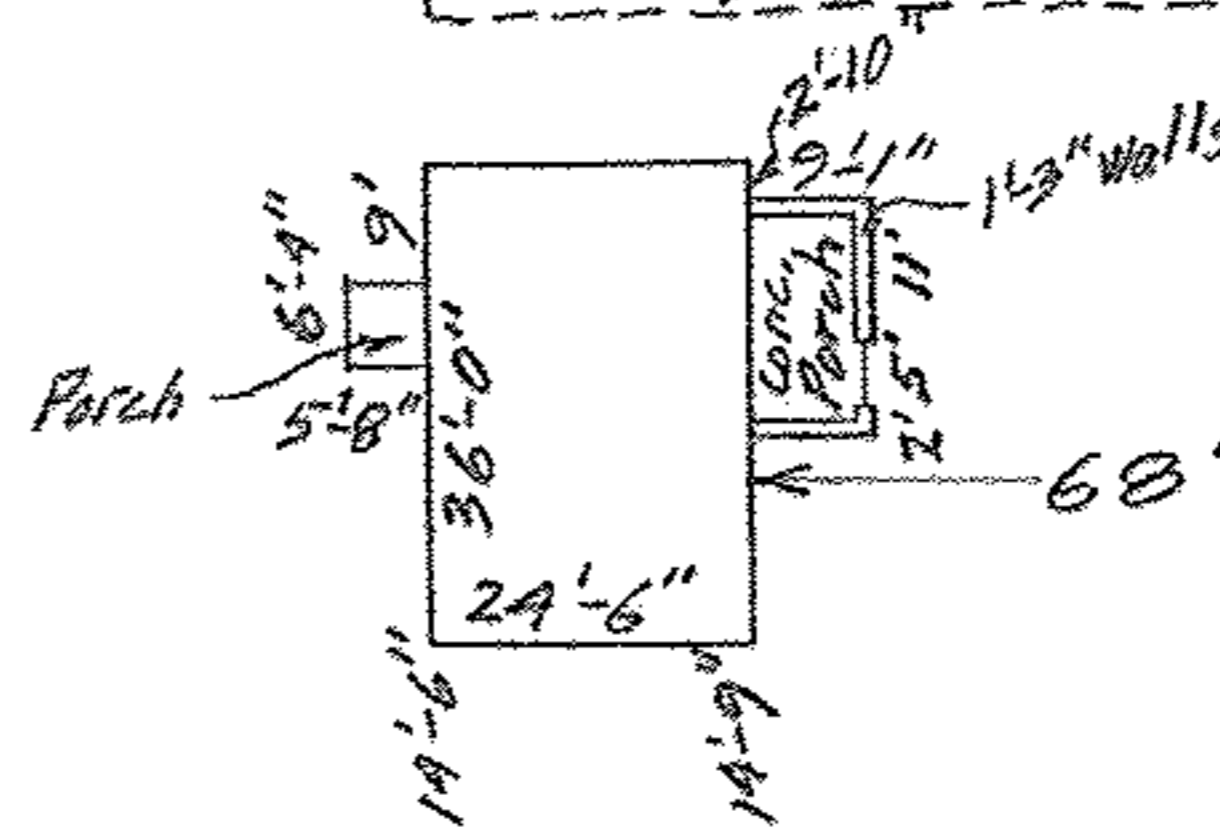

100'

N. 86°57'23"W

340.71

15

MAP OF SUB-LOT NO. 14

HAWKE - COOLEY ESTATES

VOL. 17 PG. 11

ORIG. LOT 7

EATON TOWNSHIP

LORAIN COUNTY

OHIO

SCALE: 1" = 40'

DEC. 21-1963

1:00 P.M.

Mary E. Penfound

REG. SURVEYOR

W W

