

LOT SPLIT PARCEL

MARK	COURSE	DIST.
1	DUE EAST	188.60
2	DUE SOUTH	30.00
3	S 21° 08' 39" E	60.54
4	S 0° 43' 46" W	149.23
5	N 89° 49' 26" W	78.10
6	S 46° 13' 34" W	26.44
7	S 12° 08' 34" E	14.98
8	S 75° 01' 13" W	29.02
9	DUE SOUTH	21.99
10	N 89° 57' 50" W	86.46
11	DUE NORTH	297.82

1.254 ACRES

EASEMENT

MARK	COURSE	DIST.
12	DUE EAST	3.40
13	DUE EAST	10.16
14	S 10° 25' 25" E	127.01
15	S 1° 35' 25" E	89.14
16	R: 33.001 Δ: 180° A: 103.67 C: N 88° 24' 35" E	66.00
17	S 48° 21' 30" E	34.50
6	S 46° 13' 34" W	26.44
7	S 12° 08' 34" E	14.98
8	S 75° 01' 13" W	29.02
9	DUE SOUTH	21.99
18	N 89° 57' 50" W	33.57
19	N 1° 35' 25" W	37.30
20	S 83° 24' 35" W	43.74
21	DUE NORTH	80.95
22	N 65° 06' 35" E	21.36
23	N 1° 35' 25" W	45.60
24	N 10° 25' 25" W	128.03

RESIDUAL LAND

MARK	COURSE	DIST.
25	DUE WEST	15.00
26	DUE WEST	97.55
2	DUE SOUTH	30.00
3	S 21° 08' 39" E	60.54
4	S 0° 43' 46" W	149.23
5	N 89° 49' 26" W	78.10
6	S 46° 13' 34" W	26.44
7	S 12° 08' 34" E	14.98
8	S 75° 01' 13" W	29.02
9	DUE SOUTH	21.99
10	N 89° 57' 50" W	86.46
27	DUE SOUTH	586.18
28	N 37° 19' 30" E	382.00
29	DUE NORTH	4.123
30	N 37° 19' 30" E	89.93
31	DUE NORTH	467.48

3.268 ACRES

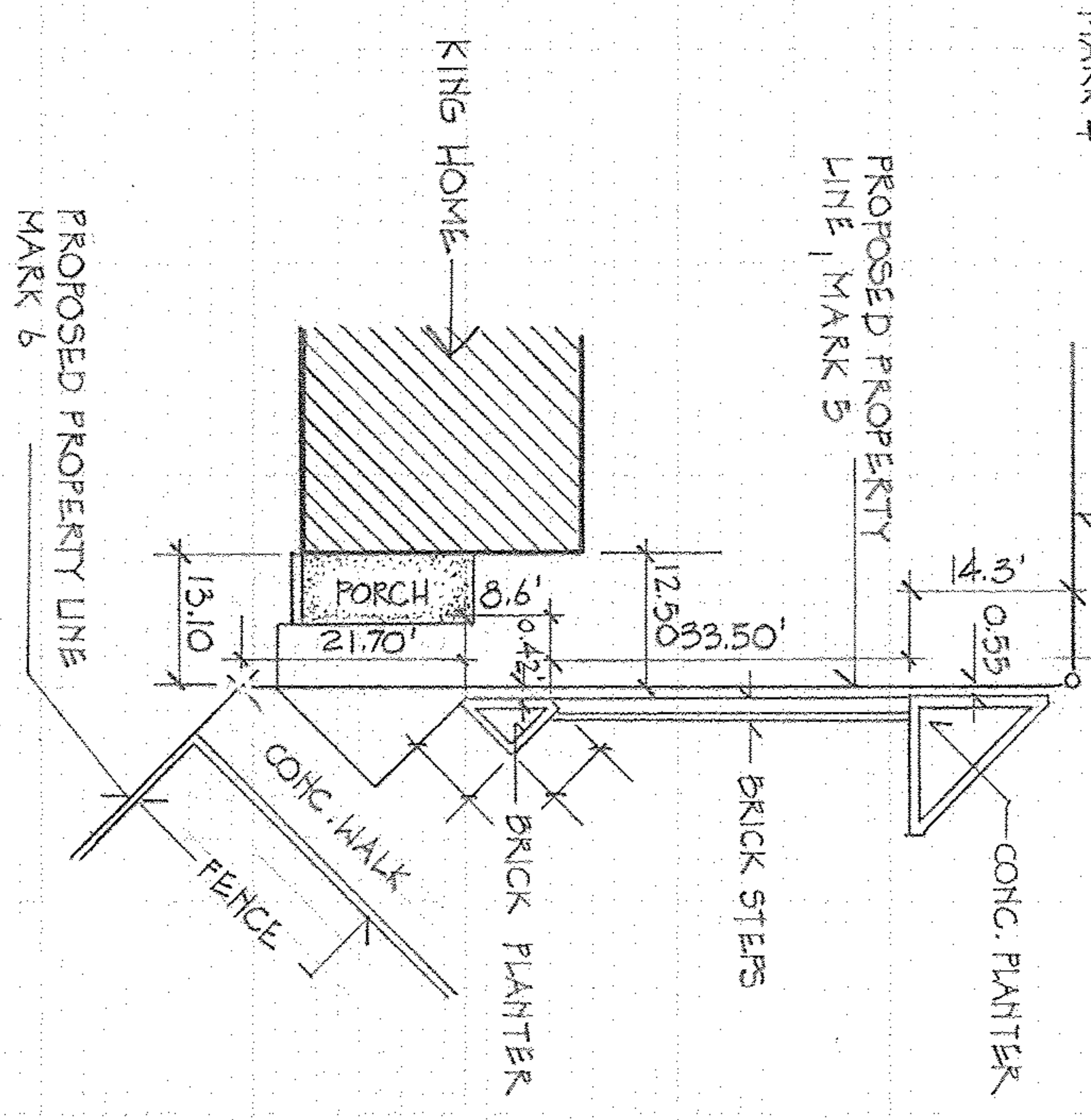

NORD FAMILY FOUNDATION DEED VOL. 123 PG. 576
 PROPOSED LOT SPLIT FROM PPN 09-00-087-104-019

PART OF SUBLLOT NO. 2, KING SUBDIVISION
 OBERLIN, OHIO - O.L. NO. 87 RUSSIA TWP.
 AUGUST 1989

