

LEGEND

- IRON PIN OR PIPE FOUND
- IRON PIN SET
- ⊙ NAIL SET

CERTIFICATION

I CERTIFY THAT INFORMATION SHOWN HEREON IS THE RESULT OF A SURVEY PERFORMED BY ME IN JUNE, 2002, IN ACCORDANCE WITH CHAPTER 4733-37 OAC.

BASIS OF BEARINGS IS RELATED TO THE MONUMENTED CENTERLINE OF N. QUARRY RD. AS REFERRED TO IN O.R.V. 1478, P. 429 (S 11°32'10" W).

Phil A. Rosebeck
 PHIL A. ROSEBECK
 REGISTERED SURVEYOR 6696

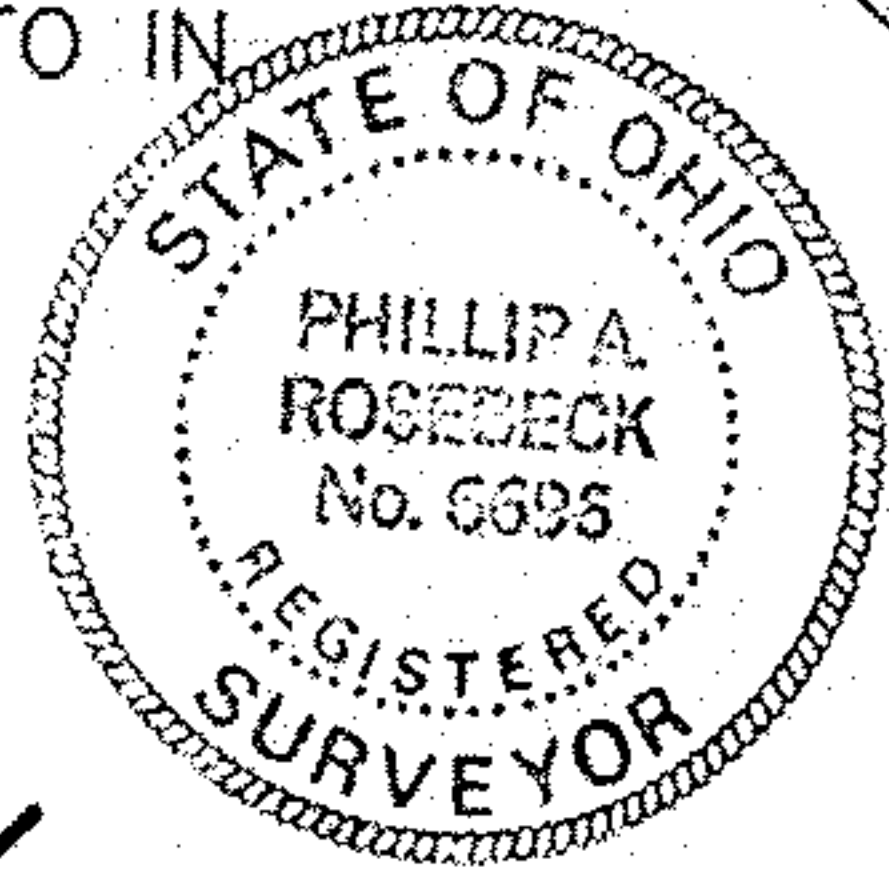

REFERENCES

- SURVEY MAP - LAWRENCE V. MCGLINCHY DATED 3/25/91 FOR JOSEPH & MARJORIE SZABO
- QUIT CLAIM DEED TO MARJORIE SZABO DATED 5/30/96 O.R.V. 1281, P.629
- HIGHWAY EASEMENT TO STATE OF OHIO D.V. 895, P.75
- WARRANTY DEED TO CORINNE M. KOPRIVA DATED 5/30/96 O.R.V. 1478, P.429
- CENTERLINE SURVEY OF N. QUARRY ROAD FOR THE CITY OF AMHERST DATED 7/9/92 BY DAVID BRUNKHORST, P.S. #6314 BRUNKHORST ENGINEERING CONSULTANTS, INC.
- LOR-254-0.00-B R/W PLAN SHEET 14 OF 30

ASSUMED

STATE ROUTE 2

PARCEL 1
 0.4962 ACRES

STATE OF OHIO
 HIGHWAY EASEMENT
 DEED VOL. 895, P. 75

QUARRY ROAD

PPN 05-00-099-000-026
 STATE OF OHIO
 2/1/65

PPN 05-00-099-000-034
 STATE OF OHIO
 11/5/64

PPN 05-00-099-000-049
 CLEVELAND QUARRIES CO. D.V. 812 P. 625

PPN 05-00-099-000-111
 MARJORIE SZABO
 5/30/96
 O.R.V. 1281, P. 629

2.136 ACRES (INCLUDING 0.80 ACRE EASEMENT)
 REMAINDER 1.6398 ACRES (INCLUDING 0.80 ACRE EASEMENT)

PPN 05-00-099-000-110
 CORINNE M. KOPRIVA
 5/6/97
 O.R.V. 1478, P. 429

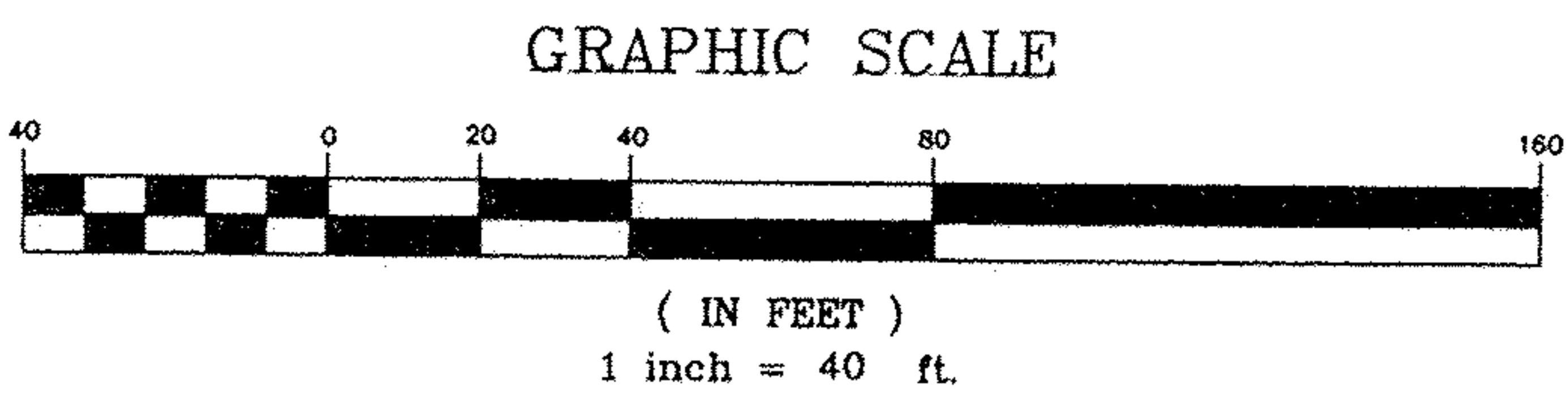

No 01184
 REVIEWED
 8-20-02
 5-00-099-C
 BY JHAT Field
 02-01184

Scan # 47443
 05-00-099-C

SURVEY MAP
JOE SZABO
 PROPOSED LOT SPLIT - QUARRY ROAD
 PART OF ORIGINAL AMHERST TOWNSHIP LOT 99
 CITY OF AMHERST LORAIN COUNTY STATE OF OHIO

P.A. ROSEBECK & ASSOCIATES
 REGISTERED SURVEYOR
 705 WILLOW CREEK DRIVE, AMHERST, OHIO 44001
 PHONE: (440) 988-4657

SHEET
 1
 OF
 1