

01-00-003-101-020;021  
Scan # 47391

PROPOSED SUBMERGED  
LANDS AREA (4451 S.F.)

LAKE ERIE

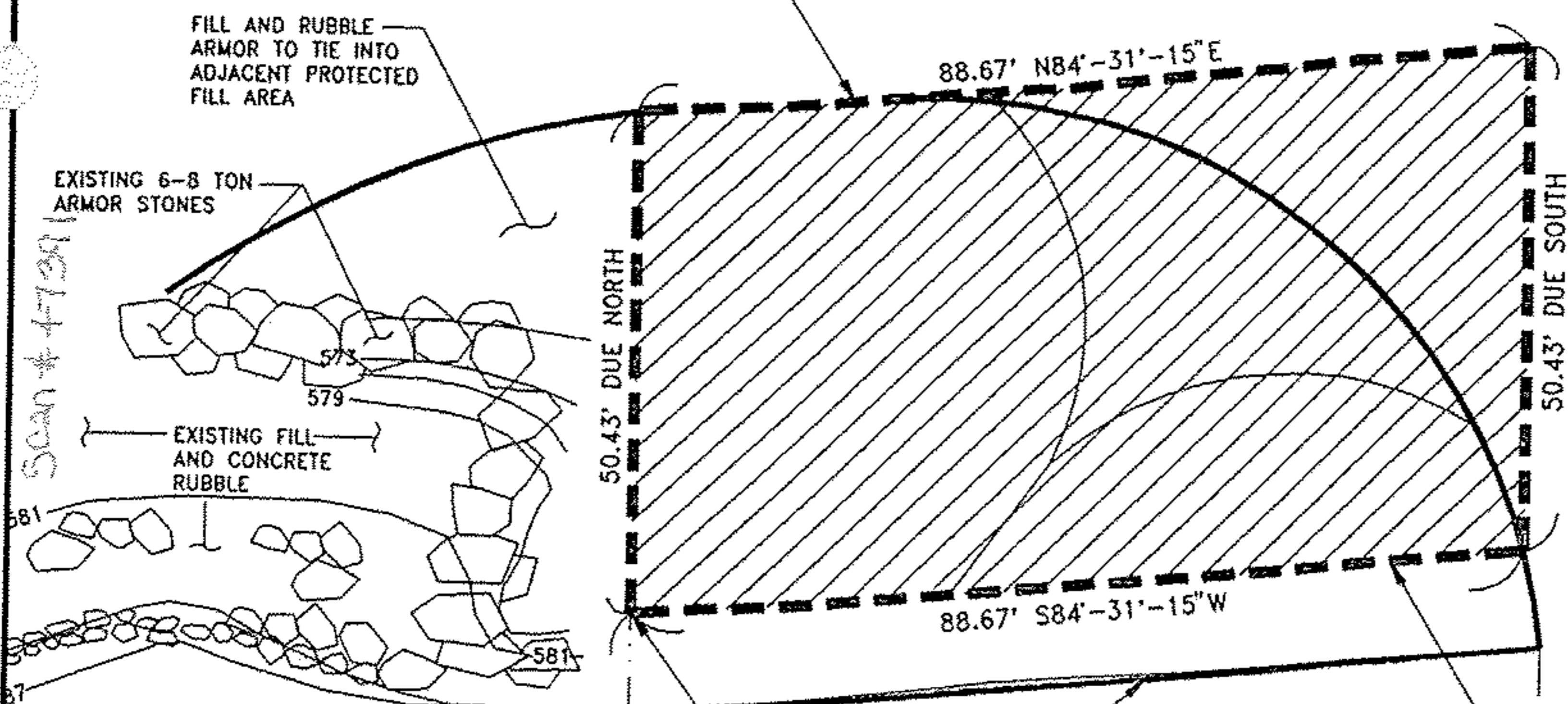
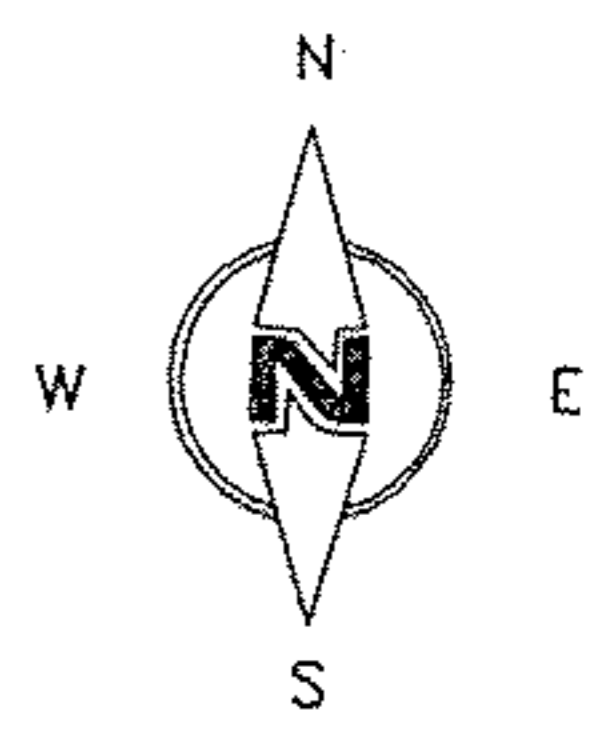

88.67' N84°-31'-15"E

88.67' S84°-31'-15"W

50.43' DUE NORTH

50.43' DUE SOUTH

FILL AND RUBBLE  
ARMOR TO TIE INTO  
ADJACENT PROTECTED  
FILL AREA

EXISTING 6-8 TON  
ARMOR STONES

EXISTING FILL  
AND CONCRETE  
RUBBLE

POB

TOP OF BLUFF

ORDINARY HIGH  
WATER LINE = 573.4'  
IGLD85; SURVEYED  
25 NOV 97

30" TREE

36" TREE

SUBLOTS 63 AND 64

JOAN R. OSTER  
415 ASH STREET  
VERMILION, OH 44089

NANCY DISBROW  
3638 EDGEWATER DRIVE  
VERMILION, OH 44089  
(VOL. 587, PG. 206)

CHRISTINA HOFFMAN KEMP  
3630 EDGEWATER DRIVE  
VERMILION, OH 44089

PROPERTY LINE

PROPERTY LINE

PROPERTY LINE

163.93' DUE NORTH

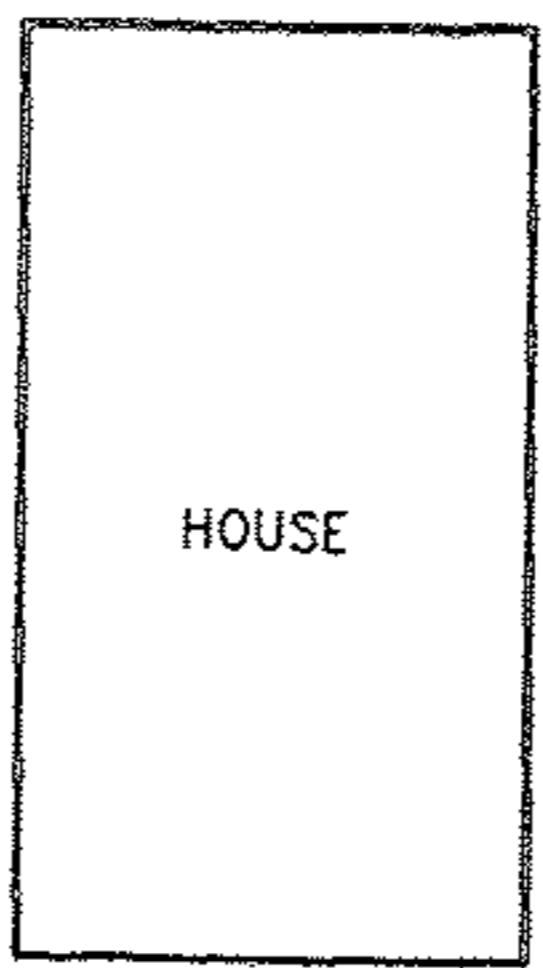

HOUSE

EDGEWATER BLVD. R/W  
90.38' N84°-46'-55"E

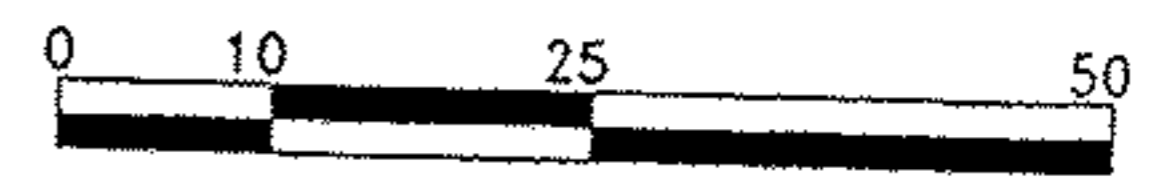

SCALE: 1 in = 25 ft

DATUM: 0.0 L.W.D. = 569.2 FT (IGLD '85)

PREPARED BY:  
**Andrassy Engineering, Inc.**  
ADJACENT PROPERTY OWNERS:  
Joan R. Oster  
415 Ash Street, Vermilion OH 44089  
Christina Hoffman Kemp  
3630 Edgewater Drive, Vermilion OH 44089

SUBMERGED LANDS LEASE  
SITE PLAN  
PROPOSED STONE REVETMENT  
INSTALLATION, HURON, OHIO

APPLICANT:  
Nancy Disbrow  
3638 Edgewater Drive  
Vermilion, OH 44089

SHEET 2 OF 2

12/5/97