

REFERENCES

- DOCUMENT 20100337514
- DOCUMENT 19950.57343
- DOCUMENT 19960436821
- DOCUMENT 19980533059
- DOCUMENT 19950379169
- DOCUMENT 20060163716
- DOCUMENT 20060163717
- DOCUMENT 20050073733
- DOCUMENT 20030931112
- DOCUMENT 20080259703
- DEED VOLUME 1327 PAGE 809
- SURVEY MAP 01-00-077-000-057 A. KOEPP JUNE 5, 1985
- SURVEY MAP 01-00-077-000-056 M.G.HURA SEPT. 23, 1987
- LORAIN COUNTY INTERNET MAPS
- LORAIN COUNTY TAX MAPS (1961)

APPROVED
 DEED 4-13-12
 BY R. MAINES
 #12-03012

01-00-077-000-061
 -062

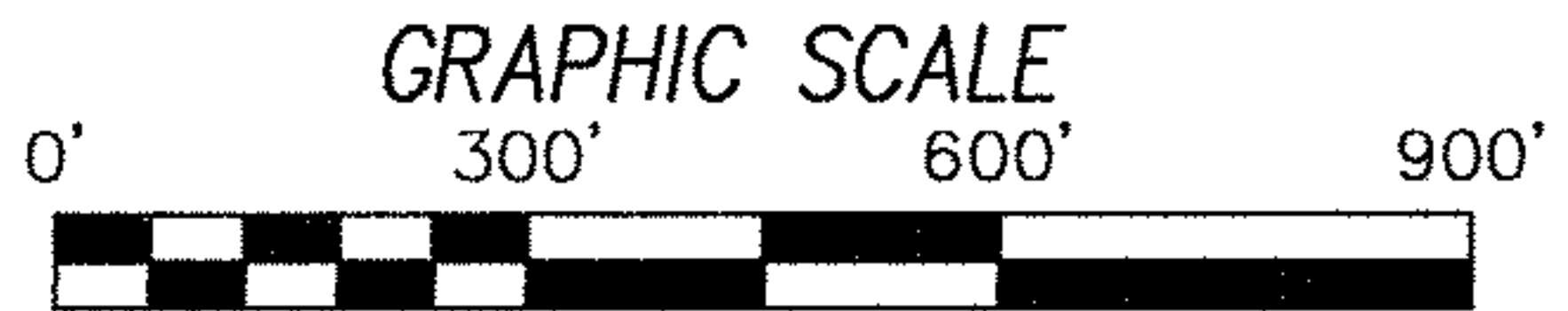

SCALE: 1" = 300'

MINOR LOT SPLIT
 CHRISTOPHER & SARA LUKE
 PART OF ORIGINAL LOT 77, BROWNHELM
 TOWNSHIP, LORAIN COUNTY, OHIO
 PPN 01-00-077-000-057
 SCALE 1"=300' 09/23/11
 P.A.ROSEBECK & ASSOCIATES - REG. SURVEYOR
 705 WILLOW CREEK DR., AMHERST, OH 44001

PHIL A. ROSEBECK
 PHIL A. ROSEBECK

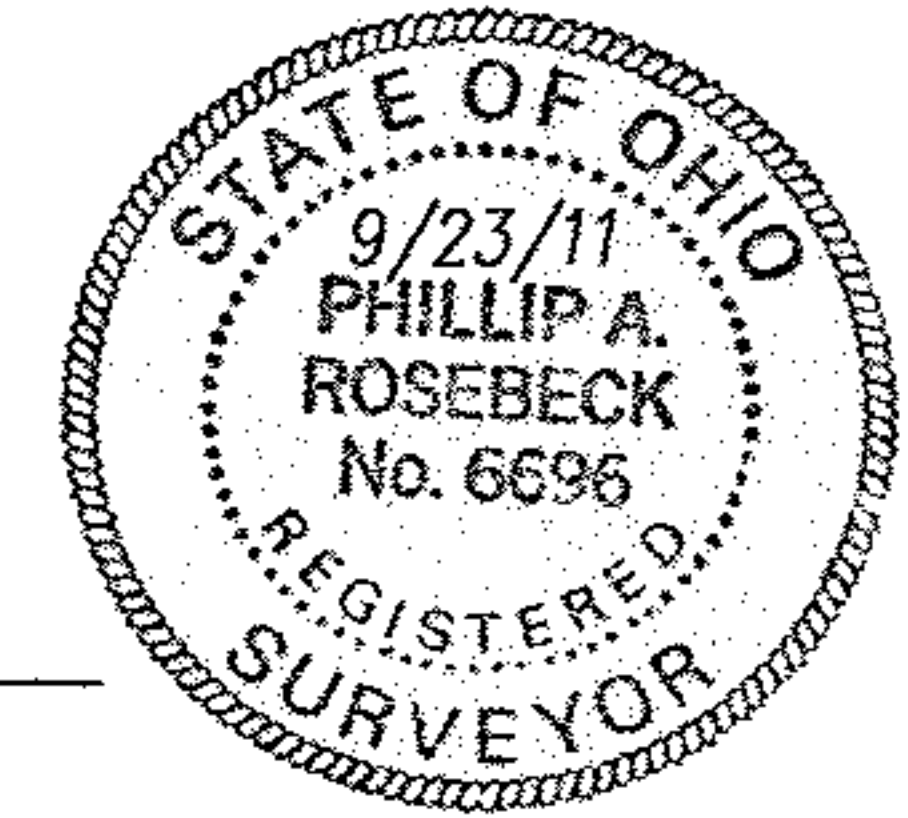

01-00-077-000-061
 Scan #47067
 062