

ELYRIA TOWNSHIP
CARLISLE TOWNSHIP

P.P. NO. 99

HIGHLAND DEVELOPMENT CORP.
D.V. 1285 P.479

PAGE 99A9

190.00'
S-89°43'27"-E

678.50' R.
677.32' CALC.

ROY 487.32'

AC. CORK, #20624

NORTH PARK REALTY
DEV. INC.
O.R.V. 540 P.627

(1.6729 AC. REM.)

0.6541 AC.

-293

-294

190.00'
N-89°43'27"-W

673.44' R.
672.18' M.

482.18'

EDWARD E. & CECELIA
KINTER
D.V. 795 P.221

149.96'
O.R.V. 340 P.213

S-0°47'37"-W
BARBARA BACSI



SCALE: 1" = 40'

20624

APPROVED
LORAIN CO.
MAP DEPT.

DATE 12-10-93

PAGE 10-00-005

BY CAROLYN
FRANCIS

VOID
AFTER # 20624

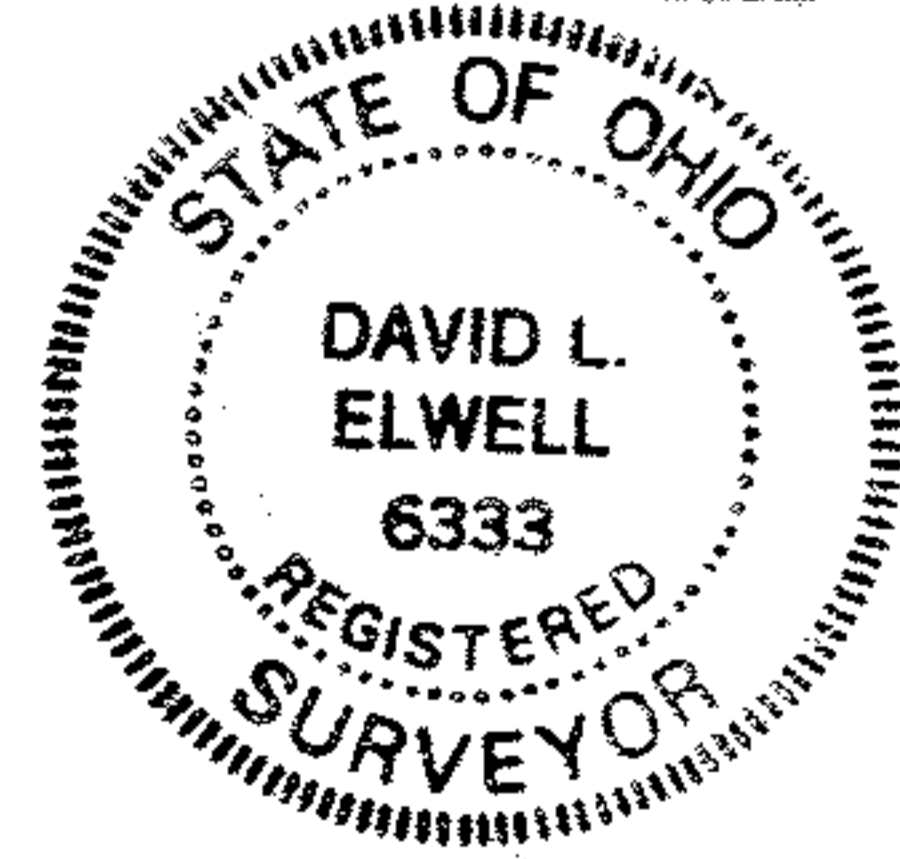

David L. Elwell
REG. SURV. NO. 6333
12-7-92

SURVEY MAP

PART OF CARLISLE TOWNSHIP SECTION NO. 5
CITY OF ELYRIA TOWNSHIP OF CARLISLE
COUNTY OF LORAIN STATE OF OHIO

KS ASSOCIATES INC.
ENGINEERS SURVEYORS

92-425

948.60'

150.00' & S-1°10'-E

ABBE ROAD

R/W
CORP. LINE

290'

CORP.
LINE
MON
Fd.

CARLISLE TWP.
ELYRIA CITY