

10-00-004-112-0337035
10-00-004-6

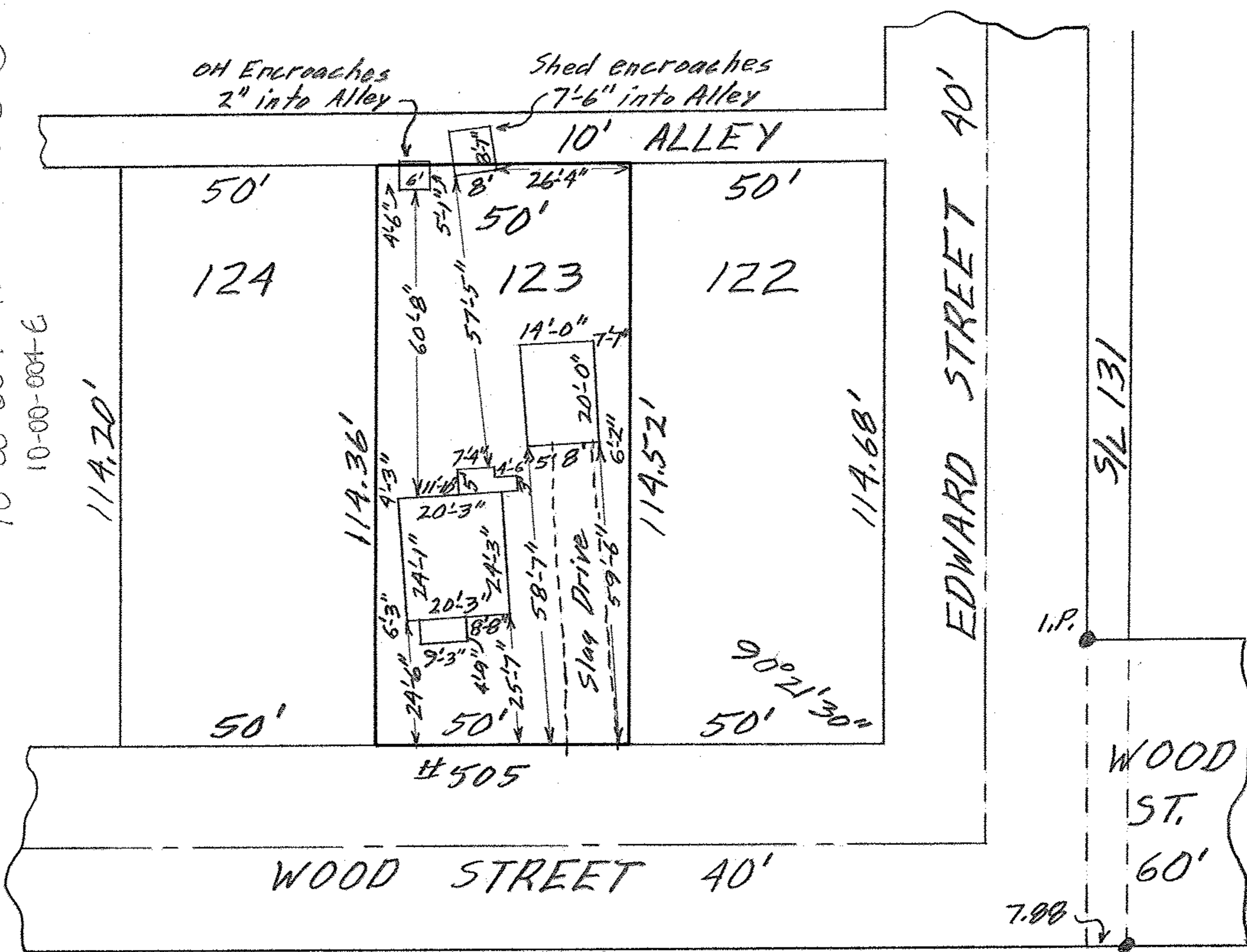

MAP OF SUB-LDT NO. 123
 LINDALE ALL'T. VOL. 6 Pg. 42
 SECTION NO. 4 CARLISLE TWP.
 ELYRIA CITY - LORAIN CO. - OHIO
 SCALE: 1" = 30' NOV. 5 - 1965 11:00 A.M.
 Gary E. Penfound REG. SURVEYOR

BERRS TITLE INS. CO.
 Order No. 1607

NOW -
 S/L 81 → 83
 per Vol. 32 pg 52

