

06-25-022-108-001,002

W-89
Scan# 45922

BON AIR AVENUE
N. 3°06'30"E.

50'

POPLAR STREET 60'
N. 86°53'30"W.

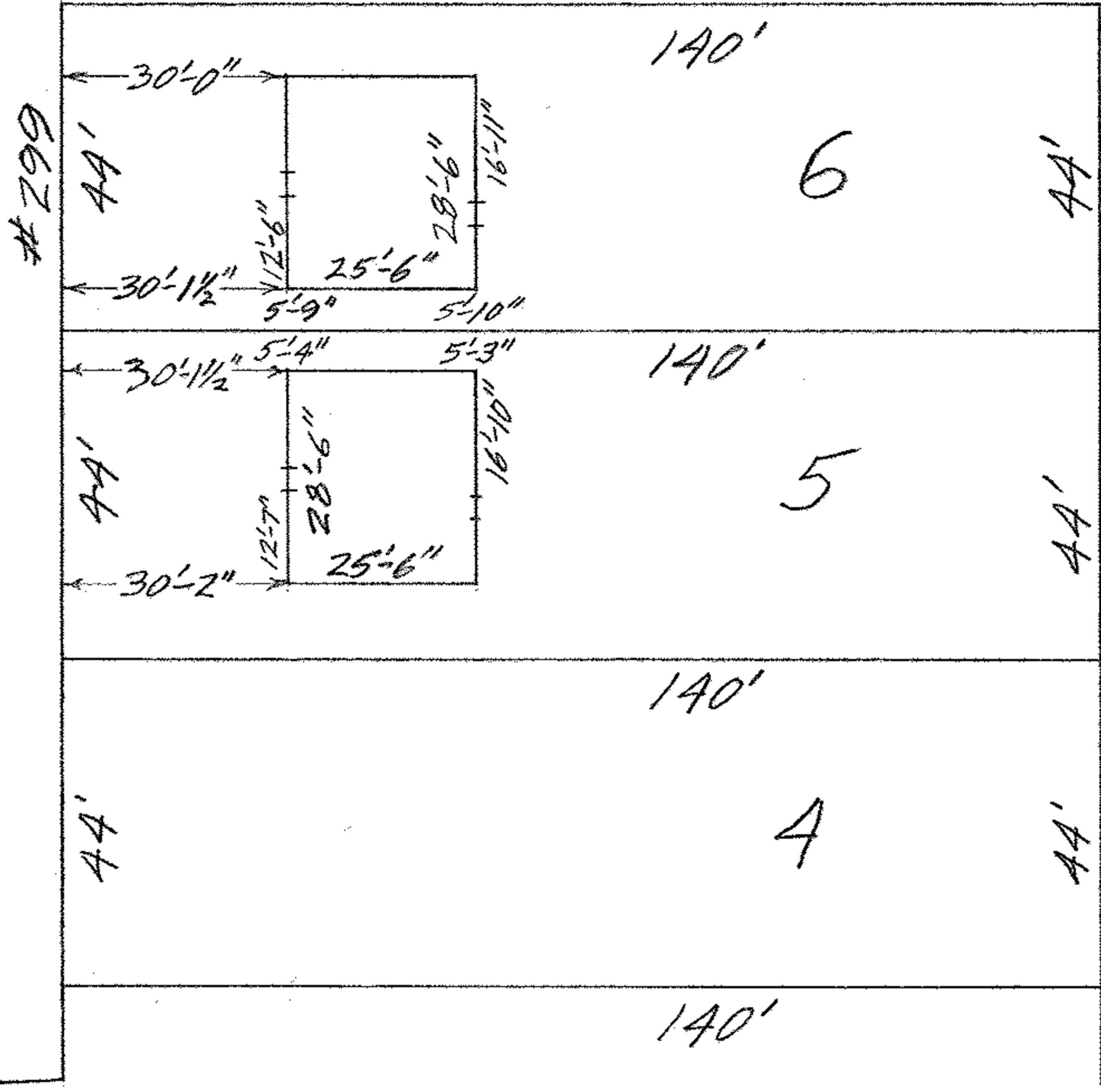

MAP OF SUB-LOT 6 BLOCK 35
 CITY FARMS ALL'T. VOL. 9 Pg. 3 PLATS
 ELYRIA TWP. ELYRIA CITY
 LORAIN COUNTY OHIO
 SCALE: 1" = 30' MARCH 7-1962 11:45 A.M.
 Gary E. Perfound REG. SURVEYOR

Peter E. & Antoinette M. Longbrake