

03-00-046-108-008
03-00-046-B

Scan # 45260

NEW YORK - CHICAGO
AND ST. LOUIS RAILROAD

145.20'

Chd. 51.85'
 $\Delta = 1^{\circ}02'57''$

Chd. 51.59'
 $\Delta = 1^{\circ}02'38''$

Triangular Section of
Asphalt Drive Encroaches
onto Sub-lot 8 144.44'

8

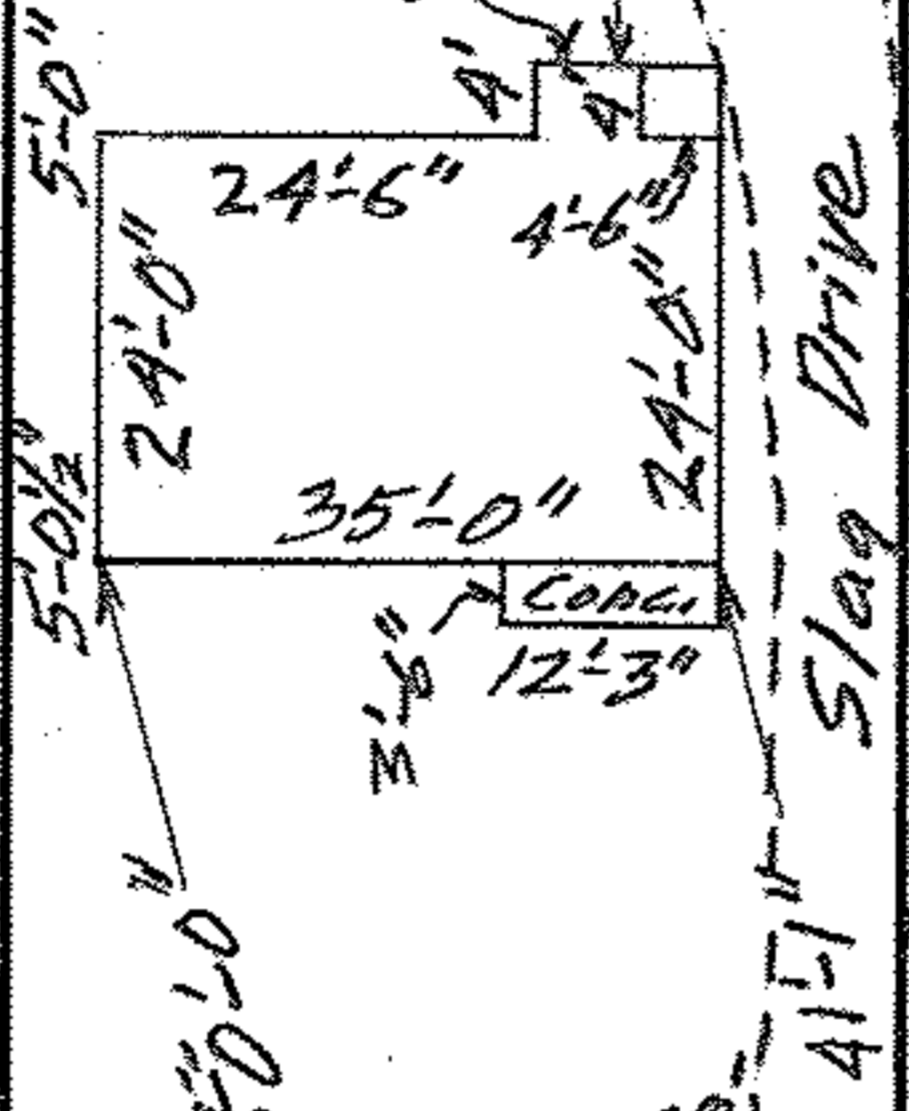

Chd. = 52.05'
 $\Delta = 1^{\circ}06'29''$

Chd. = 51.78'
 $\Delta = 1^{\circ}06'07''$

R = 2692.26'

#3227
Arc = 733.43'
Chd = 731.11 Meas.
to I.P. at P.C.

R = 2652.26'
"G"

STREET 80'

BLOSSOM
DRIVE 60'
(Fmly. CAROLINA
DRIVE)

I.P.



MAP OF SUB-LOT NO. 8
PEASEDALE ALLT. VOL. 15 Pg. 69
ORIG. LOT 46 SHEFFIELD TWP.
LORAIN CITY - LORAIN COUNTY - OHIO
SCALE: 1" = 30' NOV. 20-1965 11:45 A.M.
Gary E. Penfound REG. SURVEYOR

Dorothy Hobar

BH

03-00-046