

SITE & TOPO SURVEY OF OBERLIN MEDICAL ARTS INC.  
CITY OF OBERLIN; LORAIN COUNTY; OHIO  
SCALE 1" = 20'  
MAY 17, 1963  
LAUNDON & HUFFMAN ENGINEERS

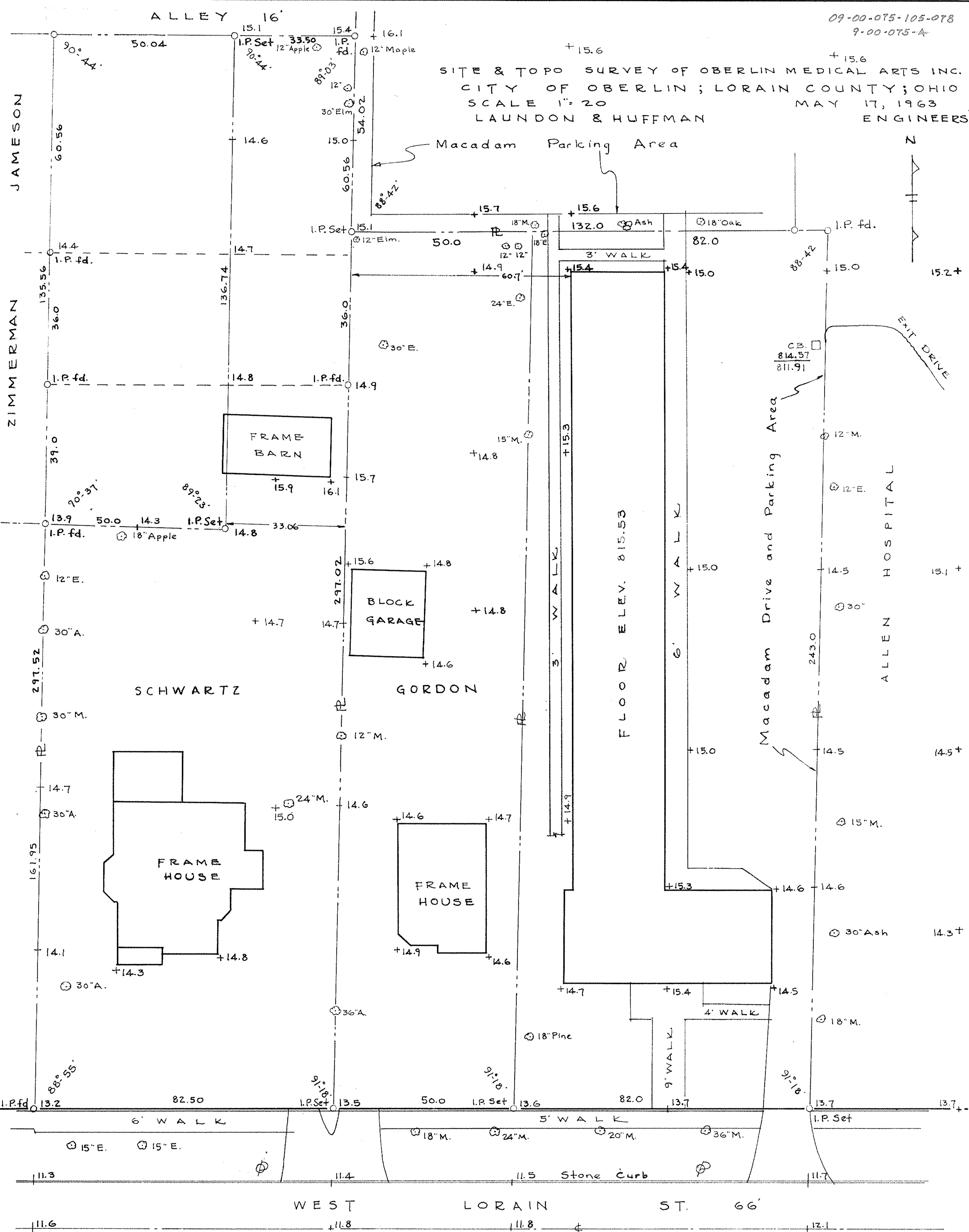

ADD 800' TO ELEV. SHOWN FOR U.S.G.S. DATUM

172