

PPN 09-00-077-01-047

MFP PG 9-00-077-B



NLY. LN. of LANDS CONVEYED TO THE CITY OF OBERLIN BY D.V. 1139 P. 193

S. 89° 27' 30" E. 795.29'

I.P. Fd.

I.P. Fd.

ARTINO ST. 60'

N. 0° 37' 30" E. 600.00'

100'

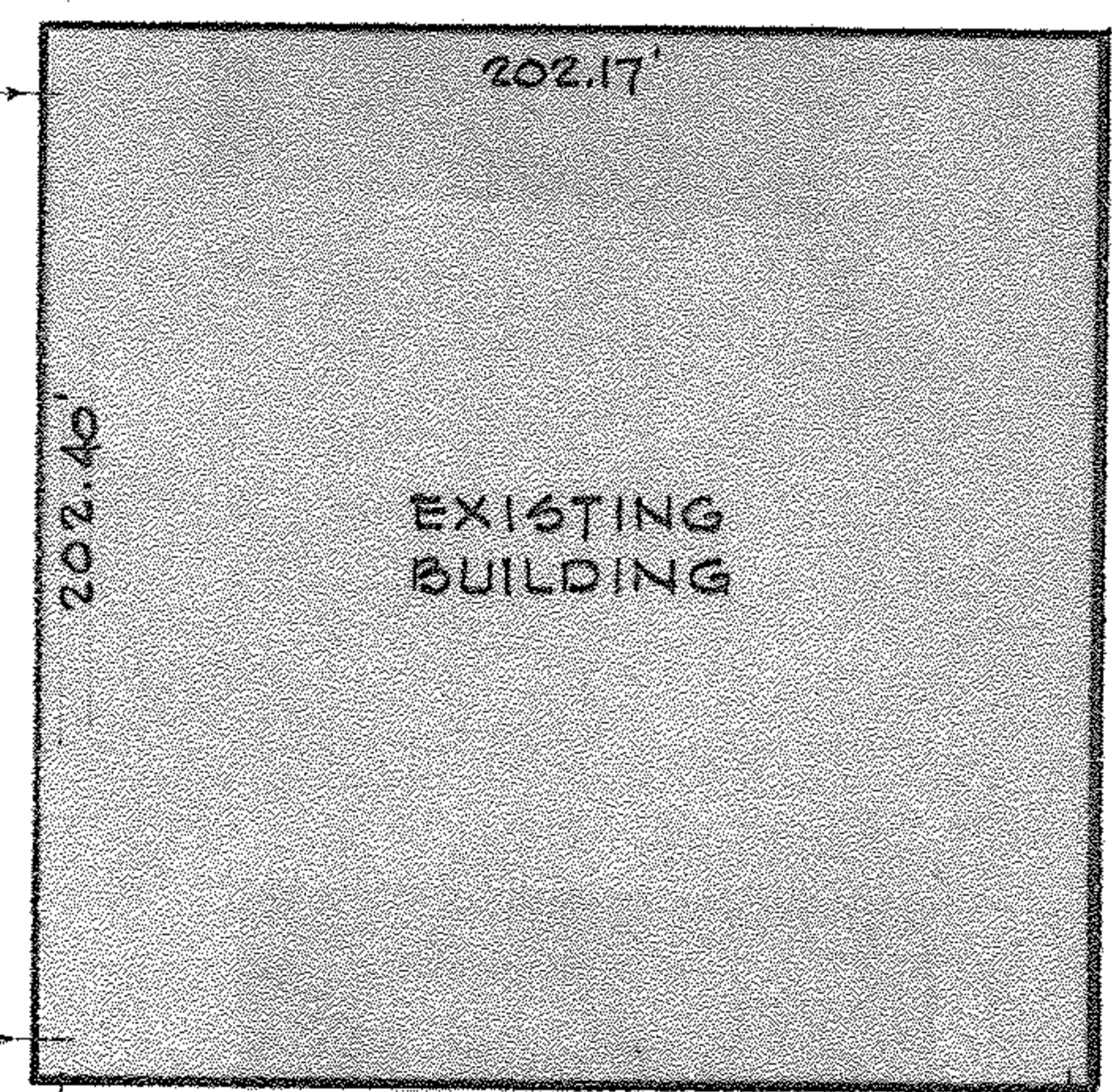

EXISTING BUILDING

10.9001 ACRES

S. 1° 22' 30" W. 600.06'

JOHN N. STERN

11-13-72 V. 1063 P. 791

100'

24.80'

24.51'

N. 89° 27' 30" W. 787.45'

I.P. Re-set

1140.00' Rec. & Meas. @ EAST LORAIN ST.

I.P. Set

SURVEY FOR

O.B.Y. & ASSOC. LTD.  
V. 1185 P. 361

# JENNINGS & CHURELLA INC.

PART OF O.L. 77 RUSSIA TOWNSHIP  
COUNTY OF LORAIN  
SCALE 1" = 60'  
LAUNDON • SIMON • CAHL & ASSOC.

CITY OF OBERLIN  
STATE OF OHIO  
JUNE 17, 1981  
ENGINEERS & SURVEYORS

REVISED 7-10-81 PROP OWNERS  
REVISED 6-22-81 BLDG. LOC.

JOB NO. 81-1060