

PERPETUAL EASEMENT FOR
INGRESS AND EGRESS (DRIVE)
D.V. 595 PG 158

CHAS. J. & ADOLL E. HOYT.
8-1-53 D.V. 577 PG. 346

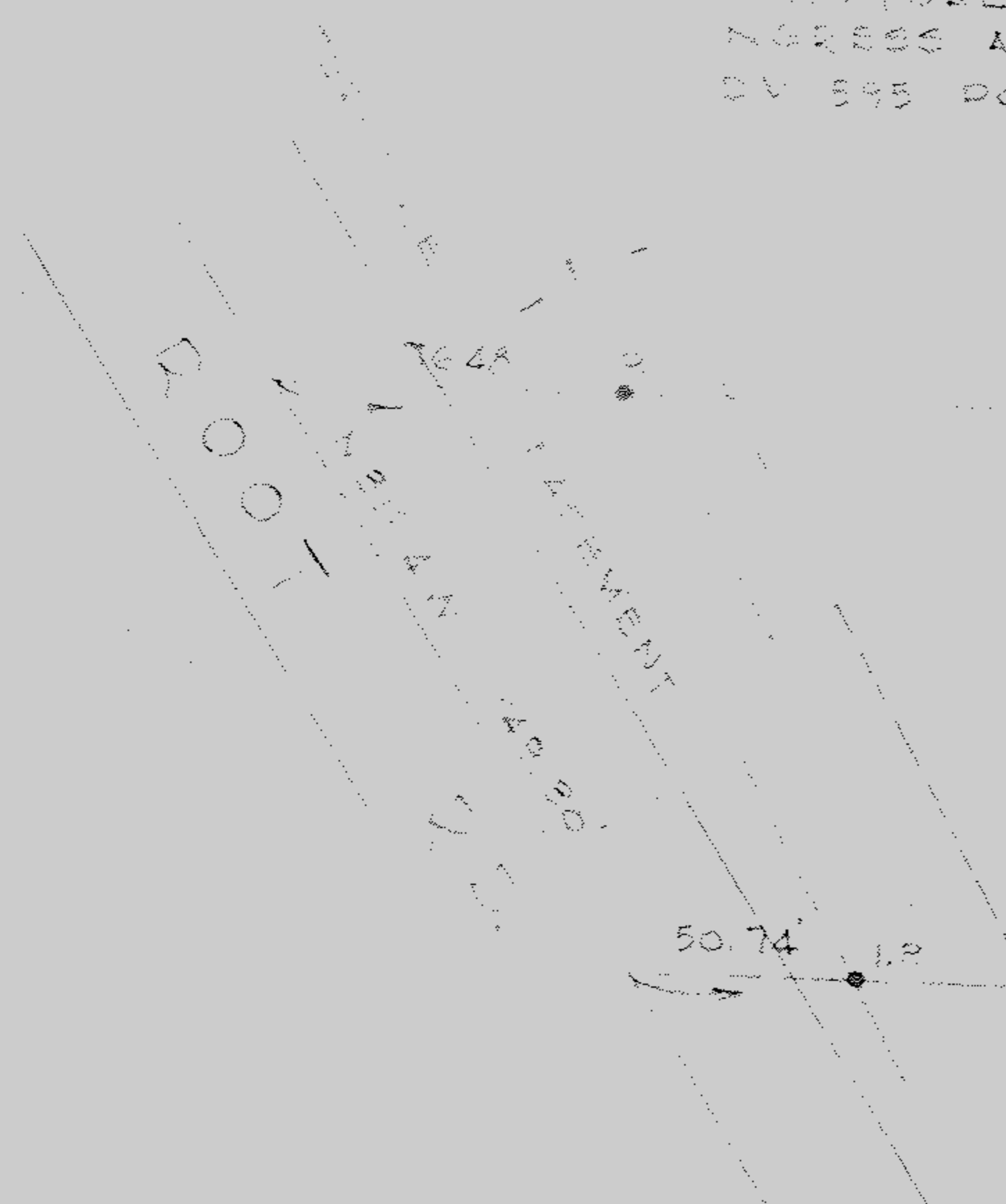

223.57' 223.57' 544.12' I.P. 205
S. 88° 06' E.

1.5004 Ac. to Φ Root Rd.

DITCH.
S. 15° 14' E. 130.85'

50.74' 218.20' 218.20' 501.14' I.P. 14'
N. 88° 06' W.

RUBY G. DRAUDT
D.V. 726 PG. 341



SURVEY FOR DELBERT R & RUBY A. MEADOR

O.L. 15 RIDGEVILLE TOWNSHIP
CITY OF N. RIDGEVILLE - LORAIN CO. - OHIO
SCALE 1"=60' NOV. 2, 1973
LAUNDON • SIMON • CAHL & ASSOC.
ENGINEERS & SURVEYORS

Job No. 73-189