

TOTAL AREA = 1.06572 Ac
 TAKING AREA = 0.43906 Ac
 REMAINING AREA = 0.62666 Ac

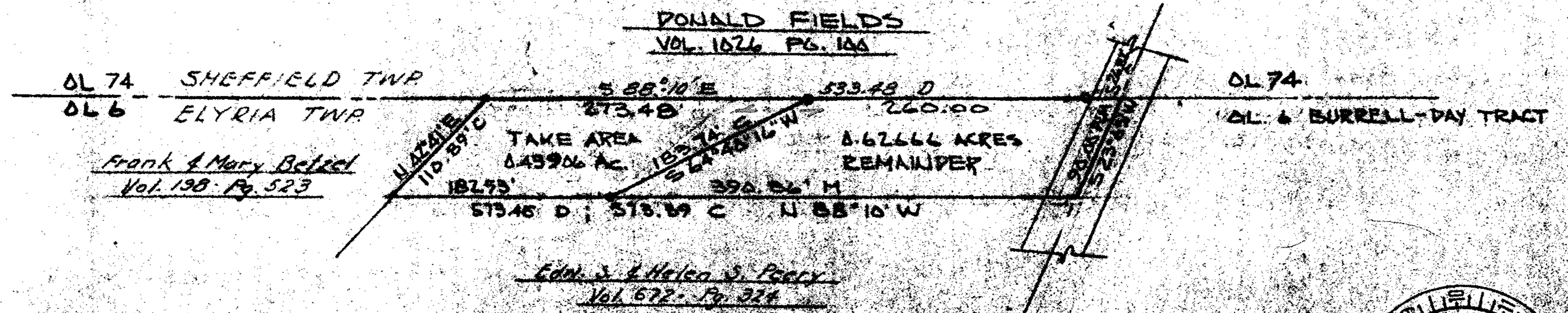

- LEGEND**
- M = MEASURED
 - A = ACTUAL
 - D = DEED
 - C = CALCULATED
 - = IRON PIN FOUND
 - • " " SET



PPN 06-22-006-101-???

MAP pg 6-13 43750

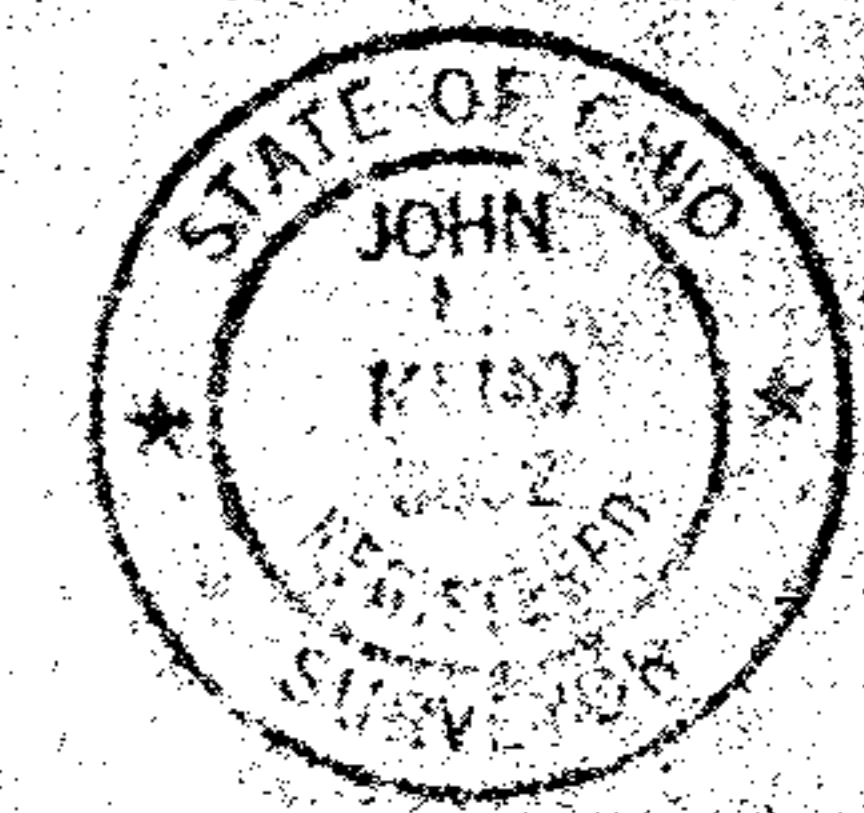

REVISED 2-13-73 PER LCMP

LORAIN COUNTY METROPOLITAN PARKS
 LAND ACQUISITION SURVEY
 DONALD GERHART PROPERTY
 5627 FORD ROAD
 ELYRIA, OHIO

SCHAFFER, HURA & ASSOCIATES, INC.
 ENGINEERS AND SURVEYORS
 4370 OBERLIN AVE.
 LORAIN, OHIO

PROJECT	BURRELL-DAY TRACT	DATE	10-31-72
TOWNSHIP	ELYRIA	SCALE	1" = 100'
CITY	ELYRIA	FIELD BOOK	219 PG. 42-47A
COUNTY	LORAIN	DRAWN BY	W/H
STATE	OHIO	CHECKED BY	JRM
FILE NO.	1685-3	FILE NO.	6-00-6 BURRELL-DAY