

3-00-077-C

03-00-077-115

PPN 03-00-077-115-???

TOTAL AREA -	1.34724 Ac
TAKE AREA -	1.34724 Ac
REMAINING AREA -	0.0000 Ac

Map pg 3-00-077-C
43367

J. DELIMAN PROP

N 25° 03' 08" W

S 2° 18' 33" E WEST RIVER ROAD (VACATED)

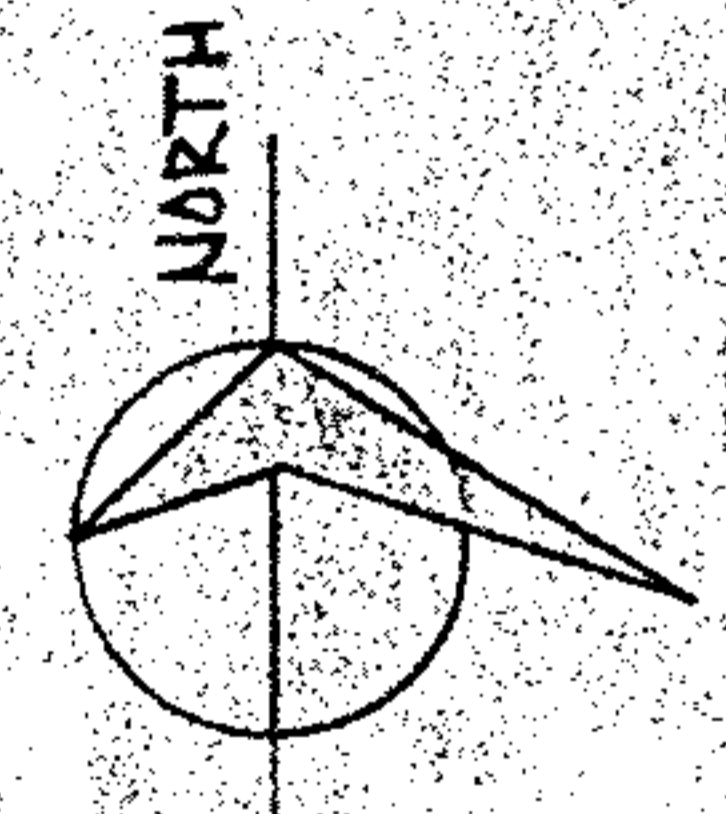

273.02 Obs.

N 62° 31' 06" E
58.29 R 40

N 85° 43' 33" E
625.88 R 626.12 Obs.

03-00-077-115-020
849.36 C OL 77

N 86° 21' 21" E
173.19 O 270.00 D

1.34724 ACRES

240.00 USED RR REC.

167.78 C
S 58° 59' 36" E

S 89° 46' 27" W
1362.38

LORAIN & WEST VIRGINIA RAILROAD CO.

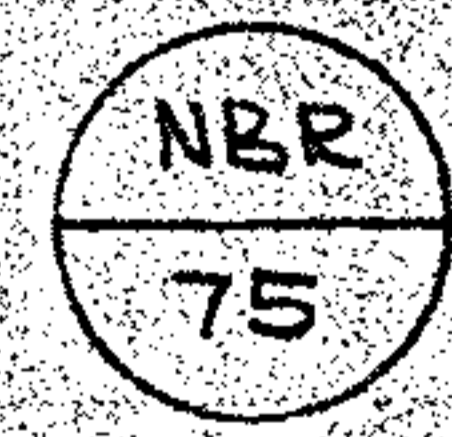
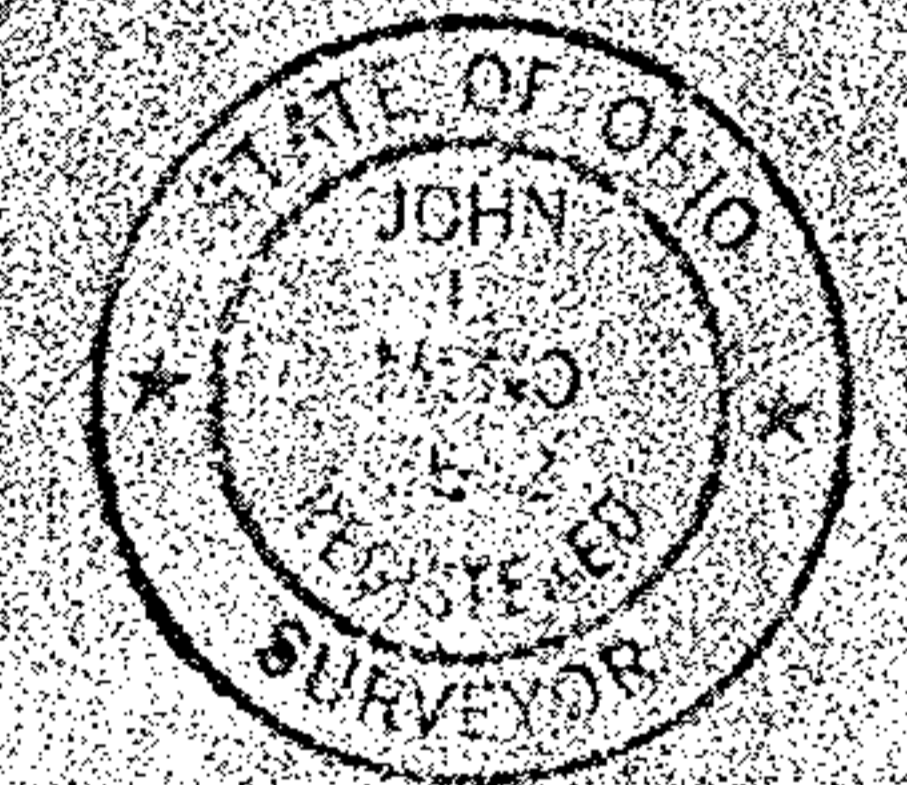

LEGEND

- O - OBSERVED
- R - RECORD
- M - MEASURED
- C - CALCULATED
- - IRON PIN SET
- - IRON PIN FOUND
- - STONE FOUND

LORAIN COUNTY METROPOLITAN PARKS
CLEVELAND ILLUMINATING CO.
WEST RIVER ROAD
ELYRIA, OHIO
LAND ACQUISITION SURVEY

SCHAFFER, HURA & ASSOCIATES, INC.
ENGINEERS AND SURVEYORS
4370 OBERLIN AVE.
LORAIN, OHIO

ORIGINAL LOT	77	DATE	10-17-72
TOWNSHIP	SHEFFIELD	SCALE	1" = 100'
CITY OF		FIELD BOOK	219 PG
COUNTY OF	LORAIN	DRAWN BY	JFE
STATE OF	OHIO	CHECKED BY	J.L.M.
W. O.	1685-9	FILE NO.	3-00-77