

19/10/91

JOHN F. & PATRICIA L. GILLES
V. 1387 P. 588
-069

RANDALL B. & GARY C. FRATIENNE
V. 1236 P. 267
-041

RANDALL B. & GARY C. FRATIENNE
V. 1236 P. 267

PARCEL N:1
1.7186 AC. ±

PARCEL N:2
1.7519 AC. ±

R. & J. INVESTMENT CO.
V. 915 P. 295

JOHN A. EVANS
O.R.V. III P. 317

DONALD T. & MARY C. LAW
V. 1024 P. 376
-035

DAVID R. & SHEILA D. DZURIK
O.R.V. 329 P. 744
-002

SHEFFIELD FRENCH CREEK RD. 60'

PROPOSED 20' R/W LINE

0.1413 AC.
0.1448 AC.

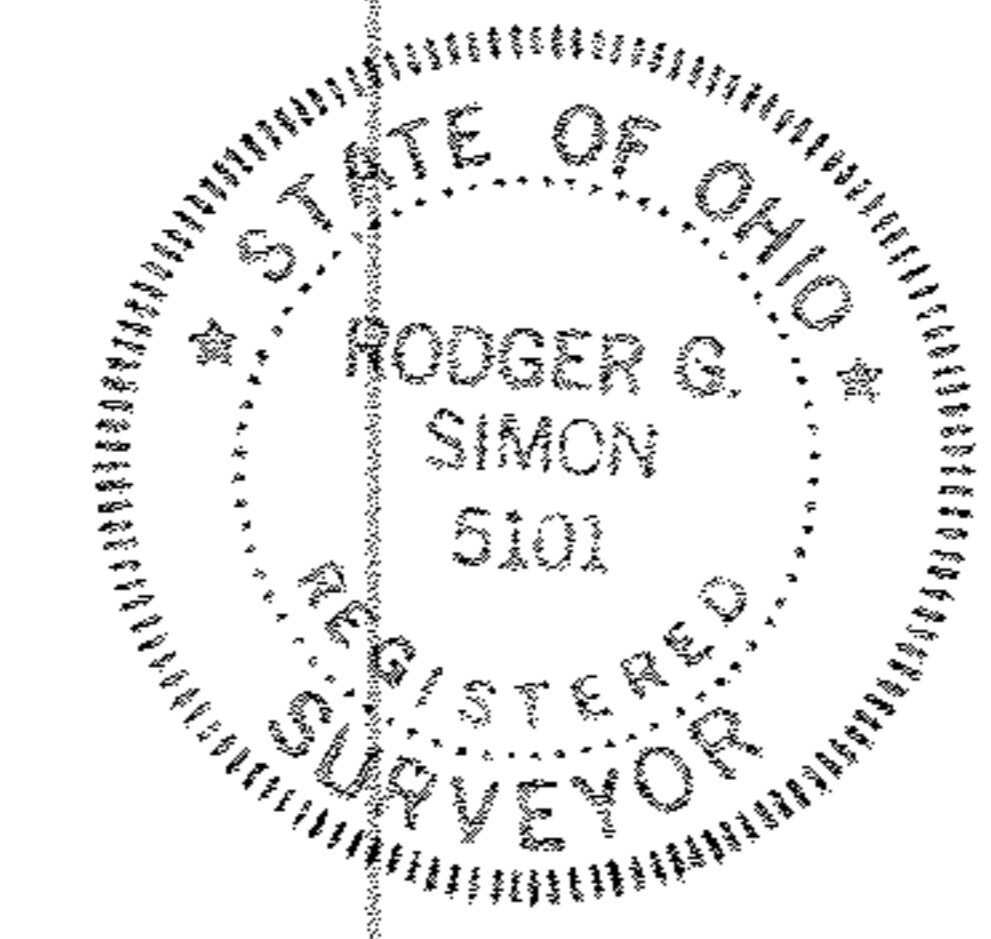

SURVEY FOR
MARK MYLECHRAINE - ELEANOR MYLECHRAINE
and VIRGINIA C. WILLIAMS

PART of ORIG. SEC. 10 TOWNSHIP of AVON
CITY of AVON - COUNTY of LORAIN - STATE of OHIO
SCALE 1"=50 MARCH 1991
LAUNDON • SIMON • CAHL & ASSOC.
ENGINEERS SURVEYORS
Job No: 91-2011

