

10130

09-00-077-102-012
09-00-077-B 013

SURVEY FOR
NACSCORP INC.

PART OF O.L. 77 RUSSIA TOWNSHIP
CITY OF OBERLIN COUNTY OF LORAIN STATE OF OHIO
MARCH, 1990 SCALE 1"=60'
LAUNDON · SIMON · CAHL & ASSOC.
ENGINEERS SURVEYORS
106 MIDDLE AVE. ELYRIA, O. 44035
(216) 322-7625

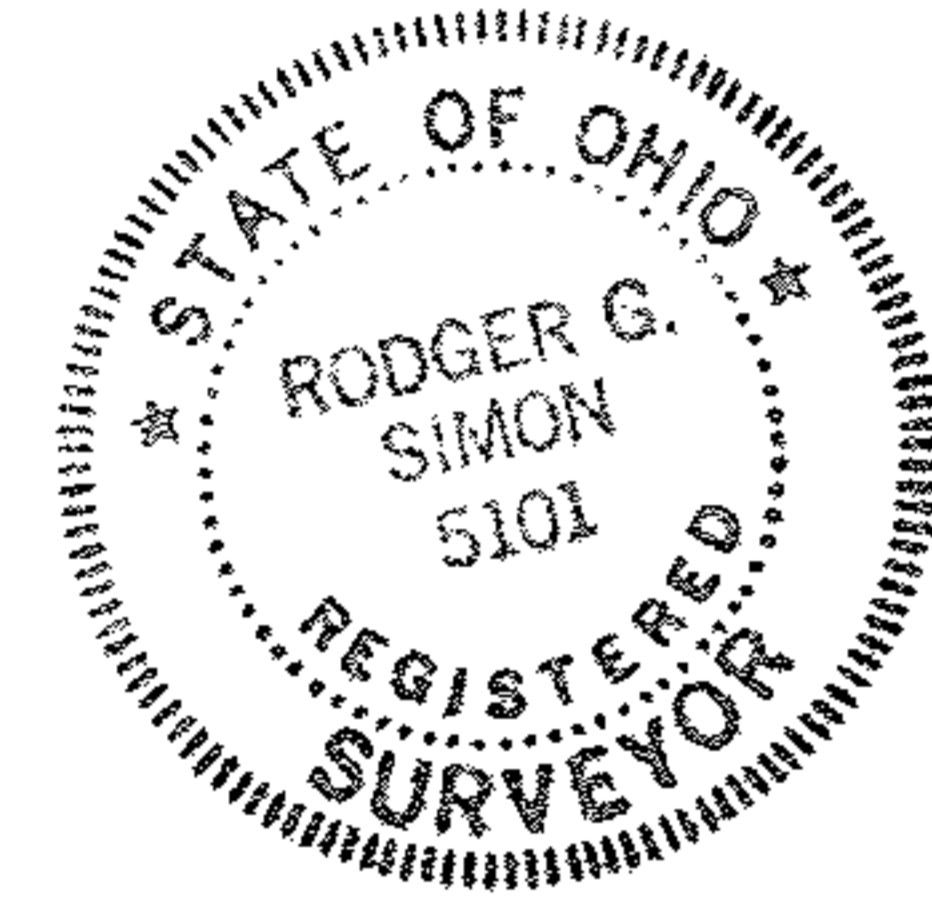

Rodger Simon

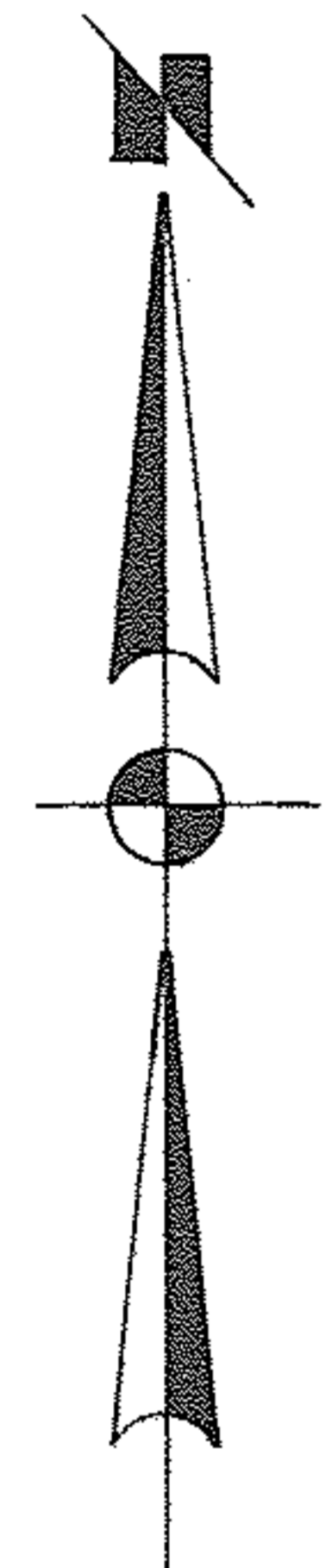

CITY OF OBERLIN
V. 1198 P. 579
(FORMERLY PENN CENTRAL RR.)
N. 37° 24' 32" E. 871.89' ±

PCL. No 2
4.5713 Ac.

RONALD GORDON &
ANDREW BALUNEK
V. 1164 P. 874

RONALD & BEVERLY BARKACS
V. 986 P. 915-917

R.R. TIE POST 150 REC. I.P. SET 5.89° 23' 47" E. 540.10' I.P. SET 30'

51.35' I.P. SET 438.75' E

N. 1° 24' 08" E.
443.54'

N. 45° 24' 07" E.
97.81'

PCL. No 1
8.1553 Ac.

6.1° 24' 08" W. 695.51'

OBERLIN ROAD 60'

I.P. SET 37.55'

494.37'

N. 89° 31' 10" W.

1052.48'

558.11'

I.P. IN M.D. Fd. & Used

EAST LORAIN STREET 60'



90-1926

222