

SUGAR RIDGE RD 60'

BOUNDARY SURVEY & LOT SPLIT

For

HAROLD ZICKEFOOSE

Of

Part of Original Ridgeville Township Lot No. 35
City of North Ridgeville County of Lorain

State of Ohio

LAUNDON · SIMON · CAHL & ASSOCIATES
PROFESSIONAL LAND SURVEYORS

110 MIDDLE AVE.
ELYRIA OHIO
216-322-7625

SCALE: 1"=40'
JAN. 1996
FB. 238 P. 19

Charles E. & Ruth A. Fike
DV 1224 P. 185

Parcel 1
1.1678 Ac. Total

SHADY

LANE

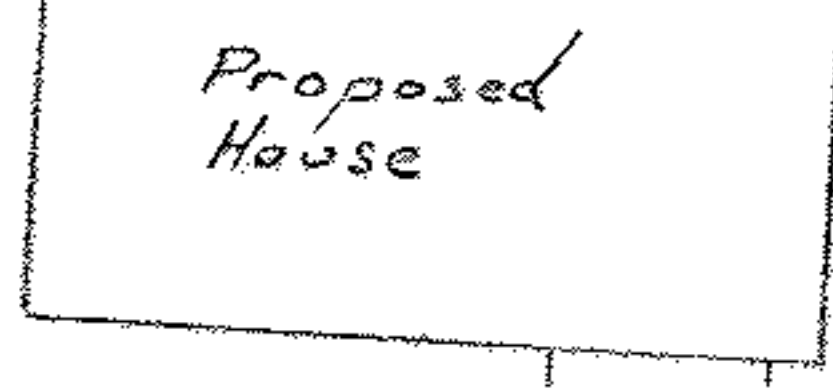
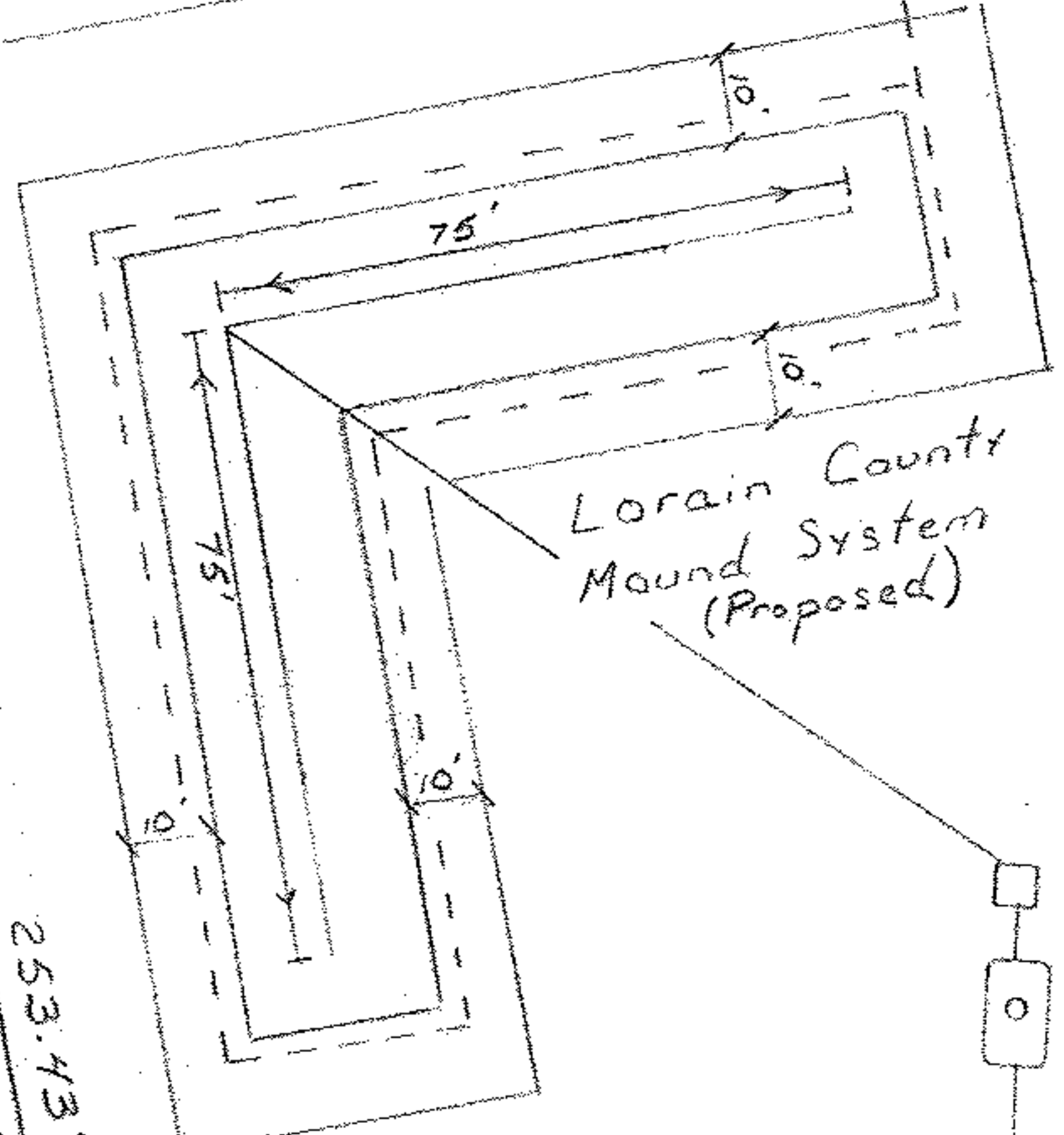

Parcel 2
1.2428 Ac.

SHADY LANE

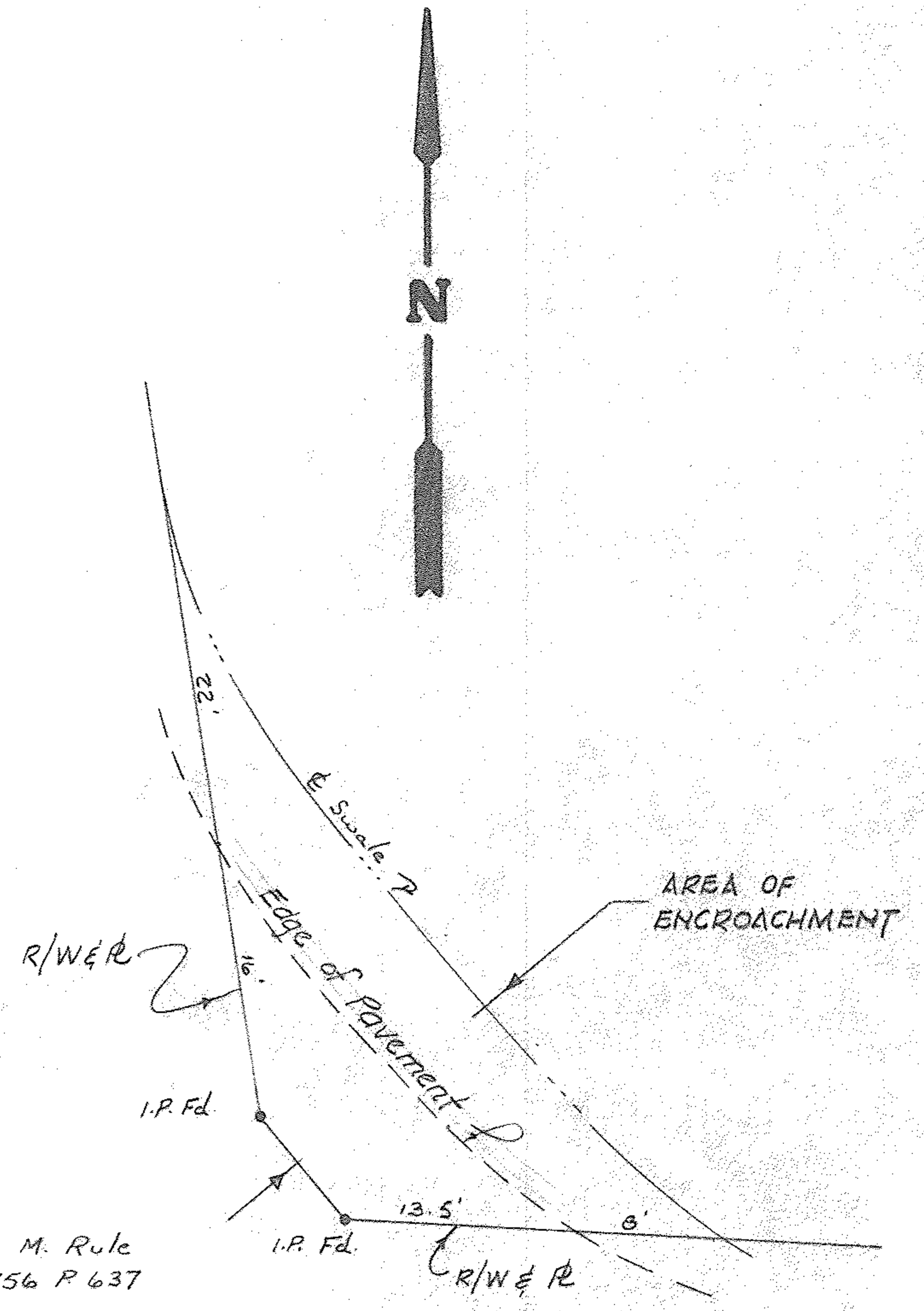

Detail
Pavement & Swale Location At
Southwest Corner
Scale: 1"=10'



ZICKEFOOSE

95-2814

312