

ERIE COUNTY
LORAIN COUNTY

01-20-026-000-012

Eloyne G Trinter, Trustee
Volume 1284, Page 283

Proposed Parcel Split
1.110 Acres
out of 01-20-026-000-012

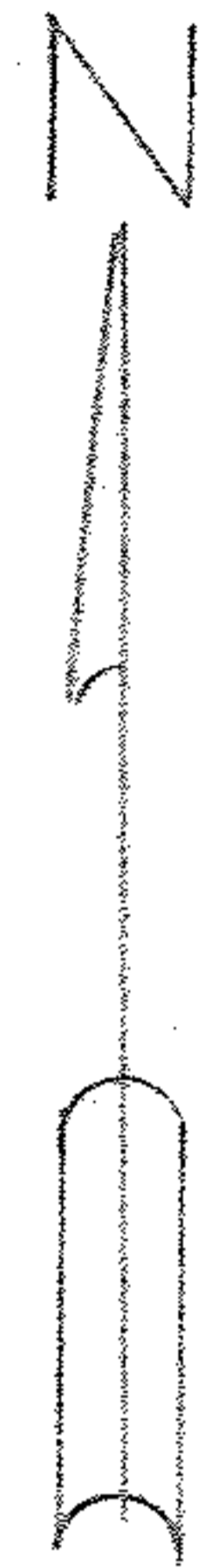

R.R.S.
Fd. & Used

60' RW

E TRINTER ROAD
444.01' Obs.

N 76° 47' 30" W

I.P. Set

S 76° 47' 30" E
160.00'

I.P. Set

N 1° 38' W 312.69'

S 1° 38' E 312.69'

East Line Gore Strip 0.L. 26

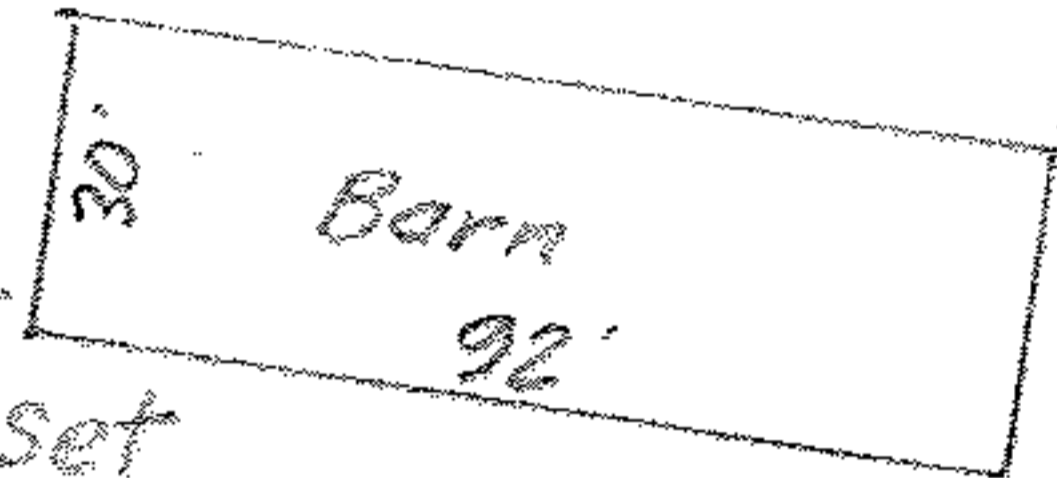

22' I.P. Set

31.04'

160.00'

I.P. Set

97.03'

103.32'

422.97'

0.75' I.P. Fd. & Used

I.P.'s Fd. 11.90'

Jeffrey A E
Deborah L. Grunda
O.R. Vol. 44, Pg. 878

MAP OF SURVEY & PROPOSED PARCEL SPLIT
PREPARED FOR
JEFFREY & DEBORAH GRUNDA

PART OF SURPLUS LOT NO. 26 GORE STRIP
BROWNHelm TOWNSHIP, LORAIN COUNTY, OHIO



MCGLINCHY AND ASSOCIATES
PROFESSIONAL ENGINEERS AND SURVEYORS

625 North Woodhill Drive Amherst, Ohio

SCALE: 1"=50' DRAWN BY: L.V. McGlinchy

DATE: 8/11/91 JOB NO: 918821