

Survey of
Henry Linderman Property
Part of Original Village Lots #35-40. Amherst Village
Lorain Co., Ohio.
May 4 1914 - Jan. 7, 1915. T.L. Gibson C.E.
Made at the request of Hamlin Humphrey Ad'mr.

300227

MAP P03 05-00-024-A
 PPN 05-00-024-102-017-019
 021-026

Scale 1" = 10 feet.

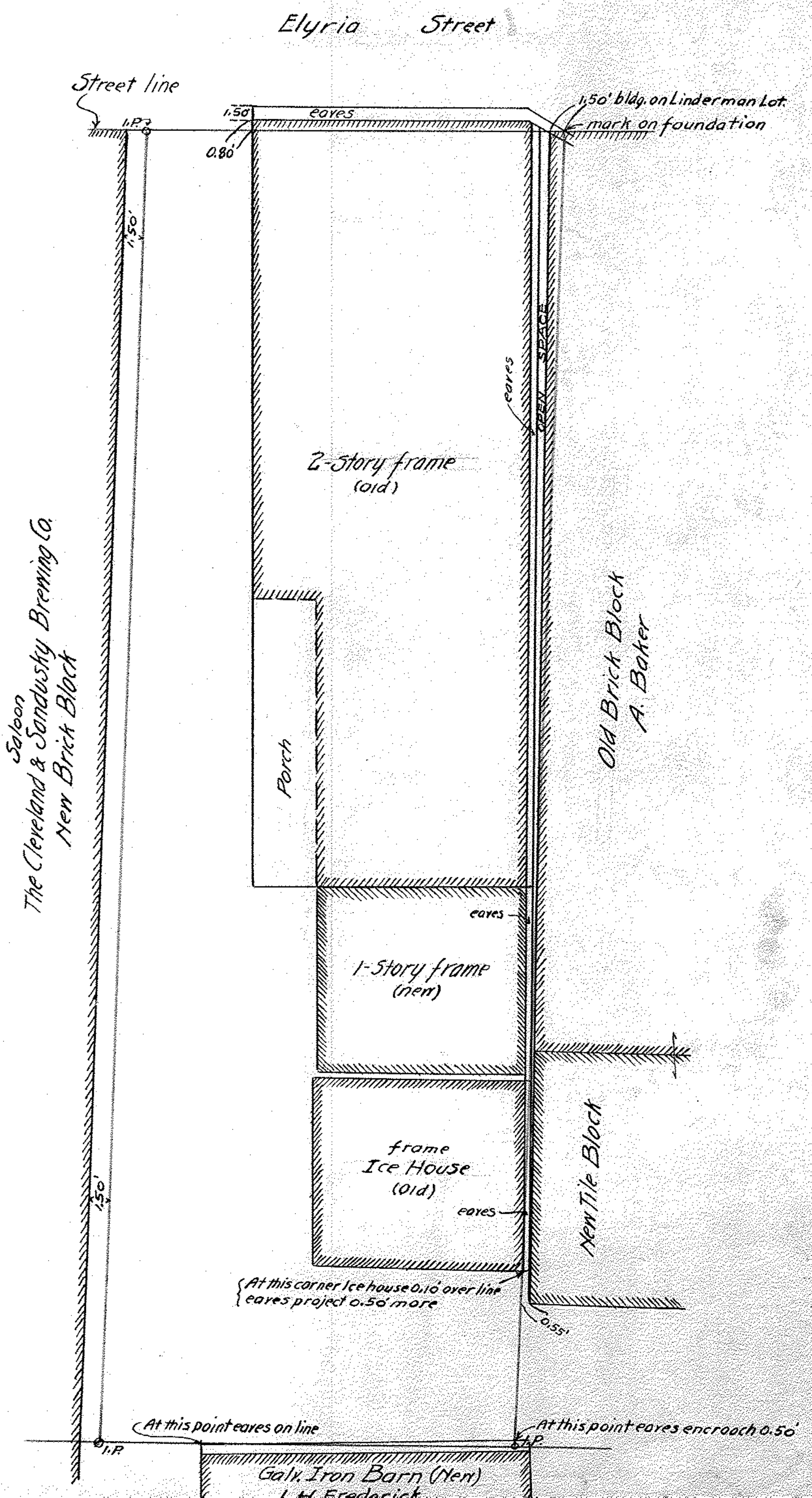

3-557