

No 02690
 APPROVED
 LORAIN CO.
 MAP DEPT
 DATE 4-28-09
 01:00:045 000 042,011,027
 PAGE 1:00045-A
 BY JHaffield
 \$ 09.02690

VERMILION ROAD

S 02°38'25"E 448.13' C.

O.L. 46
 O.L. 45

GENOWEF A. HOLLEY
 CRY. 305 5 170
 57-19720

1. PIPE FD.
 B. USED

MICHAEL A. REICHEL
 DOC. #20000725160
 1272872000

HEATH TESTER & CHARLOTTE PIMPHREY
 DOC. #886438111
 5722-98

CHARLES R. & WYCKI J. FELLHAUSER, TRS.
 DOC. #20030970012
 4779700

RR SPK
 FD. & USED

N 59°45'37"E 361.60' L.
 361.72' C.

COMBINATION NO. 2
 10.4815 ACS.

1. PIPE FD.
 N. C. 11'
 E. C. 12'

IAN T. MORRIS
 DOC. #20030970012
 12734700

1. PIPE FD.
 S. 0.02'
 E. 0.15'

1. PIPE FD.
 S. 0.02'
 E. 0.15'

1. PIPE FD.
 N. 0.02'
 E. 0.25'

1. PIPE FD.
 N. 0.02'
 E. 0.25'

1. PIPE FD.
 N. 0.02'
 E. 0.25'

1. PIPE FD.
 N. 0.02'
 E. 0.25'

1. PIPE FD.
 N. 0.02'
 E. 0.25'

1. PIPE FD.
 N. 0.02'
 E. 0.25'

1. PIPE FD.
 N. 0.02'
 E. 0.25'

1. PIPE FD.
 N. 0.02'
 E. 0.25'

1. PIPE FD.
 N. 0.02'
 E. 0.25'

1. PIPE FD.
 N. 0.02'
 E. 0.25'

1. PIPE FD.
 N. 0.02'
 E. 0.25'

1. PIPE FD.
 N. 0.02'
 E. 0.25'

1. PIPE FD.
 N. 0.02'
 E. 0.25'

1. PIPE FD.
 N. 0.02'
 E. 0.25'

1. PIPE FD.
 N. 0.02'
 E. 0.25'

1. PIPE FD.
 N. 0.02'
 E. 0.25'

1. PIPE FD.
 N. 0.02'
 E. 0.25'

1. PIPE FD.
 N. 0.02'
 E. 0.25'

1. PIPE FD.
 N. 0.02'
 E. 0.25'

1. PIPE FD.
 N. 0.02'
 E. 0.25'

1. PIPE FD.
 N. 0.02'
 E. 0.25'

1. PIPE FD.
 N. 0.02'
 E. 0.25'

SPLIT NO. 1
 8.6745 ACS.

S 33°52'15"E 1004.99'

100'

100'

100'

BASES OF BEARINGS IN THE CENTRAL OF NORTH HERE
 READ NORTH 99°45' 37" EAST.

DIMENSIONS SHOWN ON THIS PLAT ARE EXPRESSED
 IN FEET AND DECIMAL PARTS THEREOF, ALL BEARINGS
 ARE TO AN ASSUMED MERIDIAN AND ARE USED TO
 INDICATE ANGLES ONLY. PERMANENT MONUMENTS
 WERE FOUND OR SET AT ALL POINTS INDICATED
 HEREON, ALL OF WHICH I CERTIFY TO BE CORRECT.

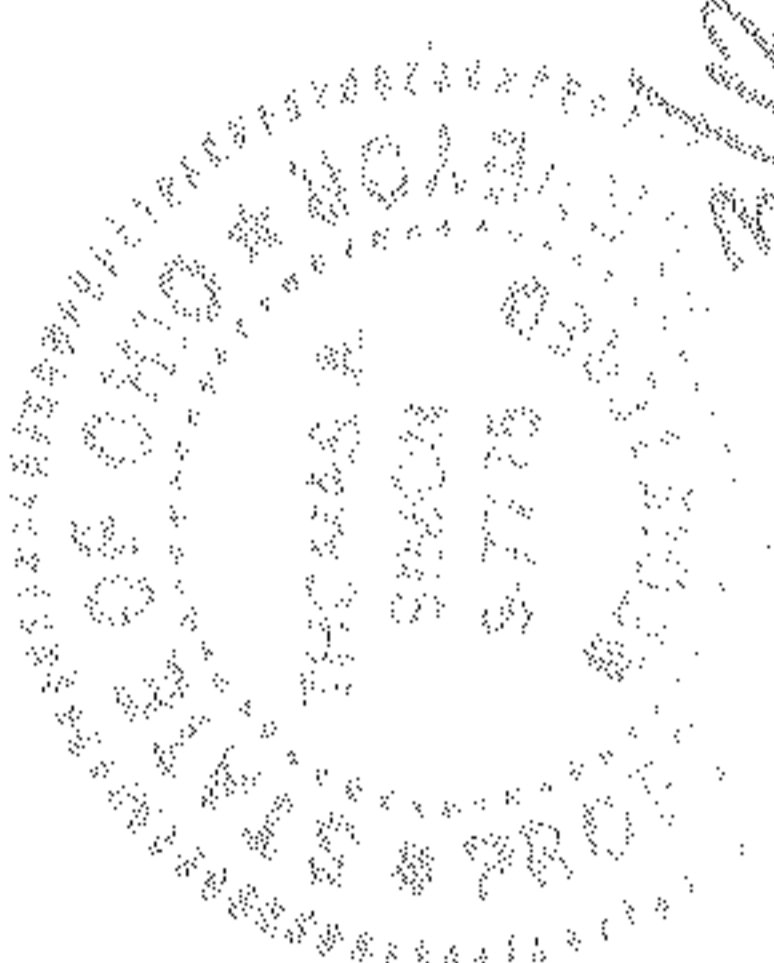

THOMAS A. SIMON
 REG. PROFESSIONAL SURVEYOR
 NO. 9-7775

3/12/09

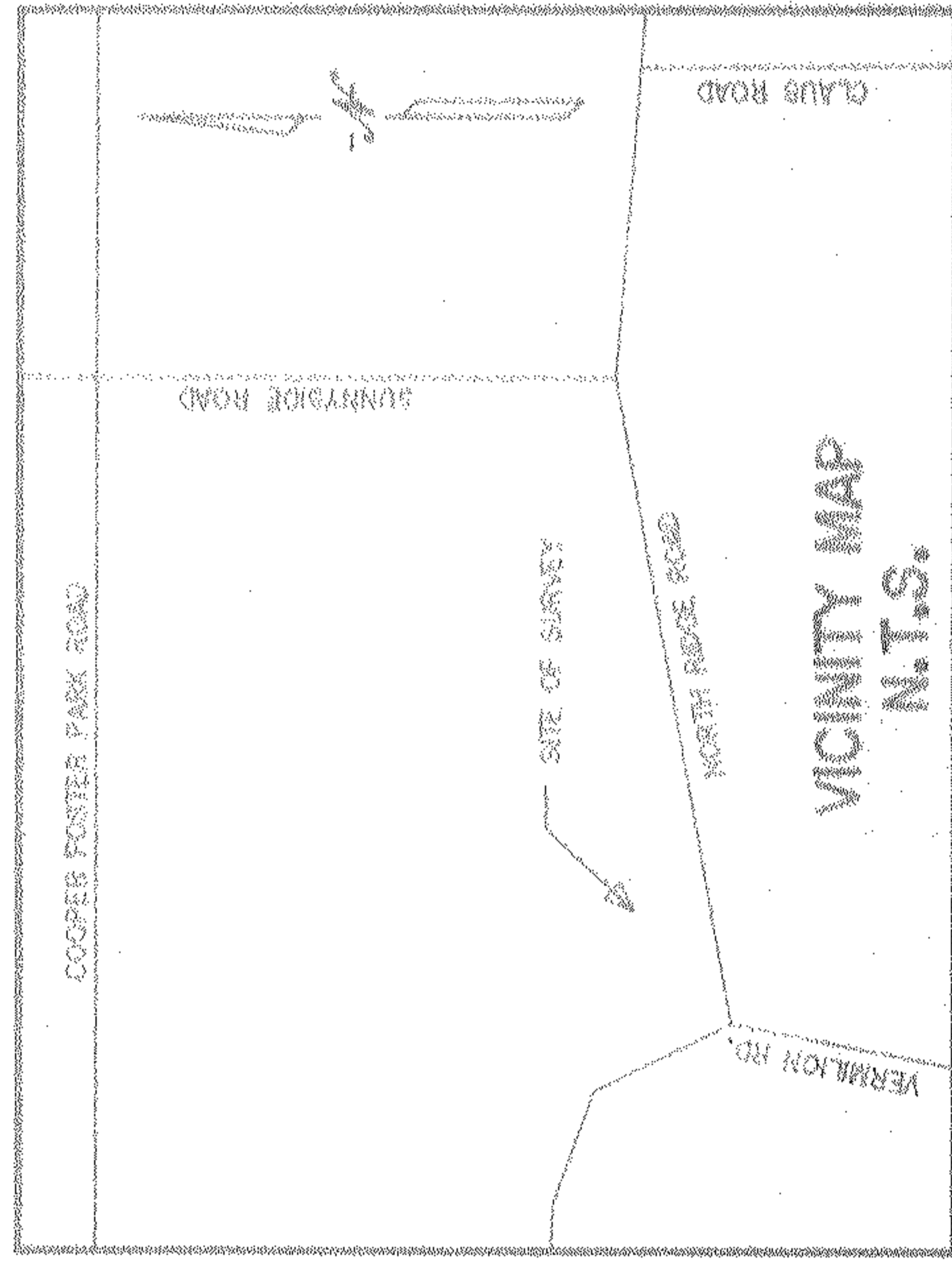

PLAT OF SURVEY
 SPLIT AND COMBINATION
 FOR

RALPH ROLING
 IAN T. MORRIS

BEING KNOWN AS PART OF ORIGINAL BROWNHELM TOWNSHIP
 LOT NO. 45

CITY OF VERMILION COUNTY OF LORAIN
 STATE OF OHIO

MARCH, 2009 SCALE: 1" = 100'

THOMAS SIMON & ASSOCIATES, INC.
 PROFESSIONAL LAND SURVEYORS

150 SOUTH OLIVE STREET
 ELYRIA, OHIO 44035

(440) 327-2925
 FAX 327-2964

REV. 4-1-09 CITY ENG. COMMENTS
 REV. 3-15-09 COMB. NO. 2, SPLIT NO. 2