

PLAT OF BOUNDARY SURVEY
JOHN S. HADGIS
 ORIGINAL LOT 3 & PART OF ORIGINAL LOT 4
 TRACT NUMBER 3, ROCHESTER TOWNSHIP
 LORAIN COUNTY, OHIO

TOTAL AREA SURVEYED: 176.7610 ACRES
 AREA EXCEPTED: 4.8886 ACRES
 TOTAL AREA TO BE CONVEYED: 171.8724 ACRES

TOTAL AREA LOCATED IN ORIGINAL LOT 3: 119.5089 ACRES
 AREA EXCEPTED IN ORIGINAL LOT 3: 3.3167 ACRES
 TOTAL AREA TO BE CONVEYED IN ORIGINAL LOT 3: 116.1922 ACRES

TOTAL AREA LOCATED IN ORIGINAL LOT 4: 57.2521 ACRES
 AREA EXCEPTED IN ORIGINAL LOT 4: 1.5719 ACRES
 TOTAL AREA TO BE CONVEYED IN ORIGINAL LOT 4: 55.6802 ACRES

TRACT 3

STEWART ROAD

ORIGINAL LOT 3

ORIGINAL LOT 4

TRACT 3

LINE	BEARING	DISTANCE
L1	N 0°52'00" E	80.19'
L2	S 1°35'19" W	80.13'

NOTE:
 ALL REFERENCES SET ALONG STEWART ROAD
 ARE SET ON THE PROPERTY LINE, 30.00 FEET
 DISTANT FROM AND AT RIGHT ANGLES TO THE
 CENTERLINE OF STEWART ROAD.

Legend

- ⊗ Railroad Spike Found
- △ Iron Pin Found
- Iron Pipe Found
- ⊙ PK Nail Found
- ⊠ Fence Post Found
- ⊙ 1/2" Iron Pin Found
- ⊙ Magnetic PK Spike Set
- ▲ 5/8" Iron Pin Set with Cap Stamped "Kelsner 7871"
- Woven Wire Fence

BEARINGS
 ARE
 ASSUMED.

ERROR OF CLOSURE IS
 LESS THAN 1:10,000.

SCALE 1"=200'

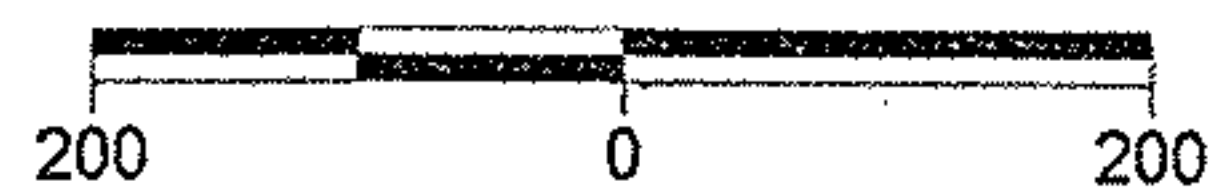

LAUNDON • SIMON • CAHL & ASSOC., INC.
 PROFESSIONAL LAND SURVEYORS
 110 MIDDLE AVE. • ELYRIA, OHIO • 44035
 PHONE (440) 322-7625

DATE:	07/18/00
JOB NO.:	S20000Z
LSC NO.:	00-3265

Alex Kelsner
 Alex Kelsner

RLS #7871

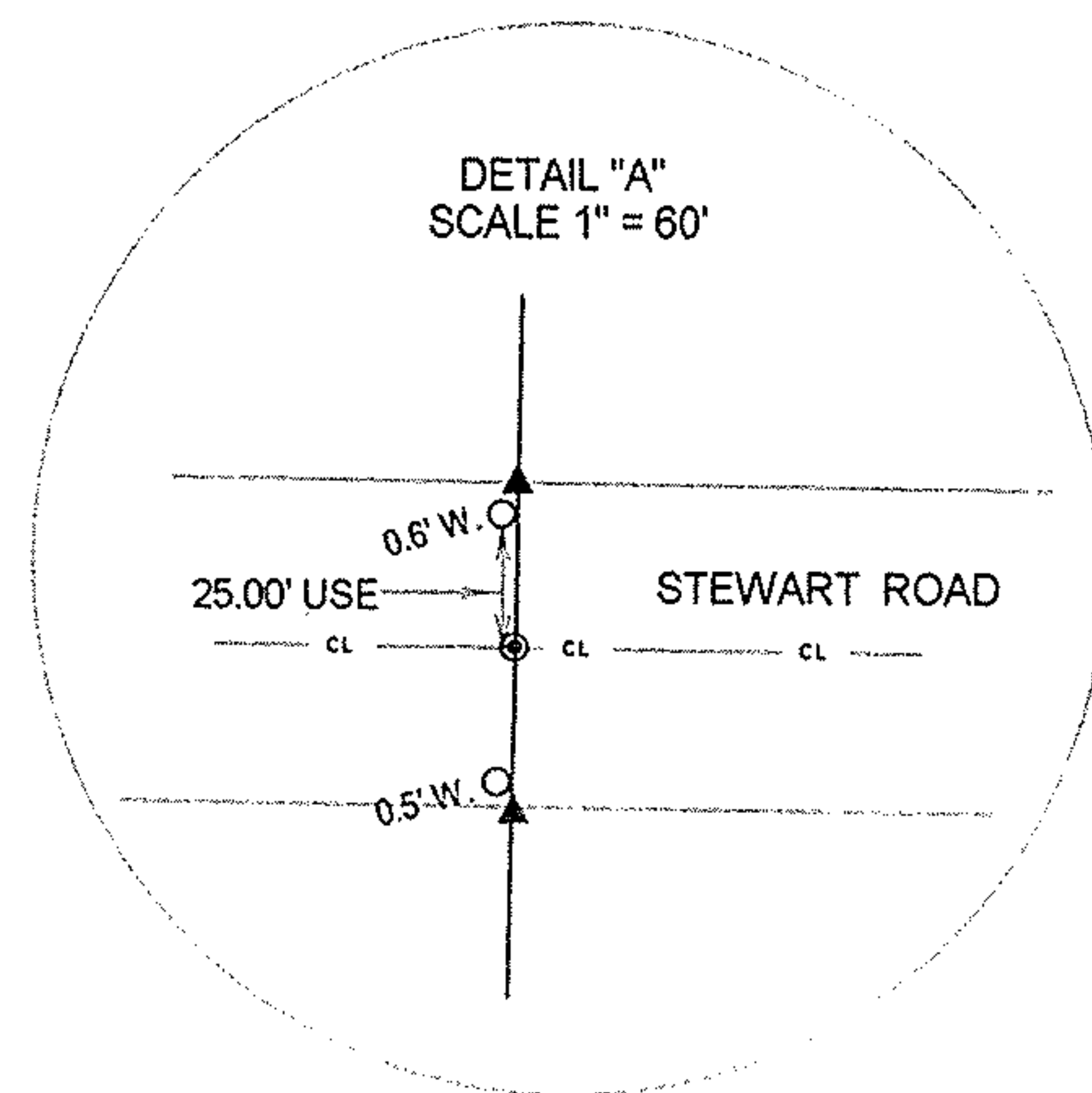

DONALD E. & MARIAN STOLL
 DEED VOL. 510, PG. 531

1

-001

-008

ALBERT ELTON, JR. & FRANCES CAMPBELL
 D.V. 586, PG. 469

#00414-A

APPROVED
 LORAIN CO.
 MAP DEPT.

DATE 8/17/00
 20-03-003 B & D
 PAGE 20-H

BY T. SPILLMAN
 00414-A

