

MAP OF SUB-LOT NO. 1 OF BLOCK NO. 7  
 W. A. BRAMAN'S SUB'N. VOL. 3 PG. 18 PLATS  
 O.L. 3 - TRACT 1 - BLACK RIVER TOWNSHIP  
 LORAIN CITY - LORAIN COUNTY - OHIO  
 SCALE: 1" = 20' JAN. 19-1969 1:30 P.M.  
 Gary E. Penfound REG. SURVEYOR  
 Ord. No. 1904 Alfred & Jean Porkolab

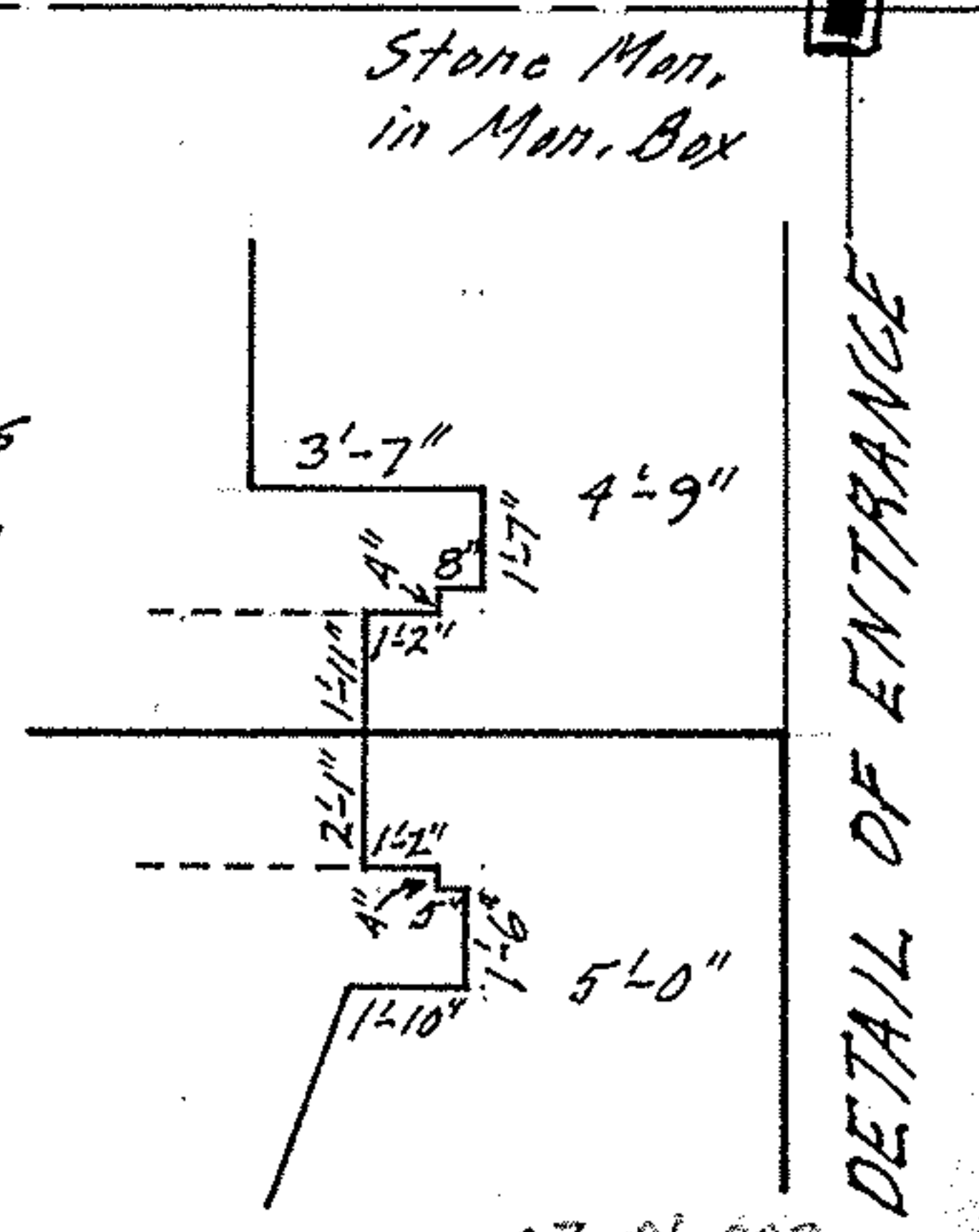

DETAIL OF ENTRANCE