

Plat of Survey for Deborah Henderson

Being a part of original Lot 18 and a part of Sublots
11 and 12 within the City of Amherst, Lorain County, Ohio

06-02262

APPROVED
LORAIN CO.
MAP DEPT.
DATE 11/8/06
PAGE 5.00.018.B
BY R. MAINES
06-02262

Split off de-02095

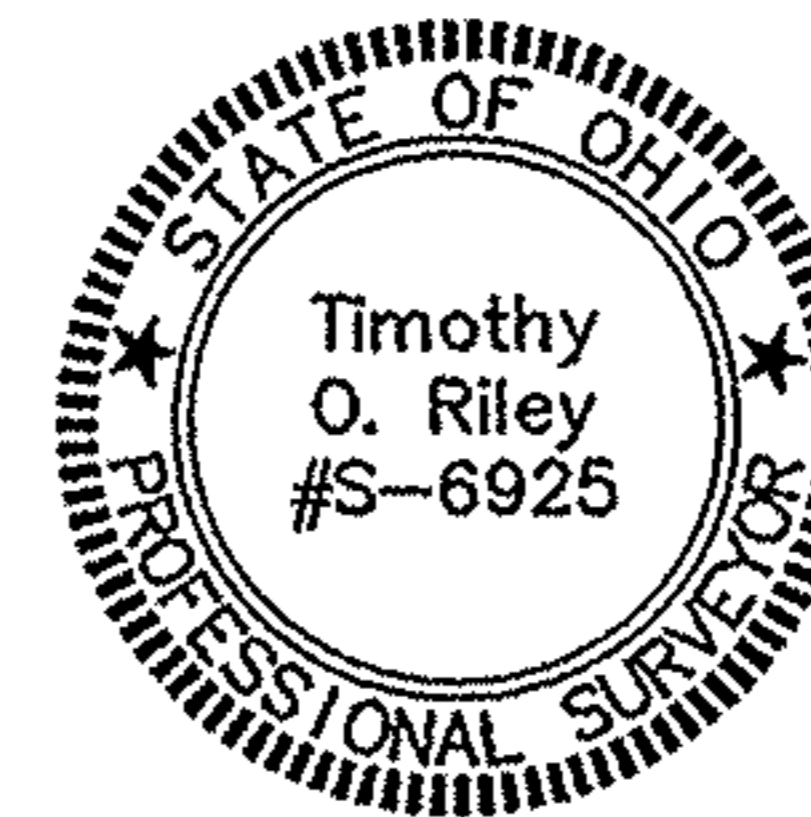

Timothy Riley
Timothy Riley
Reg. Surveyor No. 6925

Date: 11-27-2005 Dwn By: CAD
Scale: 1" = 50' Ckd By: TOR
Original Lot 18
Job No. 32008 Long St

Timothy Riley
ENGINEER - SURVEYOR
Norwalk, Ohio

9/16" Hex Bar Set O Nail Set
Monument Found
Inch Scale
E/C 1:10000