

RICHARD F. & JUDY A. WALLHEAD
 9505 MURRAY RIDGE RD.
 DOC. NO. R20000666169
 P.P.N. 06-24-006-000-034
 DOC. NO. R20000666169
 P.P.N. 10-00-002-000-002

RICHARD F. & JUDY A. WALLHEAD
 DOC. NO. R2000066619
 P.P.N. 06-24-006-000-035

CITY OF ELYRIA
 O.R. VOL. 11, PG. 8
 P.P.N. 06-24-007-101-019

BELLEVUE LAND DEVELOPMENT
 934 INFIRMARY RD.
 DOC. NO. R20020847969
 P.P.N. 06-24-007-101-020

PARCEL "A"
 47.3823 TOTAL ACRES TO C/L
 43.8992 ACRES TO C/L (SEC. "2")
 3.4831 ACRES TO C/L (SEC. "3")

PARCEL "D"
 11.9521 ACRES TO C/L

PARCEL "C"
 3.7236 ACRES TO C/L

PARCEL "B"
 15.4861 ACRES TO C/L

OHIO CONFERENCE ASSOCIATION
 OF THE SEVENTH DAY
 ADVENTIST CHURCH
 9652 MURRAY RIDGE RD.
 O.R. VOL. 528, PG. 707
 P.P.N. 10-00-002-000-003

LOT SPLIT MAP
 FOR
THE ESTATE OF
ANN MAURER

SITUATED IN THE TOWNSHIP OF CARLISLE,
 COUNTY OF LORAIN, STATE OF OHIO, AND
 KNOWN AS BEING PART OF ORIGINAL CARLISLE
 TOWNSHIP SECTIONS NOS. 2 & 3
 CIPS-CAPPED 5/8" IRON PIN SET
 SCALE 1" = 200'
 MAY 7, 2003

STATEMENT

I HEREBY STATE THAT THIS A TRUE AND ACCURATE
 REPRESENTATION OF THE PREMISES SHOWN HEREON AND THAT
 IT WAS DONE IN ACORDANCE WITH THE MINIMUM STANDARDS
 FOR BOUNDARY SURVEYS IN THE STATE OF OHIO AS ADOPTED
 IN THE ADMINISTRATIVE CODE CHAPTER 4733-37. ALL TO
 THE BEST OF MY KNOWLEDGE AND PERSONAL BELIEFS. ALL
 COURSES ARE GIVEN TO AN ASSUMED MERIDIAN.

BY, *James B. Root*
 JAMES B. ROOT
 REGISTERED SURVEYOR No. 5045

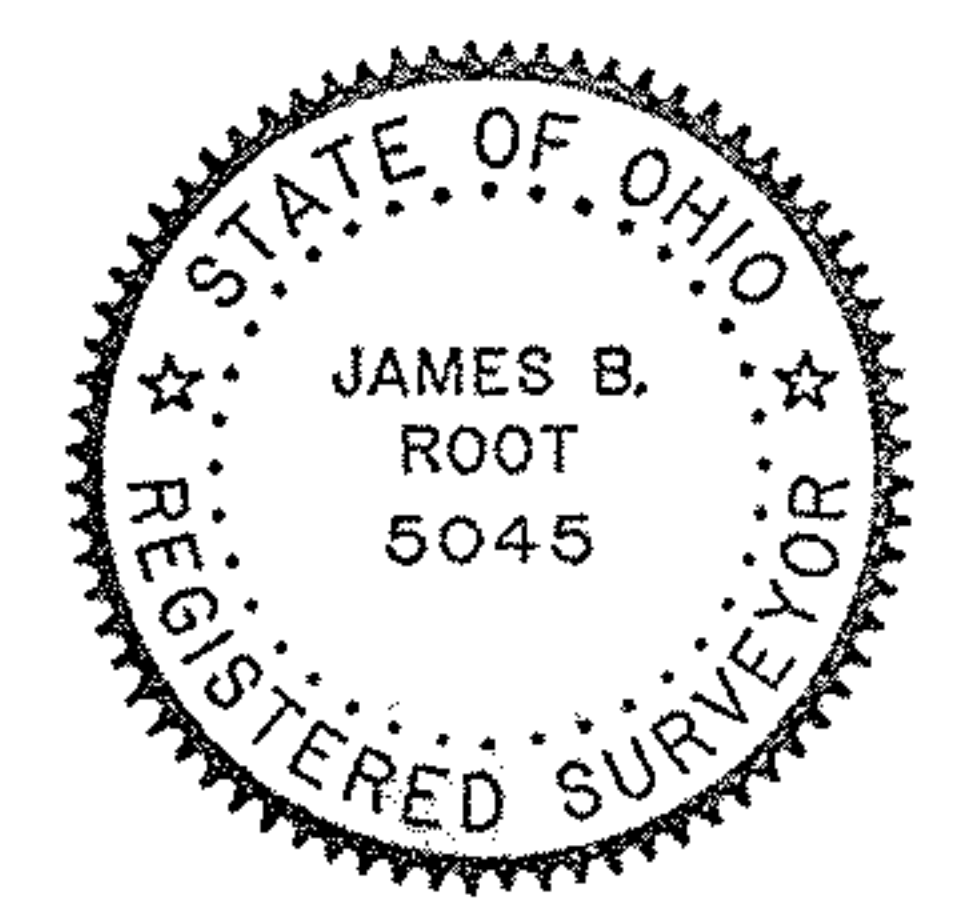

JAMES B. ROOT & ASSOCIATES
 200 ELLEN DRIVE, BEREA OHIO 44017
 (440)243-9843 FAX (440) 243-3026