

Nora D. Abbe & William Betteridge

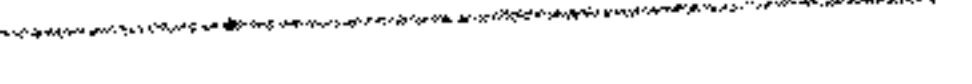
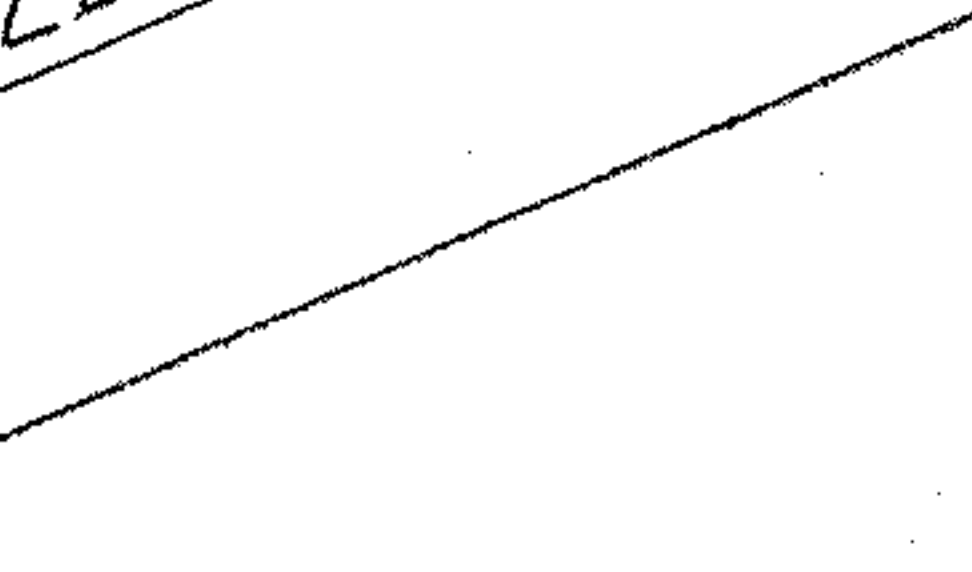
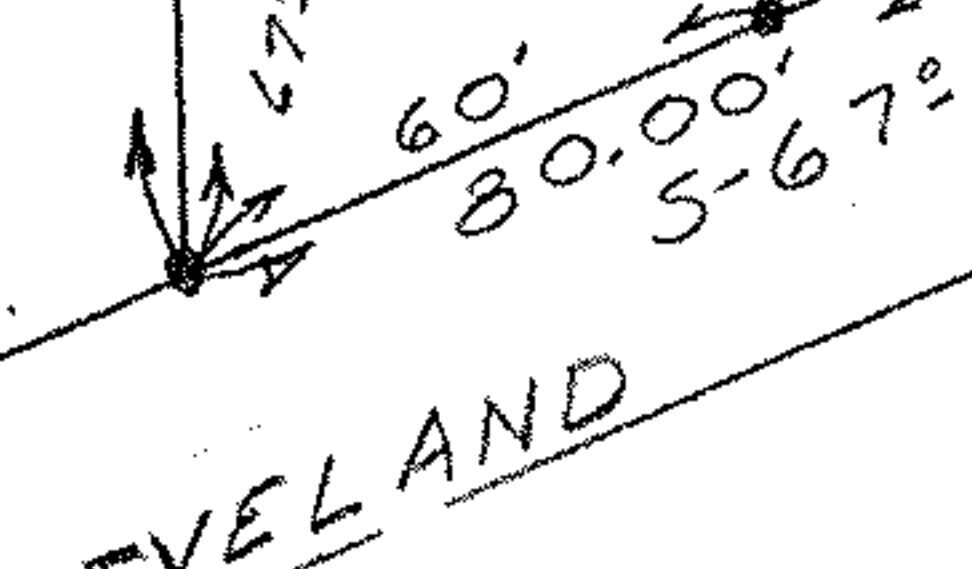
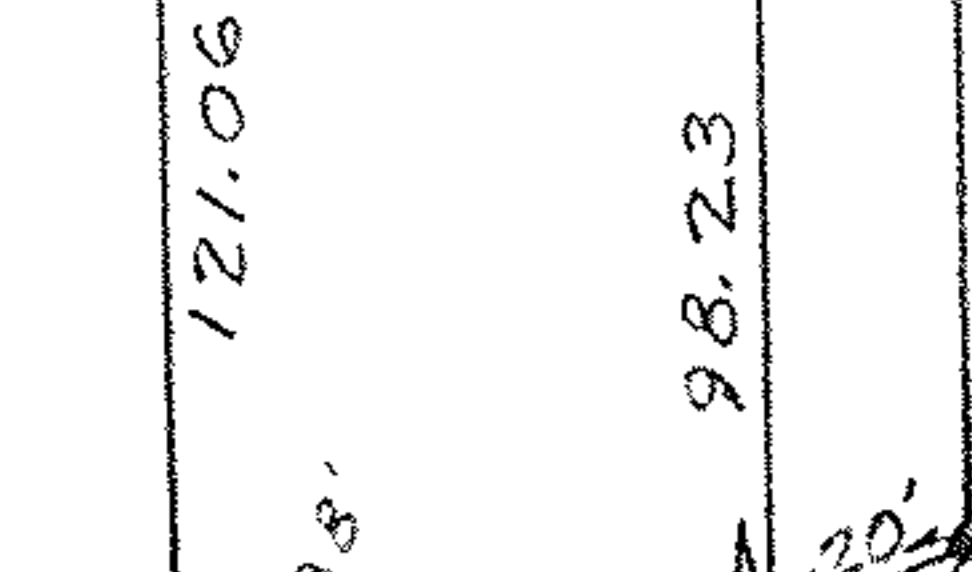
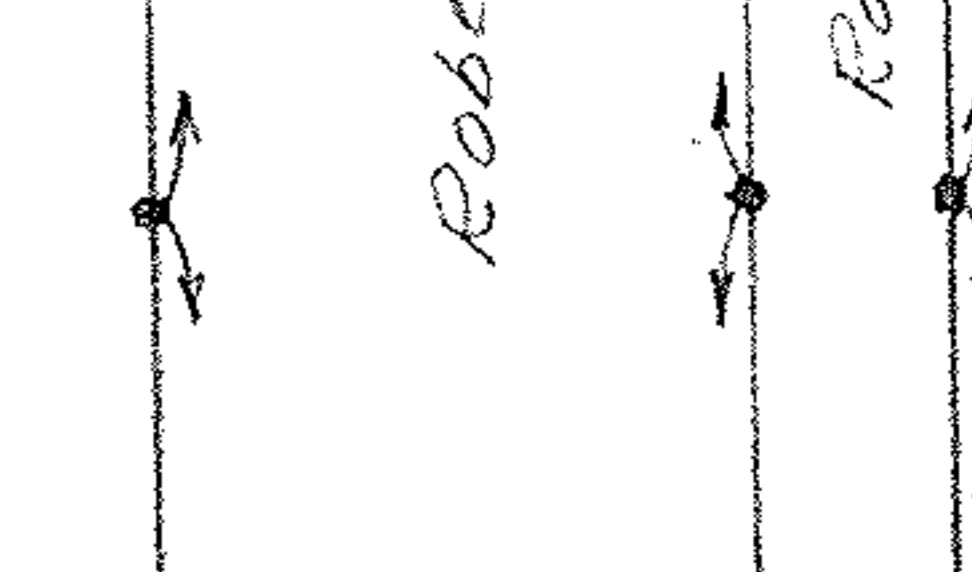
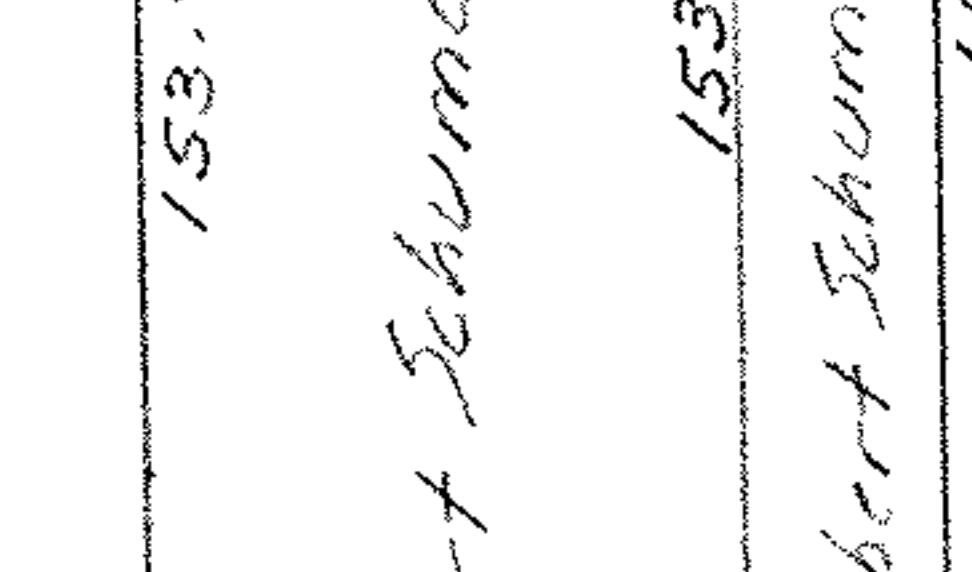
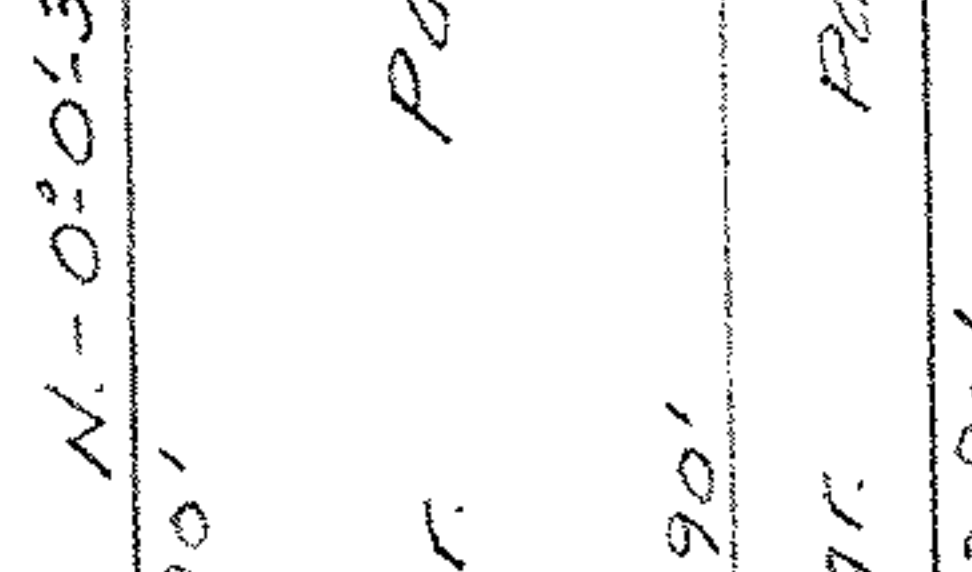
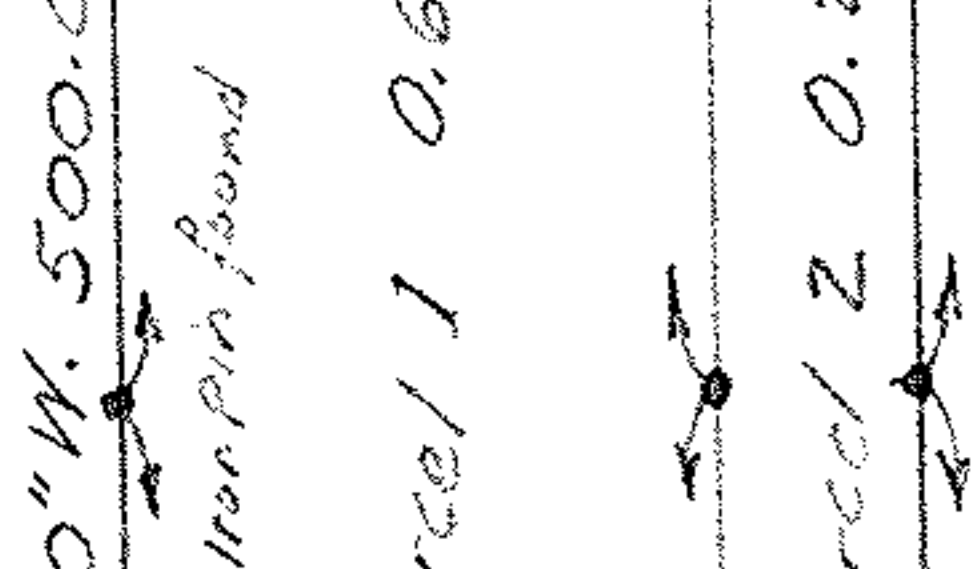
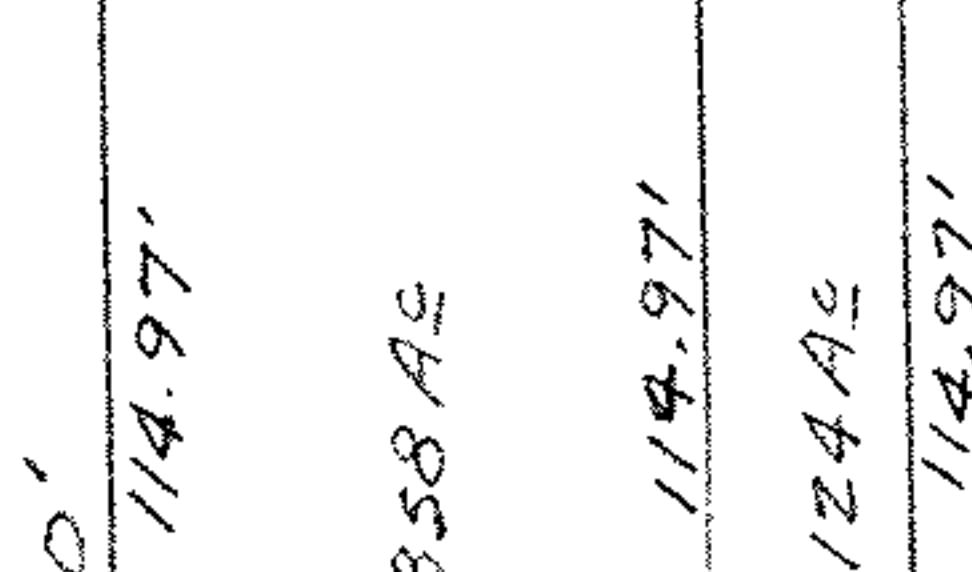
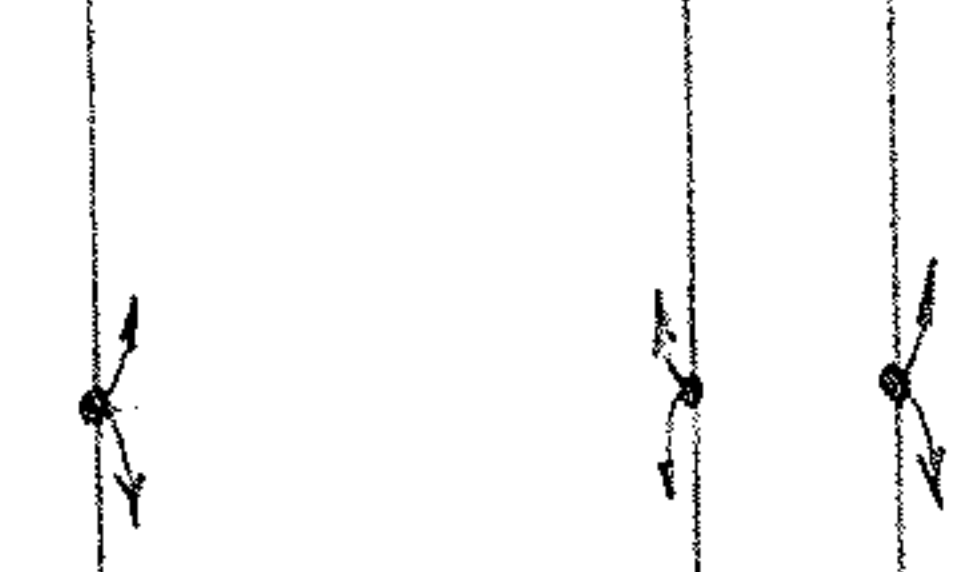
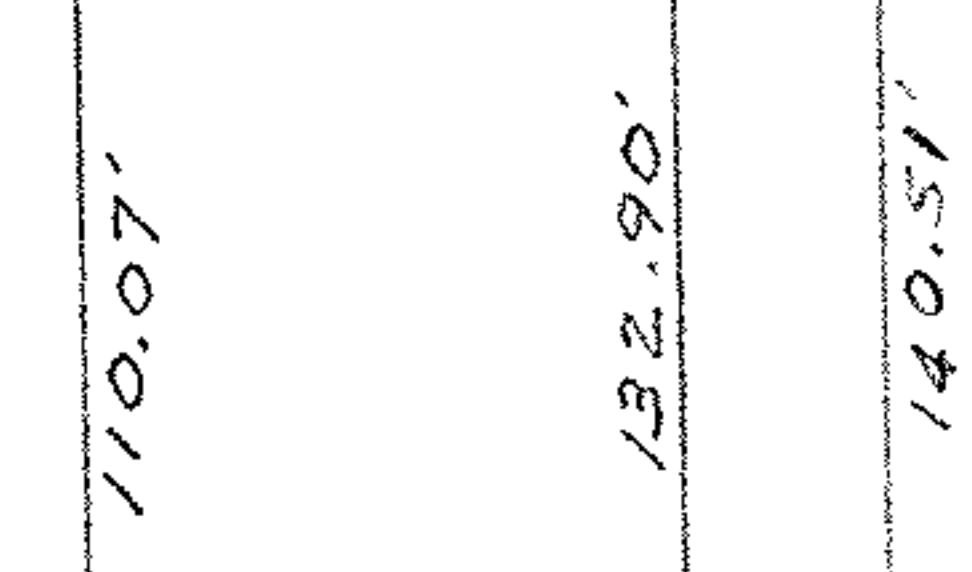
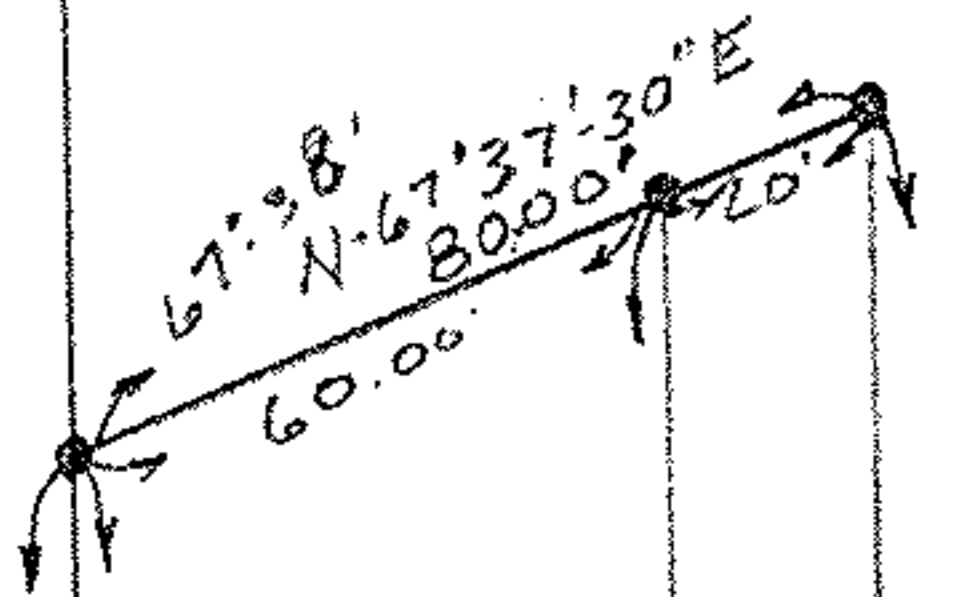

N - 0° 01' 30" W. 500.00'

Iron Pin found

Parcel 1 0.63358 Ac

Parcel 2 0.2124 Ac

Eva Osborne Scott

D. Vol. 499 Pg. 579 Sept. 23-1950



Iron Pin found

Priscilla J. Harmon

Iron Pin found

STREET.

Iron Pin found.

CLEVELAND

MAP OF SURVEY FOR  
 Robert Schumar  
 CITY OF ELYRIA - ORIG. LOTS  
 23-24-26 EAST OF BLACK RIVER  
 LORAIN COUNTY OHIO  
 Scale 1" = 50 FT. APRIL-12, JUNE-14-1952  
 C. E. Penfound Registered Surveyor  
 06-25-023, 4, 6