

- Iron Pipe
- Railroad Spike
- Stone Monument

87-25-10
 1-07-45
 $30/\cos 28^{\circ} 34' 55'' = 30.01'$
 83-06-05
 1-03-40
 $30/\cos 50^{\circ} 44' 10'' = 30.15'$
 73-48-25
 0-24-15
 $74^{\circ} 12' 40''$
 105-47-30
 $30/\cos 15^{\circ} 27' 30'' = 31.76'$

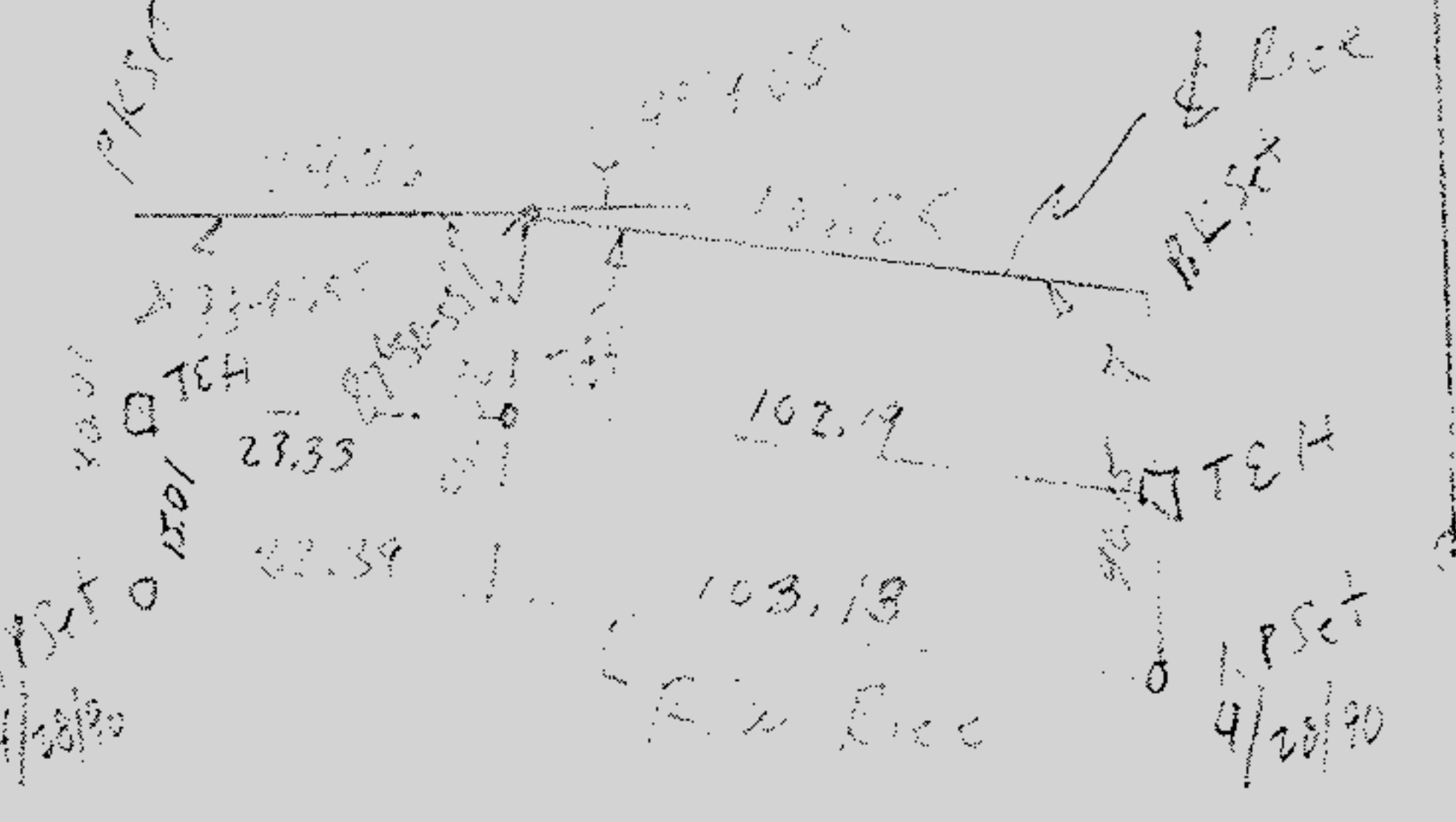

PROPOSED PARCEL SPLIT
 O.L. 95 AMHERST TWP.
 LORAIN COUNTY, OHIO
 For
 RONALD CONN

McGLINCHY & ASSOCIATES
 Professional Engineer & Surveyor
 625 N. Woodhill Drive
 Amherst, Ohio 44001
 Job No. 928792 April, 1990