

PLAT OF SURVEY FOR ROSS FRICK
 ORIGINAL LOT 21 COLUMBIA TOWNSHIP
 LORAIN COUNTY OHIO
 SCALE: 1"=100'
 APRIL 1974

Gary E. Penfound
 Reg. Surveyor No. 4457

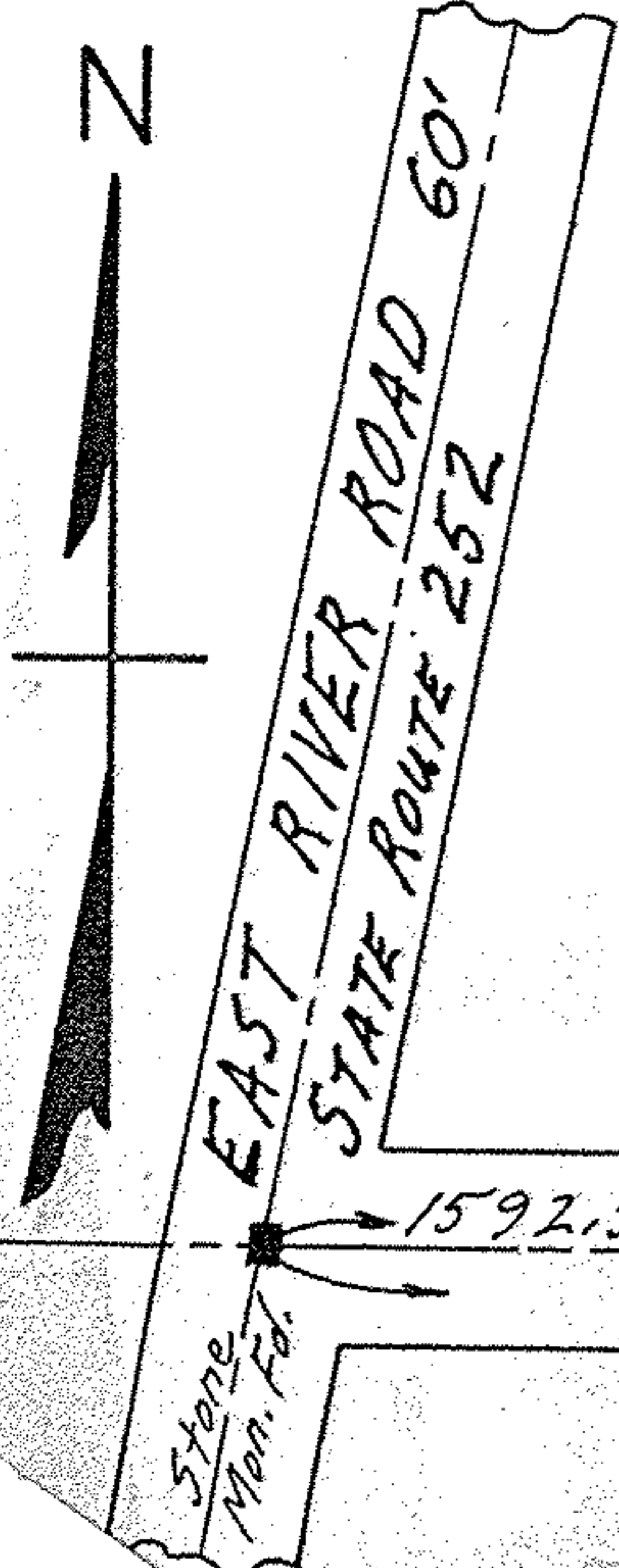

NOTES: ○ indicates iron pin found.
 ⊙ indicates iron pin found in concrete.
 ● indicates iron pin set.

