

Section D
S.E. 2 - S.E. 3
Block E

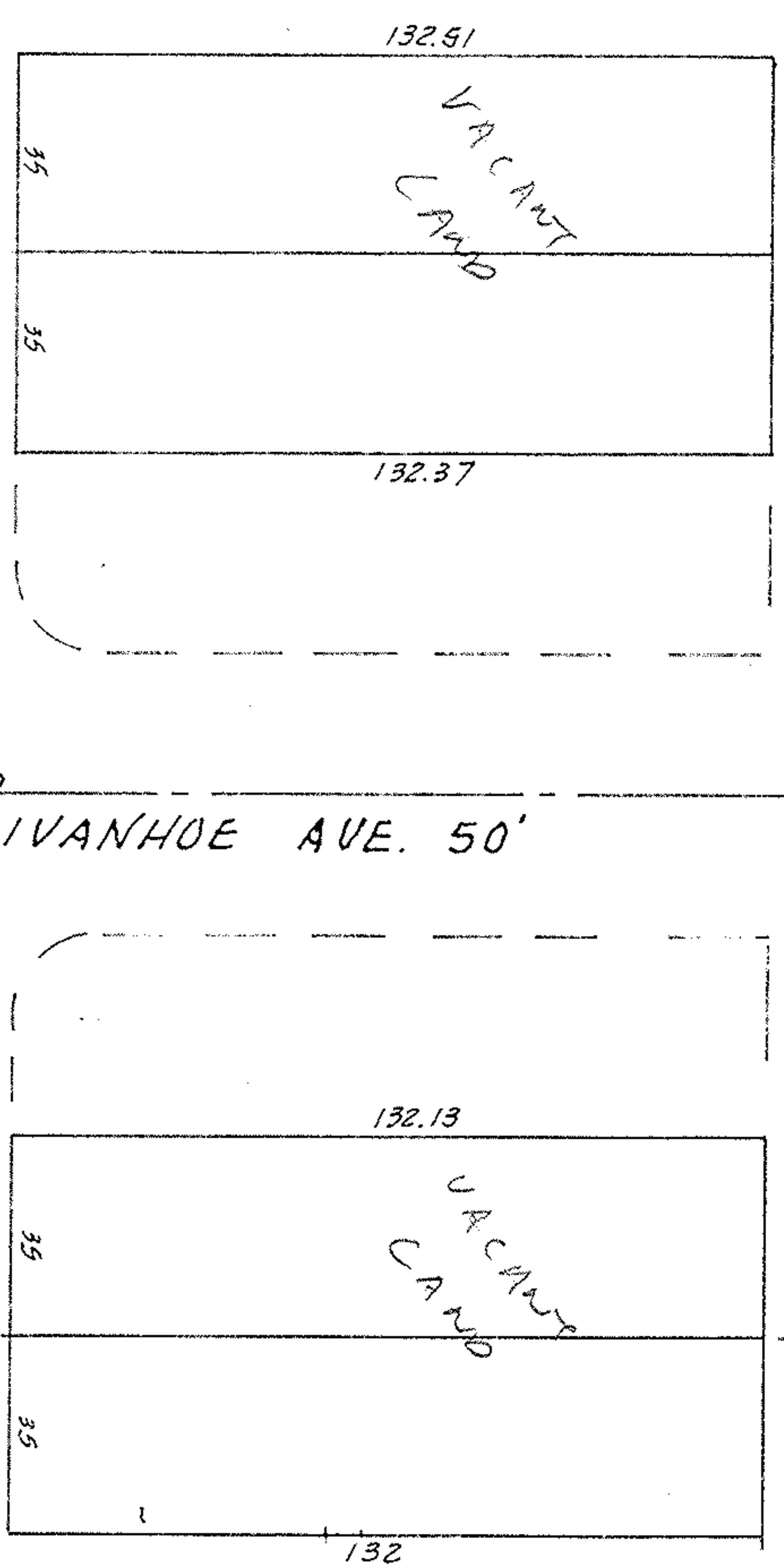

LAFAYETTE BLVD 70'

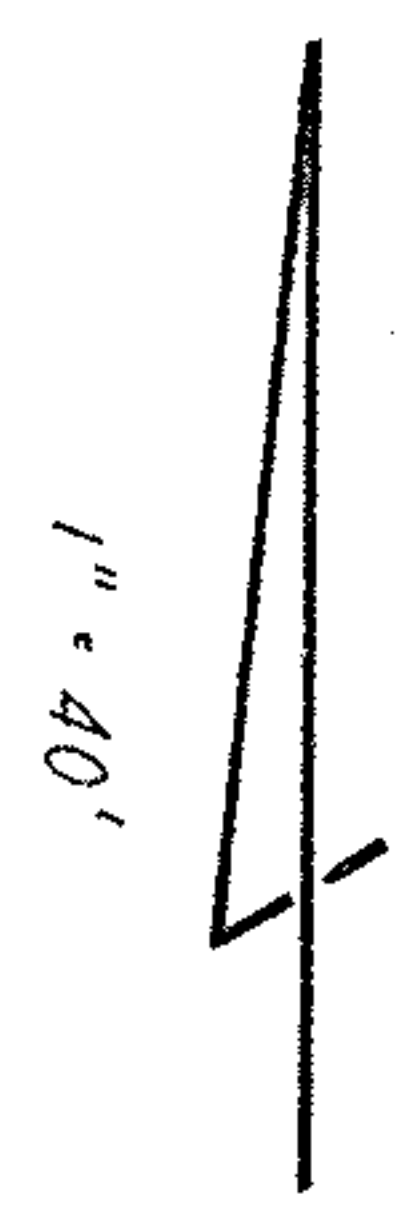

SUBLOTS #23 & 24 of BLOCK 'D' plus SUBLOTS #243 of BLOCK 'E'
of CORAL BEACH SUBDIVISION
PLAT VOL. 11 PAGES 17 & 18
PART of ORIG. SHEFFIELD TWP. LOT 37
NOW in CITY of SHEFFIELD LAKE, OHIO

McGLINCHY & ASSOCIATES
MAY 1977 #771959