

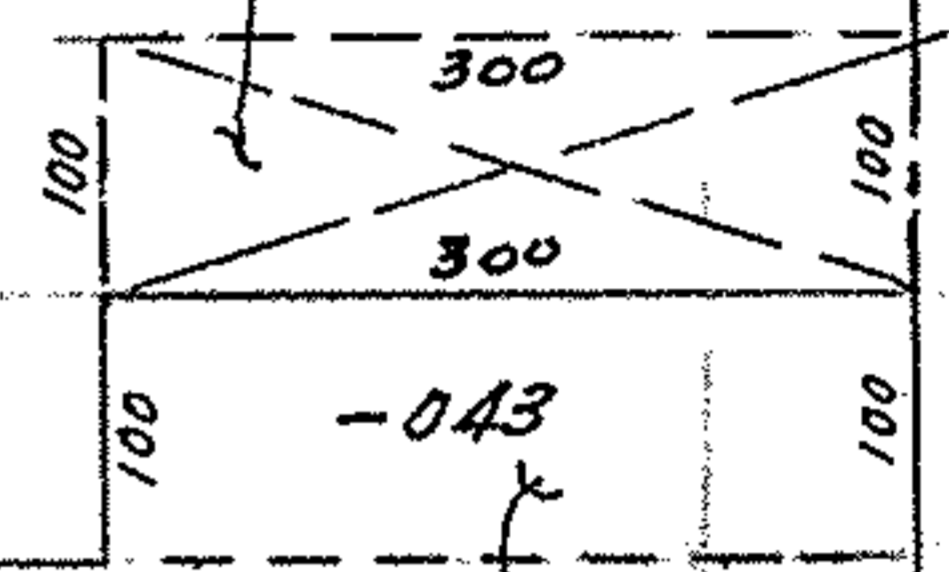

PROPOSED SPLIT

1521.3

SHELBY GLEN & JEAN M. HARDWICK  
ORIG DEED VOL. 1090 PG. 358 10.42 AC  
P.P. # 09-00-004-101-044



ANNIS ROAD

DALE M. BILANCINI &  
RITA A. ANDREY  
DEED VOLUME 1178 PG. 240

PROPOSED PARCEL SPLIT FOR  
SHELBY GLEN & JEAN M. HARDWICK

SUBLOT of

PLAT VOL. PAGE  
PART of ORIG. RUSSIA TWP. LOT 4  
NOW in CITY of VILLAGE of SOUTH AMHERST, OHIO, OHIO

McGLINCHY & ASSOCIATES INC.  
FEB 8, 1982 #827124