

MAPLE HEIGHTS SUBDIVISION N^o 3.

LORAIN, OHIO

Scale 1" = 50'
Vol. 15 Pg. 35

Lots in blank - Alex Bruscano & Orrin Shultz

EAST HAVEN ALLOTMENT N^o 174

DAKOTA ST.

Cons. Mon. fee

North Line Maple Heights N 87° 59' W 655.40'

WILSON ST. 60'

LARKMOORE SUB. VOL. 9, PG. 20

103 Richard L. & Jeanne C. Landfried 10/21/52

102 W. Joseph & Madeline Koeft 10/23/52

101 James F. & Agnes Eustace 10/23/52

100 W. John & Elsie M. Geiger 10/23/52

98 Harry E. & Louise E. Evans 11/20/52

97 W. H. & Norma J. Fitts 11/20/52

95 Daniel Vincent & Mildred June Meyers 10/23/52

104 Lawrence A. & Lorna G. Right + Roberta Blannenship

105 CITY TITLE CO. E-961-2 11/29/64

106 R.F. & J.L. Royce 11/20/56

107 Roger H. & Margaret H. Hendrick 11/20/52

108 Jack A. & Jean Cost 11/20/52

109 Anton A. & Bonnie L. Campbell 11/20/52

110 Mark A. & Elizabeth Thomas 11/20/52

111 Sumner G. Whittier Adm. of Vert. Affairs 3/14/58

112 Mike E. & Mary Ann Johnson 11/20/52

113 Frank & June Kanio 11/20/52

114 John M. Bruns 4/9/53

115 Ohio Bar-Bottleki 9/11/67

116 Joseph John & Margaret M. Johnson 11/20/52

117 Anthony J. & June M. Johnson 11/20/52

118 Arpad & Norma May Lott 11/20/52

119 Leonard R. & Helen E. Maloney 11/20/52

120 George J. & Mary Jane Johnson 11/20/52

121 Steve J. & Kaye A. Johnson 11/20/52

122 Ohio Bar-West 4/3/63

123 Ohio Bar-West 4/3/63

124 James R. & Jennie S. Johnson 11/20/52

125

144 G.R.W. Locher 2/15/56

145 Justin M. & Evelyn H. Fox 11/20/52

146 Joseph B. & Mary E. Donald + Barbara J. Shady 11/20/52

147 A.S. & J. Krokas 6/22/56

148 Nicholas G. & Rita M. Muskas 7/15/53

149 Patrick M. & Therese M. Sullivan 11/20/52

150 Henry R. & Margaret E. King 11/20/52

151 Joseph M. & Dorothy M. Frommelt + John E. Keefe 9/1/56

152 Charles D. & Wanda Coscogno 11/20/52

153 Richard B. & Rosalie J. Ross + Joseph + Nancy Crews 8/25/58

LARKMOOR ST. 60'

94 Gerald F. & Dorothy F. Patis 10/23/52

93 George & Anna Gertrude M. Gansiska 11/20/52

92 Peter & Gloria B. Lobanow 11/20/52

91 Charles R. & Dorothy Ruth 10/23/52

90 Robert Lewis & Marie L. Smith 11/20/52

89 Lawrence J. & Jean M. Cole 4/7/53

88 Joseph J. & Daisy H. H. 11/20/52

87 Ronald A. & Vera Jennings + James A. & Mary L. Barnes 11/20/52

86

EASTLAWN ST. 60'

126

127

128

129

130

131

132

133

134

135

136

85

84

83

82

81

80

79

78

77

76

75

74

73

72

71

70

125.03

125.03

125.03

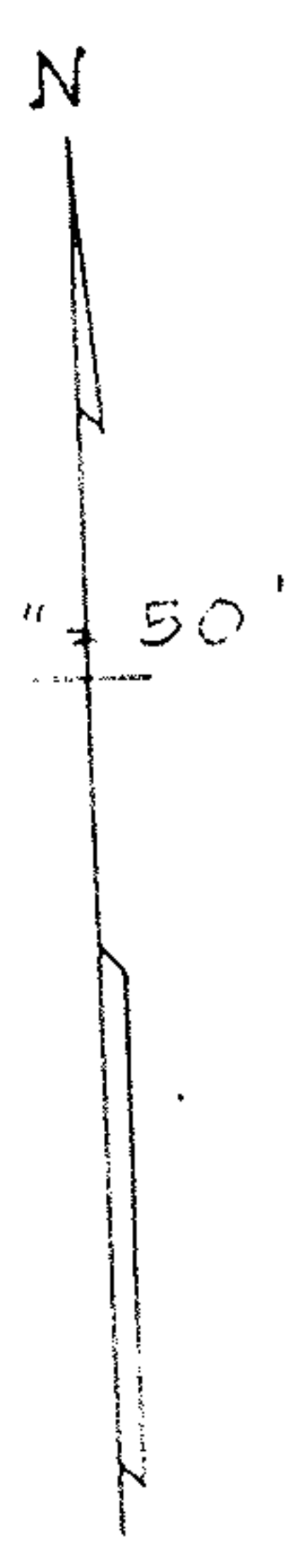

1" = 50'

LARKMOORE SUB. VOL. 9, PG. 20

N-2 000'

60'

DRIVE

CEDAR

100.00'

100.00'

60'

DRIVE

MAPLE

100.00'

100.00'

CITY OF LORAIN PARK. BY DEED VOL. 492 PG. 334.

FLORENCE V. KOHLMYER

CORNELIUS KOHLMYER

City of Lorain 3/4/55

LAKE ERIE & PITTSBURGH R. R.

N-87° 00' W