

Plat of Survey for Deborah Henderson

Being a part of original Lot 18 and a part of Sublots 11 and 12 within the City of Amherst, Lorain County, Ohio

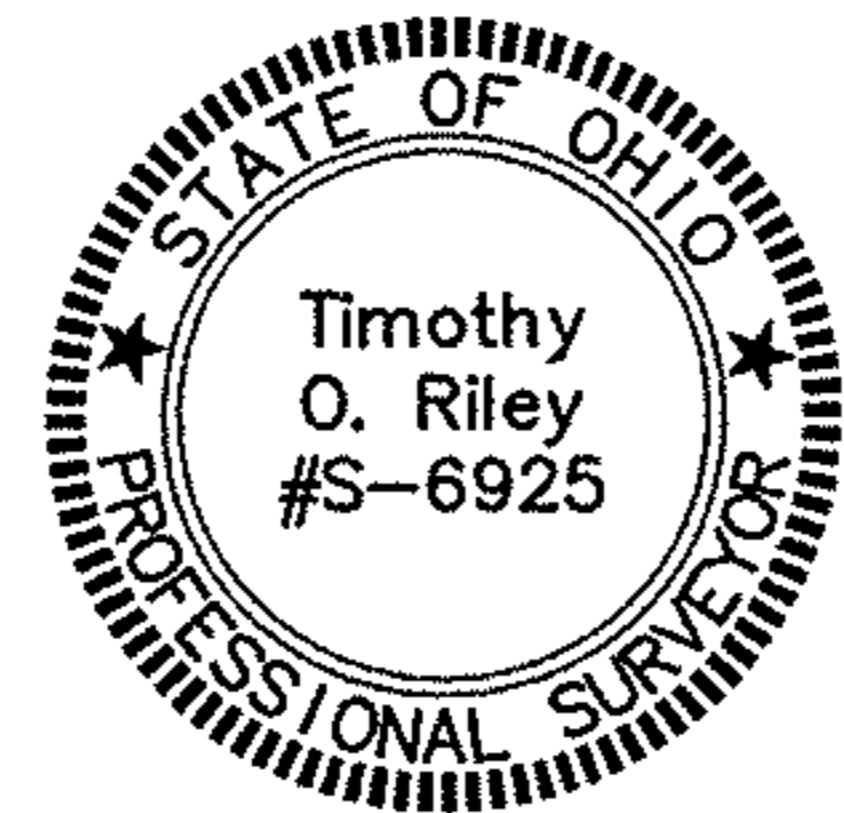

Timothy Riley
Timothy Riley
Reg. Surveyor No. 6925

Split # 06-020915

Date: 11-27-2005	Dwn By: CAD
Scale: 1" = 50'	Ckd By: TOR
Original Lot 18	
Job No. 32008 Long St	

E/C 1:10000		

Timothy Riley
ENGINEER - SURVEYOR
Norwalk, Ohio