

BOARD OF PARK COMMISSIONERS
 LORAIN COUNTY METROPOLITAN PARK DISTRICT
 SEPT. 27, 1993
 O.R.V. 779, P. 382

ZONE A APPROXIMATE
 100-YEAR FLOOD
 BOUNDARY AS PER COMMUNITY
 PANEL NUMBER 390346 0085 B

LOST ELMS DEVELOPMENT CORP
 PLAT VOLUME 82, PAGE 72
 12/10/04

JOHN D. & KIMIKO SJIMAK
 DOC. NO. 20050050871
 1/14/05

4.0460 ACRES
 4.8675 ACRES COMBINED

9.5843 ACRES
 8.7628 ACRES REMAINDER

SPLIT PARCEL
 0.8215 ACRES

N89°01'38"W

BOARD OF PARK COMMISSIONERS
 LORAIN COUNTY METROPOLITAN PARK DISTRICT
 JAN. 17, 1978
 DEED VOL. 1196, P. 583

- LEGEND**
- IRON PIN, IRON PIPE FOUND
 - IRON PIN SET
 - MONUMENT BOX FOUND

CURVE MARK	CURVE RADIUS	ARC LENGTH	TANGENT LENGTH	CHORD LENGTH	CHORD BEARING	ARC DELTA
8	68.50'	50.00'	26.17'	48.90'	S77°48'50"W	41°49'18"
9	68.50'	50.00'	26.17'	48.90'	S60°21'52"E	41°49'18"

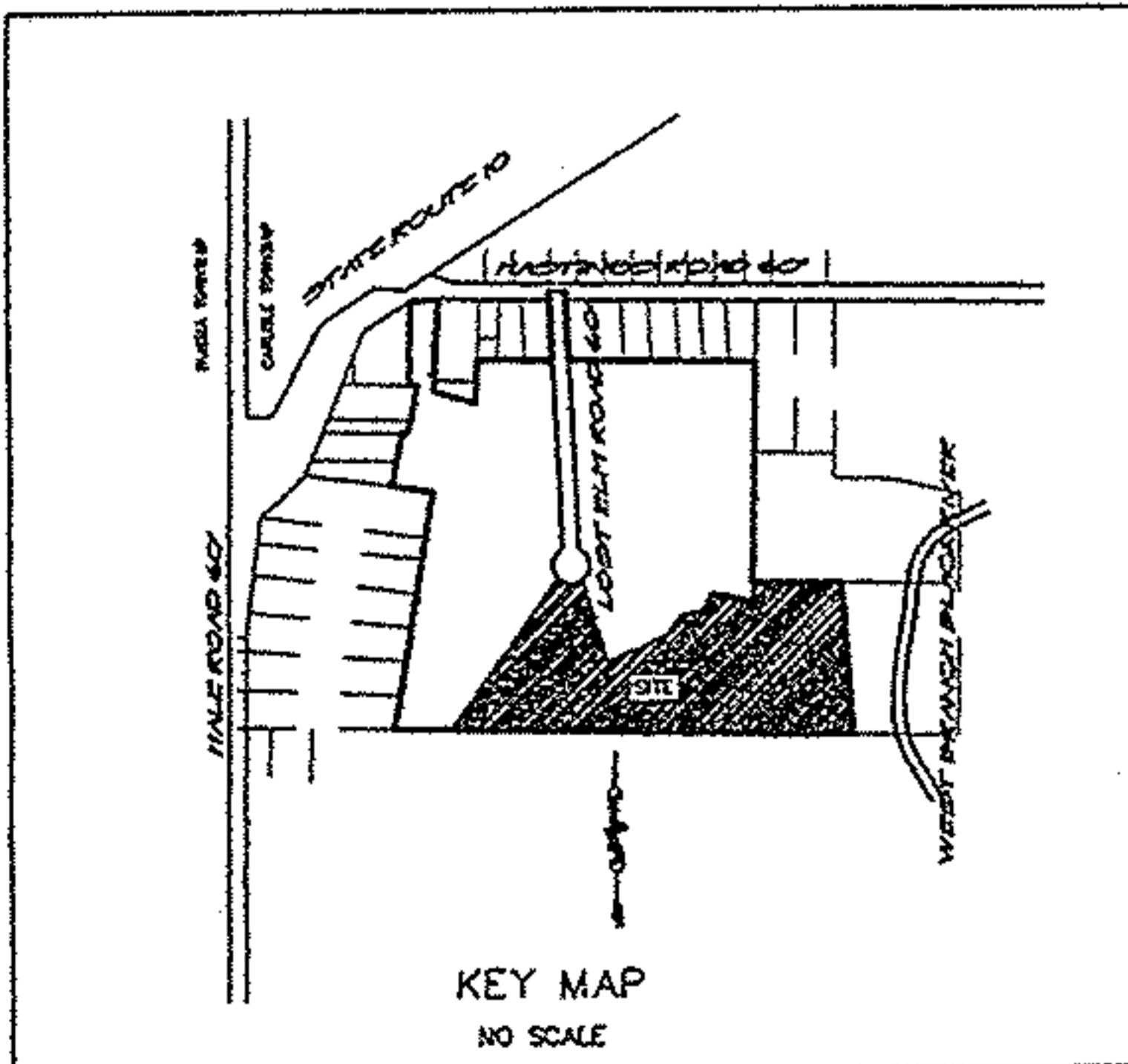
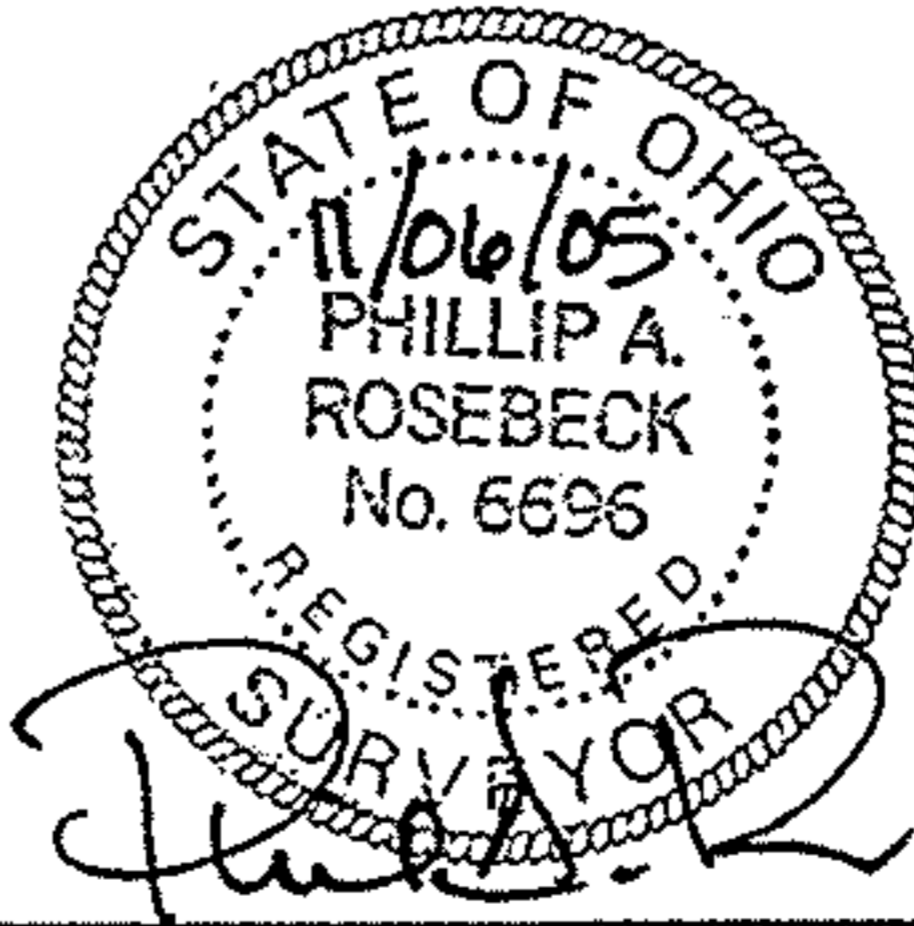
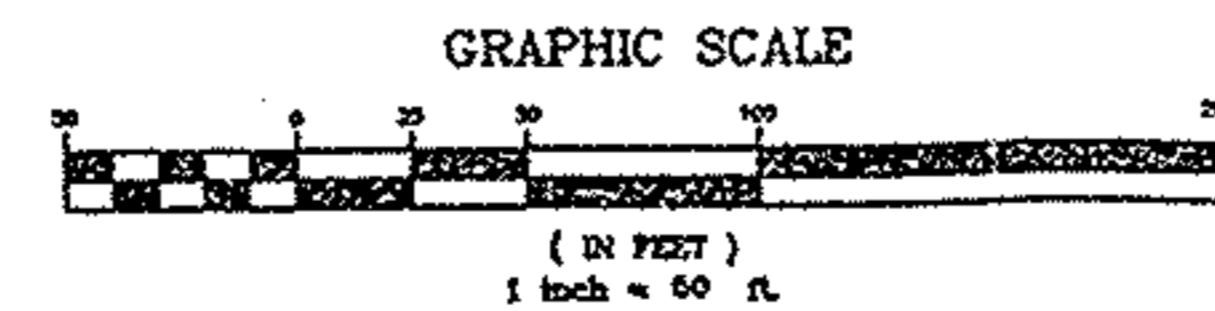

SURVEY
 LOST ELMS DEVELOPMENT CORPORATION
 PART OF ORIGINAL CARLISLE TOWNSHIP SECTION 20,
 LORAIN COUNTY, STATE OF OHIO
 NOVEMBER 6, 2005

NO.	DATE	DESCRIPTION	PAR BY
0	11/07/05	ORIGINAL ISSUE	

P.A. ROSEBECK & ASSOCIATES
 REGISTERED SURVEYOR
 705 WILLOW CREEK DRIVE, AMHERST, OHIO 44001
 PHONE: (440) 988-4657

No 02076

APPROVED
 LORAIN CO.
 MAP DEPT

SHEET
 1
 OF
 2