

# BOUNDARY SURVEY

OF PART OF  
ORIGINAL BROWNHELM TOWNSHIP LOT NO. 26  
TOWNSHIP OF BROWNHELM COUNTY OF LORAIN  
STATE OF OHIO

MAY 21, 1999

## #00321-D

APPROVED  
LORAIN CO.  
MAP DEPT

DATE 3-9-2000

PAGE 1-00-026 AB

BY *[Signature]*

#00321-D

- LEGEND
- PKNAIL FOUND
  - ⊙ RAILROAD SPIKE FOUND
  - ⊙ IRON PIN/PIPE FOUND
  - ⊙ 5/8" CAPPED REBAR SET

100 0 100 200

SCALE IN FEET  
SCALE: 1" = 100'

### WHITTLESEY ROAD (FORMERLY COOPER FOSTER PARK ROAD)

MON. BOX  
FND. & USED

BAUMHART ROAD

N 00°17'00" E  
402.27' CALC.

O.L. 27

O.L. 26

01-00-026-000-023  
MICHAEL J. & KATHLEEN B.  
WHITMORE  
O.R.V. 1378 P. 843

01-00-026-000-043  
ROBERT L. & LINDA L. KELLEY  
INST. #980547846

01-00-026-000-042  
ROBERT L. KELLEY  
INST. #980547847

01-00-026-000-044  
THOMAS S. & KATHRYN DAVIS KIME  
O.R.V. 831 P. 617

01-00-026-000-046  
THE QUEEN  
FAMILY TRUST  
INST. #970490620

01-00-026-000-040  
TERRENCE GEORGE TANSEY, JR.  
O.R.V. 555 P. 931

01-00-026-000-021  
RICHARD P. & JO ANN M.  
MANTINI  
D.V. 1085 P. 206

01-00-026-000-022  
CARL W. & MARY N. WILMS  
D.V. 1369 P. 479

-047  
32.49 AC. ± REC.  
32.5816 AC.

01-00-026-000-047  
CLAYTON W. HITE  
D.V. 1165 P. 160  
PARCEL 2

MON. BOX  
FND. & USED

01-00-039-000-001  
JACK & ELIZABETH FUGE  
INST. #980563260

01-00-039-000-050  
CHARLES E. & MARY K. HAMANN  
O.R.V. 160 P. 236

I.P. FND.  
0.49' N.

01-00-039-000-036  
DONEL SPRENGER  
O.R.V. 201 P. 584

01-00-039-000-038  
MELVIN L. & JANET R. SLACK  
O.R.V. 798 P. 404

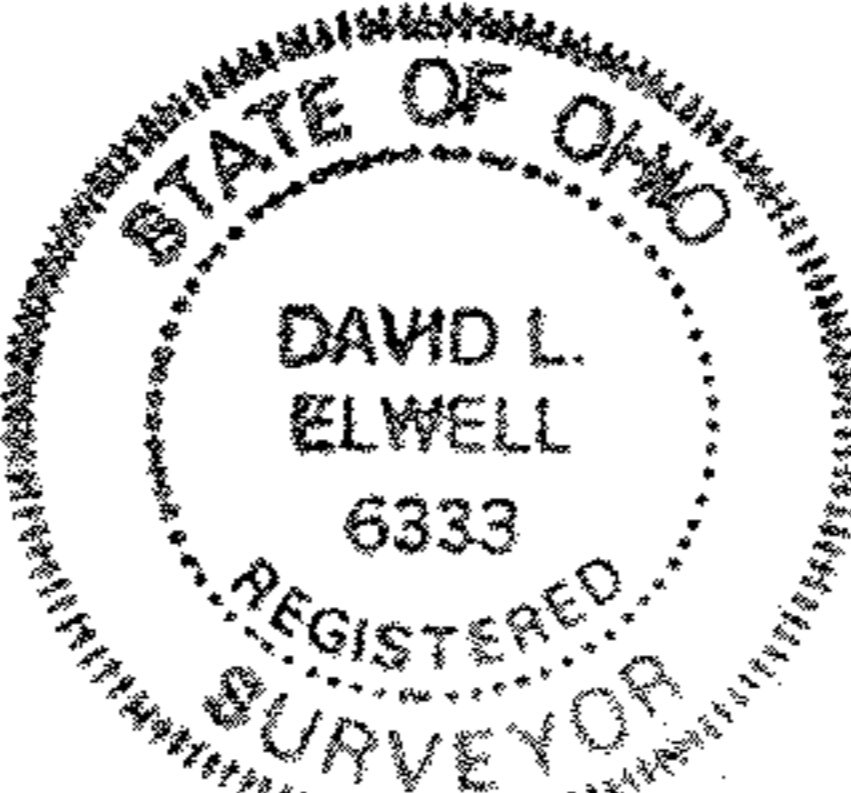

*David L. Elwell*  
DAVID L. ELWELL, REG. SURVEYOR NO. 6333

PREPARED BY:  
**KS ASSOCIATES, INC.**  
ENGINEERS SURVEYORS