

BOUNDARY SURVEY

PART OF GRAFTON TOWNSHIP ORIG. LOT 1
 VILLAGE OF GRAFTON COUNTY OF LORAIN STATE OF OHIO

SCALE: 1" = 60' MAR. 8, 1991
 REV. 3-20-91

PREPARED BY:
KS ASSOCIATES INC.
 ENGINEERS SURVEYORS

David L. Elwell
 DAVID L. ELWELL - REG. SURV. NO. 6333

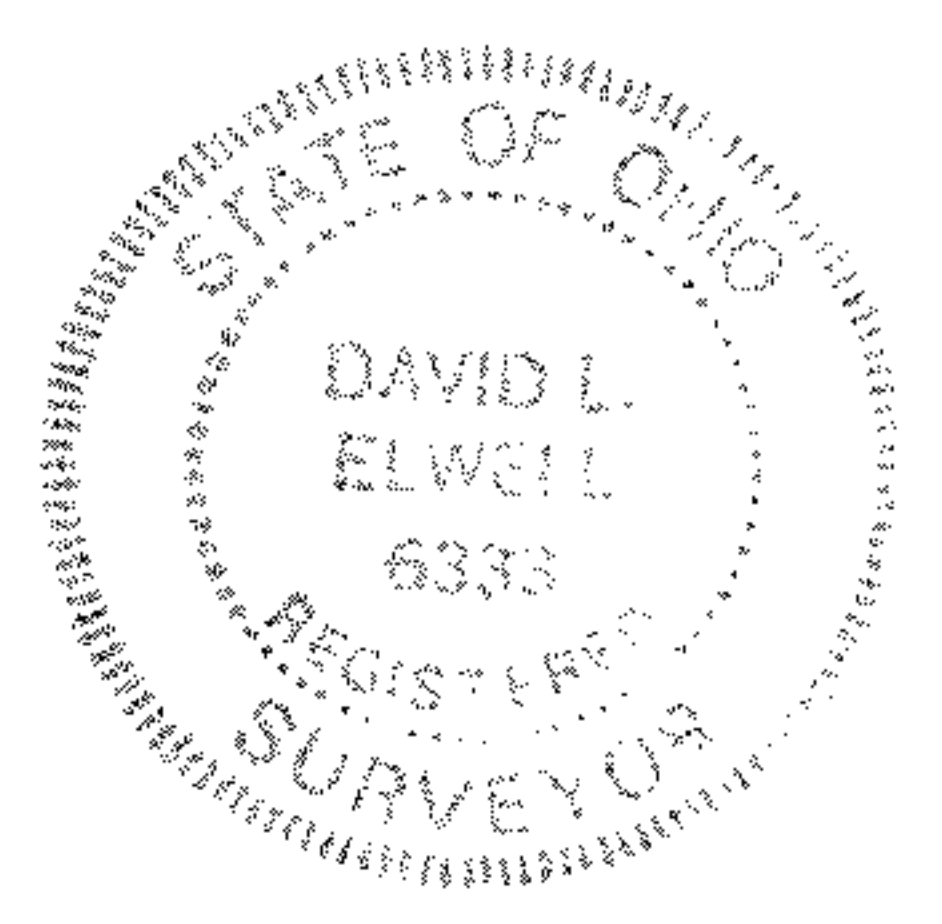

#19392
 APPROVED
 LORAIN CO.
 MAP DEPT.
 DATE 5-28-91
 PAGE 16-00-001-D
 BY CAROLYN FRANCIS
 VOID AFTER # 19392

16-00-001-P-021, 022 # 19392

16-00-001-10-