



LAUNDON . SIMON . CAHL & ASSOC. INC.
 CONSULTING ENGINEERS & SURVEYORS
 219 COURT ST. ELYRIA, OHIO 44035

SURVEY FOR:

JEFFERSON TRUCKING CO.

Orig. Lot 53	City of LORAIN	Date 5-15-89 Scale 1"=100
Orig. Sec	Village of	Dwn. by R. G. S. Chkd. by
Tract	County of LORAIN	Job No. 89-1817 F.B.
Township of SHEFFIELD	State of OHIO	Printed MAY 19

THIS IS TO CERTIFY THAT NO BILLBOARDS
 EXIST ON THE PROPERTY AS SHOWN HEREON

COLORADO AVE.

RODGER G. SIMON
 REG. SURVEYOR NO 5101

#18465

APPROVED
 LORAIN CO.
 MAP DEPT
 DATE 6-1-89
 PAGE 3-00-053 A
 BY CAROL T
 #18465

JEFFERSON TRUCKING CO.
 V.1383 P 544

N. 87° 54' 06" W. 650.00

L.P. SET

L.P. SET

APPROVED BY THE LORAIN CITY PLANNING
 COMMISSION NO PLAT REQUIRED

[Signature]
 SECRETARY LORAIN CITY PLANNING COMMISSION

5.2227 Ac.

APPROVED

AS TO DESCRIPTION ONLY

Date 26-May-1989

Per Patrick A. McDonnon
 City of Lorain
 Engineering Dept.

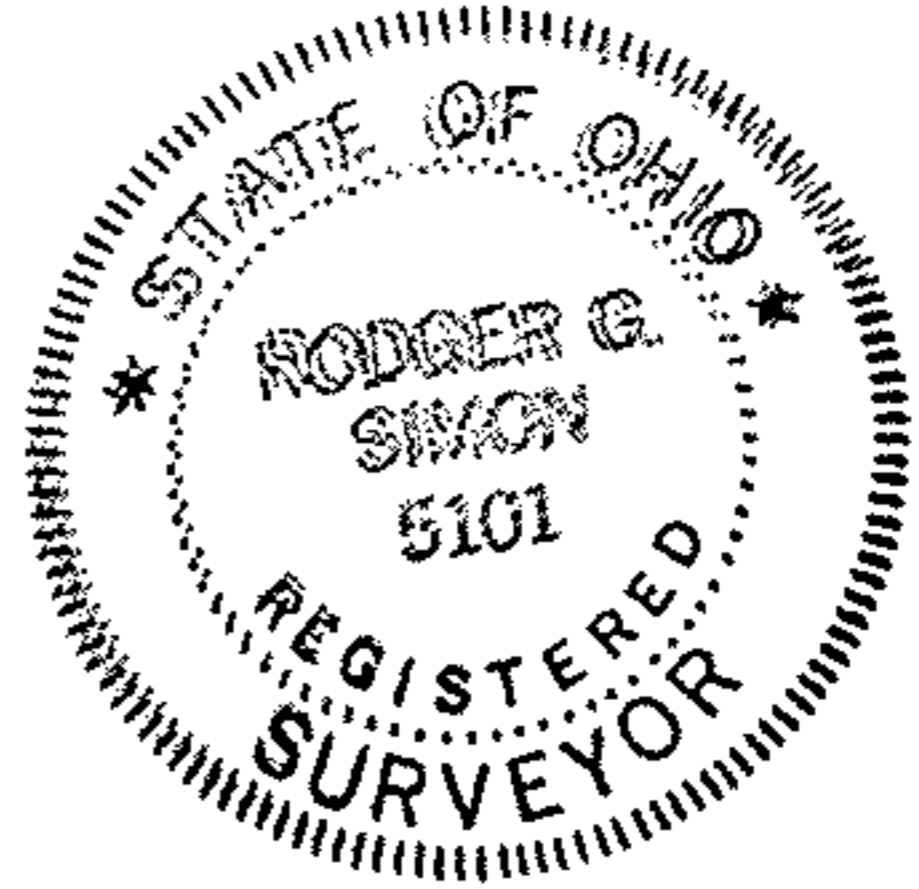

03-00-053-108-027

S. 87° 54' 06" E. 650.00

L.P. SET

L.P. SET

N.Y.C. RR. & N.Y. CHICAGO AND ST. LOUIS RR
 1763 P. 42

027
 18465

400.0'
 KAM PARTNERSHIP
 V.1927 P.408
 614.56
 614.56
 6.2° 07' 35" W. 350.00
 MICHAEL NAPOLI ET AL