

01-00-004-120-047, 036, 038

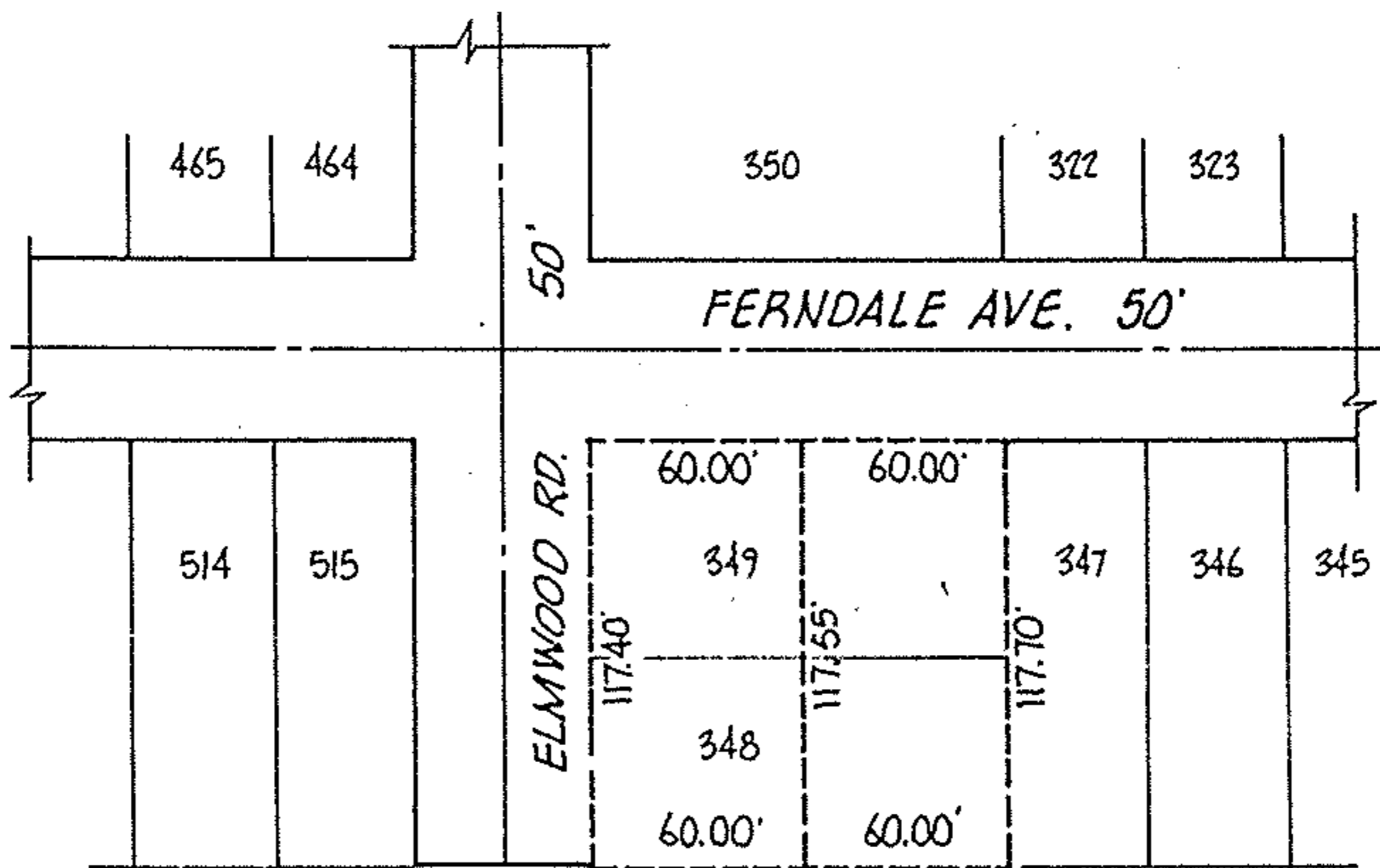
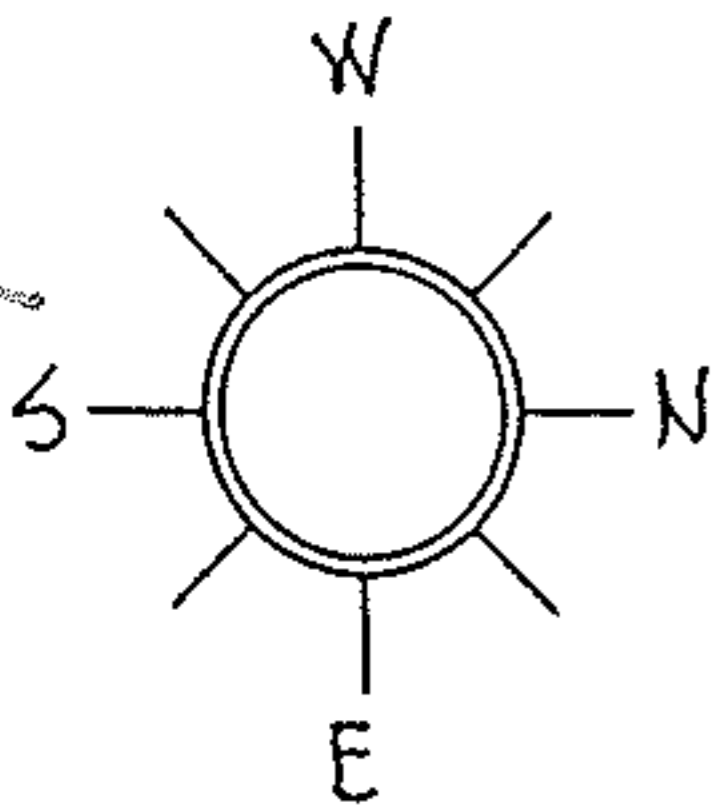

**DESCRIPTION, SOUTHERLY PARCEL;**

SITUATED in the City of Vermilion, County of Lorain and State of Ohio. Being known as parts of sublots 348 and 349 of Sunnyside Beach Allotment as recorded in Volume 12, Page 8 of Plat Records, more definitely described as follows;

Being the southerly sixty (60.00) feet of sublots 348 and 349 of Sunnyside Beach Allotment, forming a parcel of land fronting sixty (60.00) feet on the easterly line of Ferndale Avenue and extending easterly between parallel lines a distance of 117.40 feet along the north line of Elmwood Road and 117.55 feet along the northerly line, be it the same, more or less, but being subject to all legal highways.

**DESCRIPTION, NORTHERLY PARCEL;**

SITUATED in the City of Vermilion, County of Lorain and State of Ohio. Being known as parts of sublots 348 and 349 of Sunnyside Beach Allotment as recorded in Volume 12, Page 8 of Plat Records, more definitely described as follows;

Being the Northerly sixty (60.00) feet of sublots 348 and 349 of Sunnyside Beach Allotment, forming a parcel of land fronting sixty (60.00) feet on the easterly line of Ferndale Avenue and extending easterly between parallel lines a distance of 117.55 feet on its southerly line and 117.40 feet on its northerly line, be it the same, more or less, but being subject to all legal highways.

*MGH*

ACREAGE	—
DATE	NOV-91
DRAWN	MGH
SCALE	1" = 80 ft.

PREPARED FOR WINTERSTEIN

MICHAEL G. HURA, registered surveyor.  
12706 MASON RD., VERMILION, O., Ph(216) 965 4040

**PARCEL SPLIT APPROVAL**

SUBLOT(s) 348 & 349 of SUNNYSIDE BEACH ALLOTMENT  
Volume 12 Page 8 of PLATS  
PART OF O.L. \_\_\_\_\_ TRACT \_\_\_\_\_ SECTION \_\_\_\_\_ OF  
BROWNHELM TOWNSHIP LORAIN CO., OHIO  
PERMANENT PARCEL N<sup>o</sup> \_\_\_\_\_



CITY OF VERMILION