

PARCEL: 07-00-027-109-043

PARCEL: 07-00-027-109-050, -051

NO. 00120

STARTING POINT:

INTERSECTION OF C/L OF AVON-BELDEN RD.(S.R.83) AND C/L OF SUGAR RIDGE RD.

-050
0.04 A.

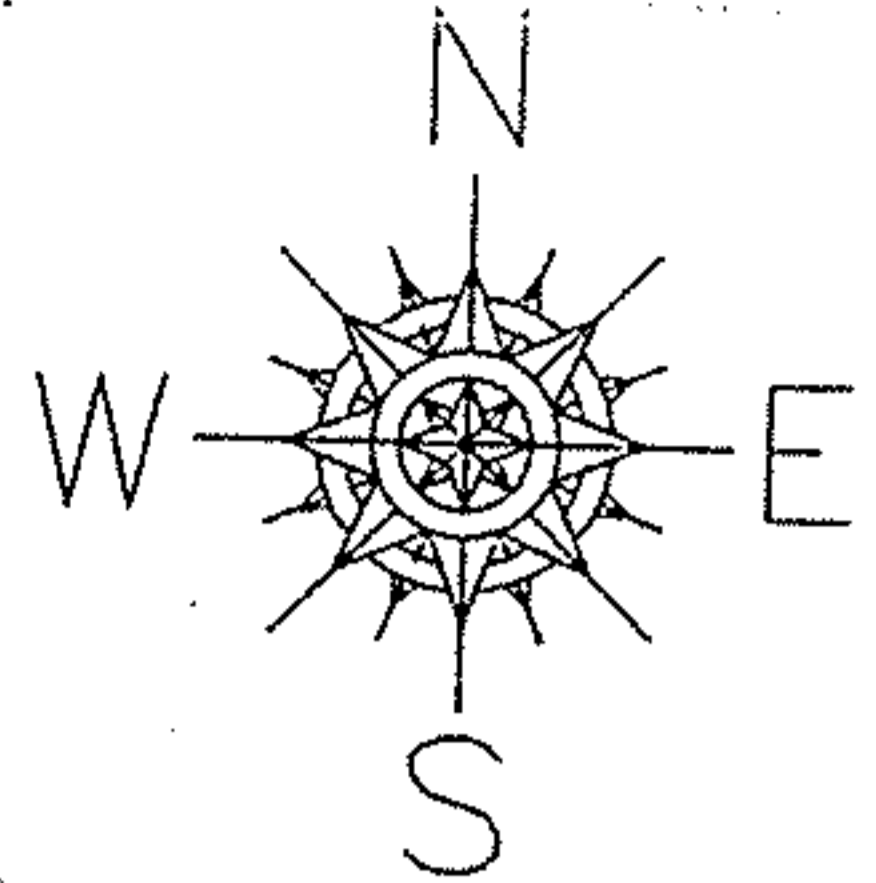
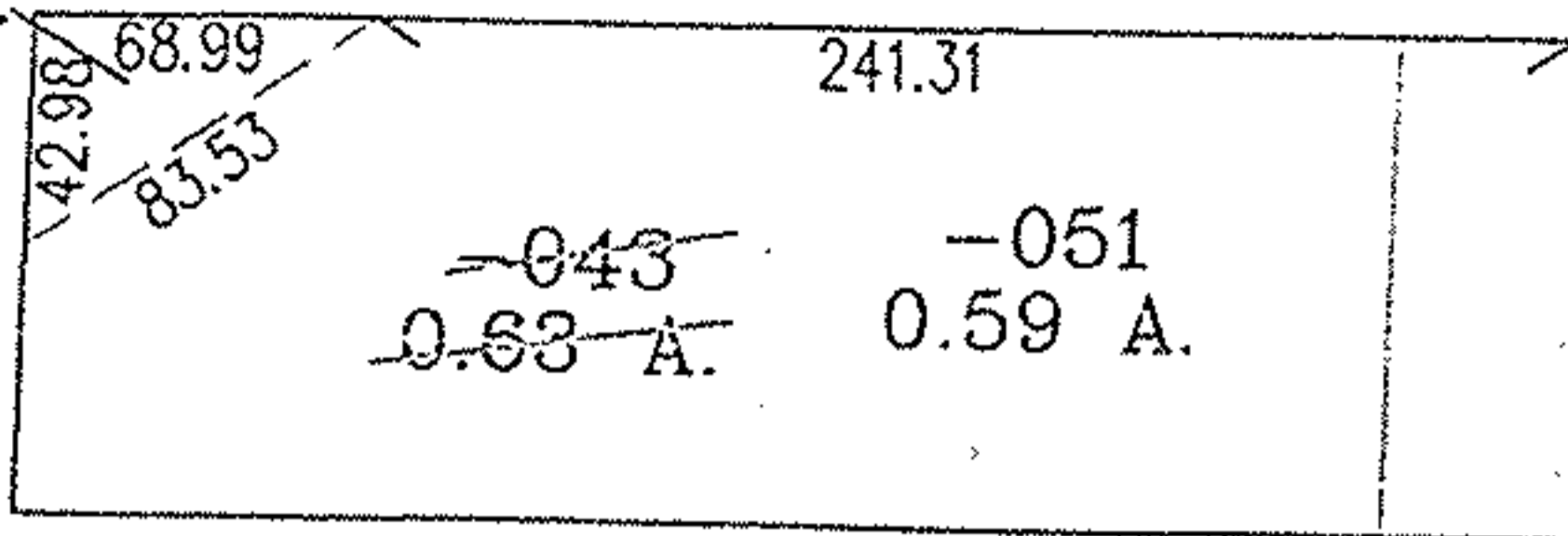

578.62

AVON-BELDEN RD.(S.R.83)

1788.79

SUGAR RIDGE RD.

SPLITS/DEEDS PROCESSED

LORAIN COUNTY TAX MAP DEPARTMENT
226 MIDDLE AVE. ELYRIA, OHIO

SURVEYED BY: ROBERT J. MCAULEY

CLOSURE: .00:10.000

MAP PAGE(S): 7-00-027-0

APPROVED BY: RRM DATE: 8-31-04

SCALE: 1" = 100 PRIOR INSTRUMENT: 970481622