

OR 33 Pg 66
John G &
Dorothy Thompson

OR 33 Pg 66
John G & Dorothy K Thompson

(A)
Jerry C & Helen L
Rader
OR 691 Pg 212

Helen L Rader Etal
980564999

Indian Hollow Rd
N 8°19'40"E
202.40'

(000)

300.00'

(A)

331.08'
N 89°29'40"E
2,506 Acres

Barn - 0/8

307.51'

S 0°30'20"E

Helen L Rader Etal
980564999

OL 32

OL 31

Helen L Rader Etal

Walkden

N 8°19'40"E
340.30'

Helen L Rader Etal
20010828090

No 01696

APPROVED
LORAIN CO.
MAP DEPT

DATE 7-6-04

PAGE 15-00-032-B

BY JHaffield

#04-01696

Monument box
Iron pin set

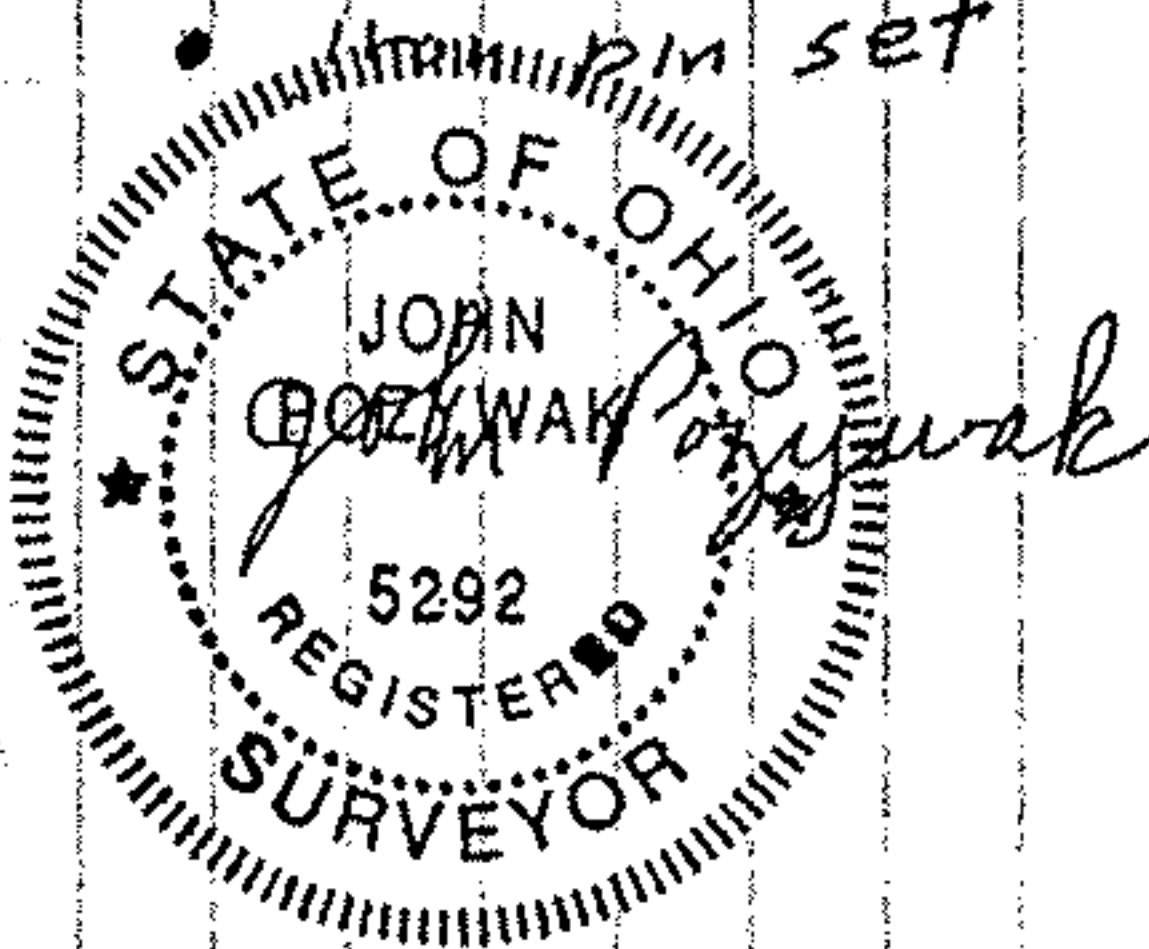

Survey of Parcel Split
for Jerry Rader
Part of Original Lot 32
La Grange Township
Lorain County Ohio
Scale 1"=200' May 2003

