



LAUNDON • SIMON • CAHL & ASSOC., INC.
 PROFESSIONAL LAND SURVEYORS
 110 MIDDLE AVE., ELYRIA, O. 44035

SURVEY FOR:
 BARBARA B. MUSOLF

Orig. Lot No. 84	City of	Date 4-17-98	Scale 1" = 150'
Orig. Sec No.	Village of	Dwn. by R.G.S.	Chkd. by R.C.
Tract	County of LORAIN	Job No. 98-3037	F.B. 244/A
Township of AMHERST	State of Ohio	Printed	



-003
 -004
 RMDR. 68.77 Ac. Calc.

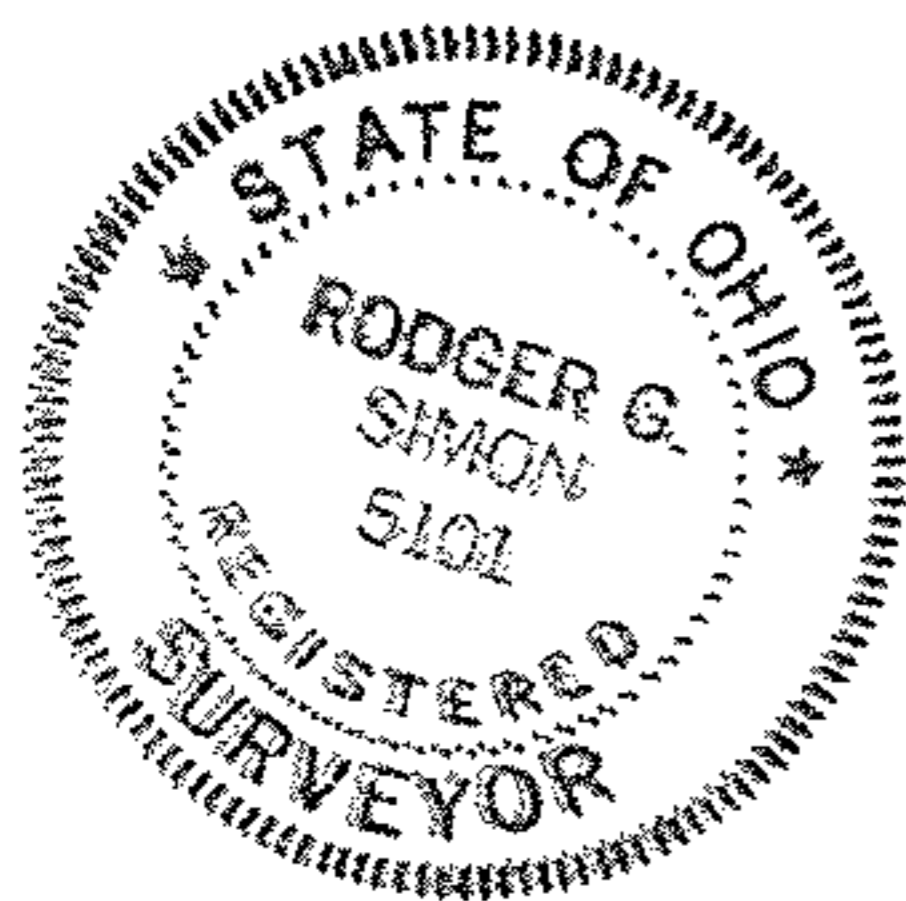

I.P. Set

I.P. Set

MON./I.P. Used

5.2°06'15"W. 775.00'

N.87°59'45"W.
 350.00'

PARCEL
 4
 OF BIGGER
 SURVEY
 - 002
 6.23 A
 6.2270 Ac.

2202.97' m.
 WEST RIDGE RD. 60
 N.2°06'15"E.

22553

APPROVED
LORAIN CO.
MAP DEPT.
DATE 6-4-98
PAGE 5-D
BY J. HATFIELD
VOID AFTER 22553

I.P. Fd. - Used

I.P. Set

S.87°59'45"E. 3379.94' m.,
 STANG RD. 60

MON./I.P. Used

05-00-084-000-002