

CONRAIL R.R. R.O.W

S 76° 59' 35" E 474.96'

THE CLEVELAND QUARRIES COMPANY - PARCEL No. 1 - D.V. 751, PG. 601  
65.30 MEAS.  
N 5° 51' 25" E 98.35'  
I.P. SET  
P.K. 6ET

-081  
1.708 AC.

QUARRY ROAD (AS OCCUPIED)  
N 62° 07' 30" W 141.36'  
N 57° 32' 30" W 100.00'  
N 46° 38' 30" W 100.00'

KAMM, JACOB O. - TRUSTEE  
-024

GODFREY DEVELOPMENT CORP.  
O.R. VOL. 161, PG. 211 (PARCEL #2)  
-080

MILLER, JOEL P. & MARCIA M.  
-072

I.P. Pd.  
(IN PAVEMENT)

N 29° 23' 30" W 50.00'  
N 10° 01' 30" W 49.40'

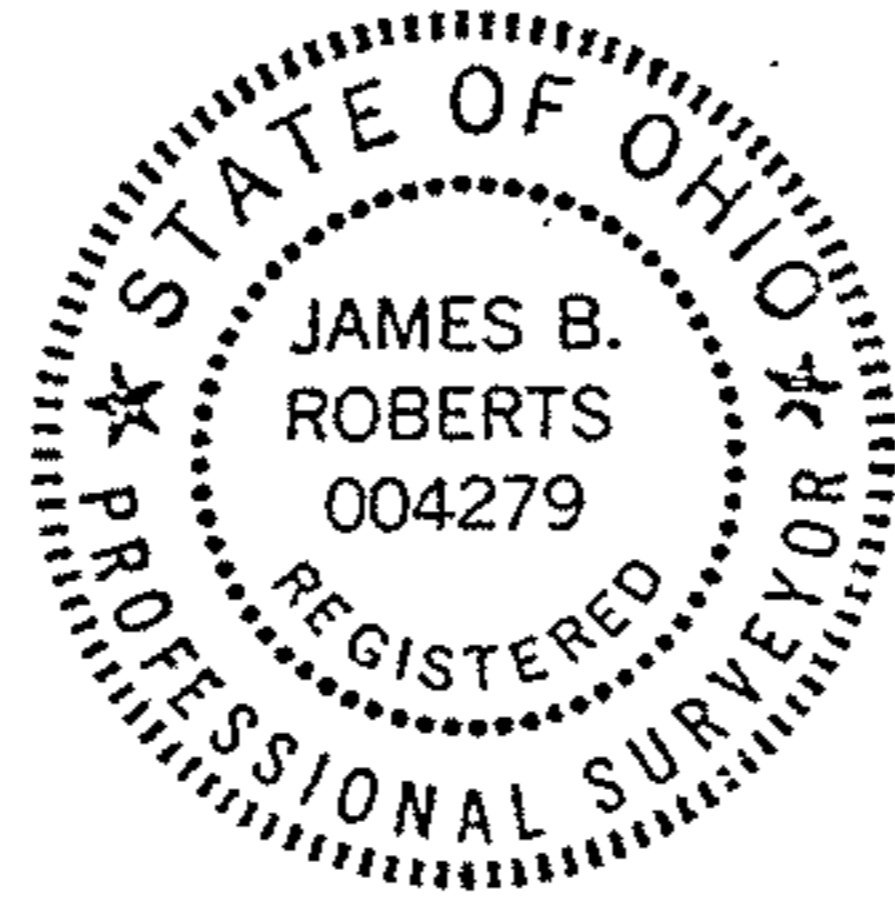

SCALE: 1" = 60'

MAP of PROPOSED PARCEL SPLIT  
PREPARED FOR: HENRY LESLIE  
PART of ORIGINAL AMHERST TWP. LOT No. 98  
CITY of AMHERST, LORAIN COUNTY, OHIO

REF: SPLIT-OUT OF 05-00-098-000-021

#18645

APPROVED  
LORAIN CO.

K.E. McCARTNEY & ASSOCIATES

ENGINEERS & SURVEYORS 9-22-89

ELYZIA,  
AUGUST, 1989

OHIO 5-00-098-C  
# 892725

BY CAROL FRANCIS

VOID AFTER # 18645