

12-00-074-000-025

LOT SPLIT

SURVEY FOR

JOHN & LYNDA FETCHET

BEING PART OF

ORIGINAL COLUMBIA TWP. LOT No. 74
COUNTY OF LORAIN, STATE OF OHIO

DEC. 9, 1997

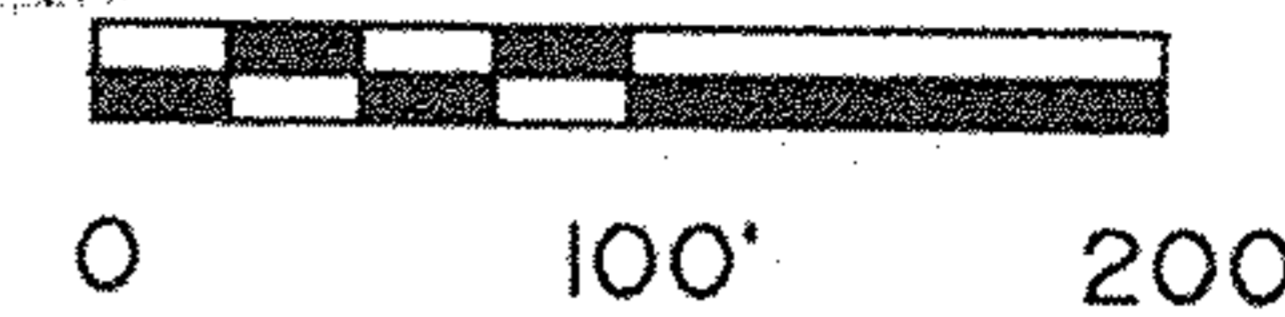

DATE OF SURVEY
MAP PAGE

I HEREBY STATE THAT THIS IS A TRUE AND ACCURATE REPRESENTATION OF THE PREMISES SHOWN HEREON AND THAT IT WAS DONE IN ACCORDANCE WITH THE MINIMUM STANDARDS FOR BOUNDARY SURVEYS IN THE STATE OF OHIO AS ADOPTED IN THE ADMINISTRATIVE CODE CHAPTER 4733-37, ALL TO THE BEST OF MY KNOWLEDGE AND PERSONAL BELIEFS.
ALL COURSES ARE GIVEN TO AN ASSUMED MERIDIAN.

BY *James B. Root*

JAMES B. ROOT
REG. SURVEYOR No. 5045
200 ELLEN DR., BEREA, OHIO 44017
440-243-9843

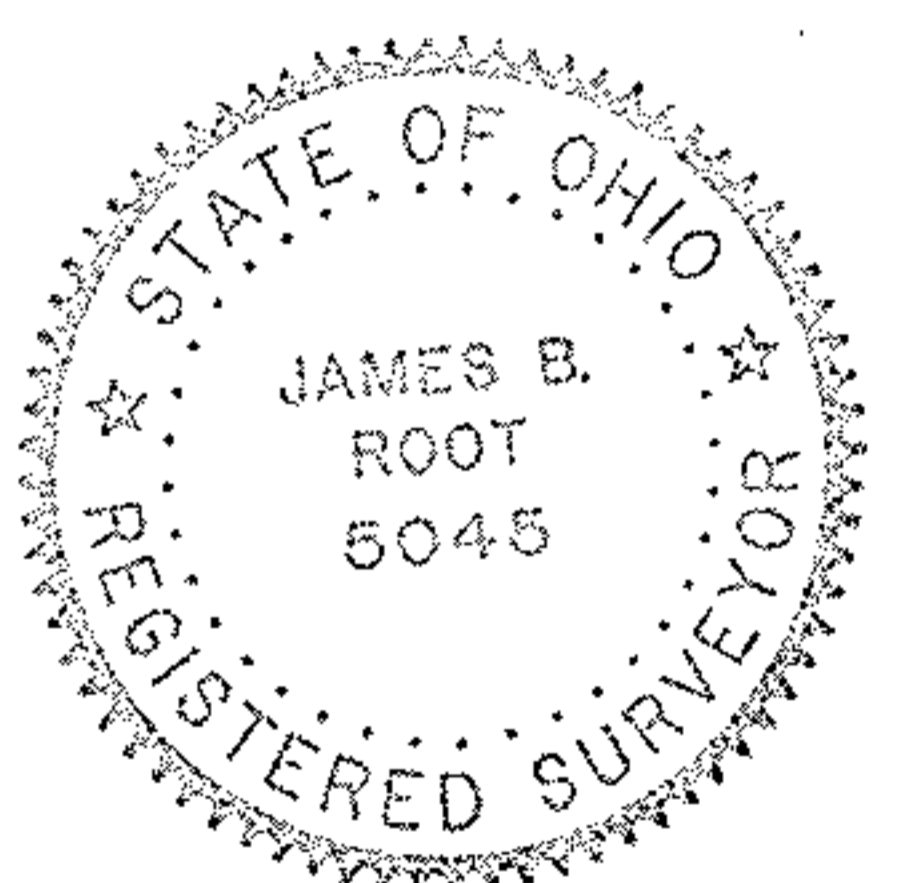

CIP - 5/8" CAPPED IRON PIN SET

BLACKMORE GRAIN & CATTLE Co.
VOL. 1314, PG. 093
PARCEL 3
12-00-074-000-025

rem.
-027

#22418

APPROVED LORAIN CO. MAP DEPT
DATE 1/23/98
PAGE 12-E
BY K. COBERT

OL 74
OL 73



OL 87
OL 74

STATION RD. 60'
1053.60' ACT.

N 57° 57' 00" E
403.60' DEED & ACT.

JOHN C. & LYNDA H. FETCHET
O.R. VOL. 1299, PG. 071
12-00-074-000-024
N 32° 03' 00" W
375.00' TO E

-026
3.444 AC.

150.00'
5/8" CIP SET

5/8" CIP SET

HSE. # 15617

5/8" CIP SET

N 32° 03' 00" W
375.00' TO E

5/8" CIP SET

400.00'

150.00'
HSE. # 15711

30'
3/4" PIPE FD.

3/4" PIPE FD.

15' EASEMENT N 85° 58' 22" E 743'

3/4" PIPE FD.

3/4" PIPE FD.

N 57° 57' 00" E

3/4" PIPE FD.

3/4" PIPE FD.

3/4" PIPE FD.

3/4" PIPE FD.

3/4" PIPE FD.

3/4" PIPE FD.

3/4" PIPE FD.

3/4" PIPE FD.

3/4" PIPE FD.

3/4" PIPE FD.

3/4" PIPE FD.

3/4" PIPE FD.

3/4" PIPE FD.

(4.8' SW)
OLD 1/2" IP FD.

5/8" IP USED

5/8" IP USED

100.00'

1075.60' DEED
400.00'

1493' OBS.
1497.3' OBS.

1490.00' DEED