

D. Vol 1192 Pg 801

Ralph & Mary Holdway

OL 53

OL 68

223.32'

N 29°-45' E

361.20'

30.83'

MB

Marvin & Joanne

Anderson

D. Vol 1379

Pg 124

-034

S 291.90

S 80° 38' 30" E

68.20

N 9° 36' 30" E

48.44'

S 76° 02' 30" E
(2.968 Ac.)

4.001 Acres Total

2.968 Ac OL 69

+1.033 Ac OL 68

4.001 Ac TOTAL

-053

N 88° 54' W 556.70'

2401.00'

Hollow Rd

S 130-23' 30" W

N

Lester Ebosh

N 90° 51' 30" E
400.34'

(1.033 Ac)

OL 68

OL 69

30.847 Acres
Remainder
-001

-016
1.653 Ac
Remainder

Lester Ebosh
2.159 Acres
Remainder
-035

1.003
2.968
3.971

- Iron pipes fd
- Iron pipes set

1.65
2.16
3.81

OL 68 1.033 Acres
OL 69 2.968 Acres
Total 4.001 Acres

3.01
+2.93
5.94
-2.97
2.97

John Poznywak
Reg. Surveyor
5292

Survey for Lester Ebosh
4.00 Acres split
Part of Original Lot 68 & 69
La Grange Township
Lorain County, Ohio
Scale 1" = 100' Nov, 1990

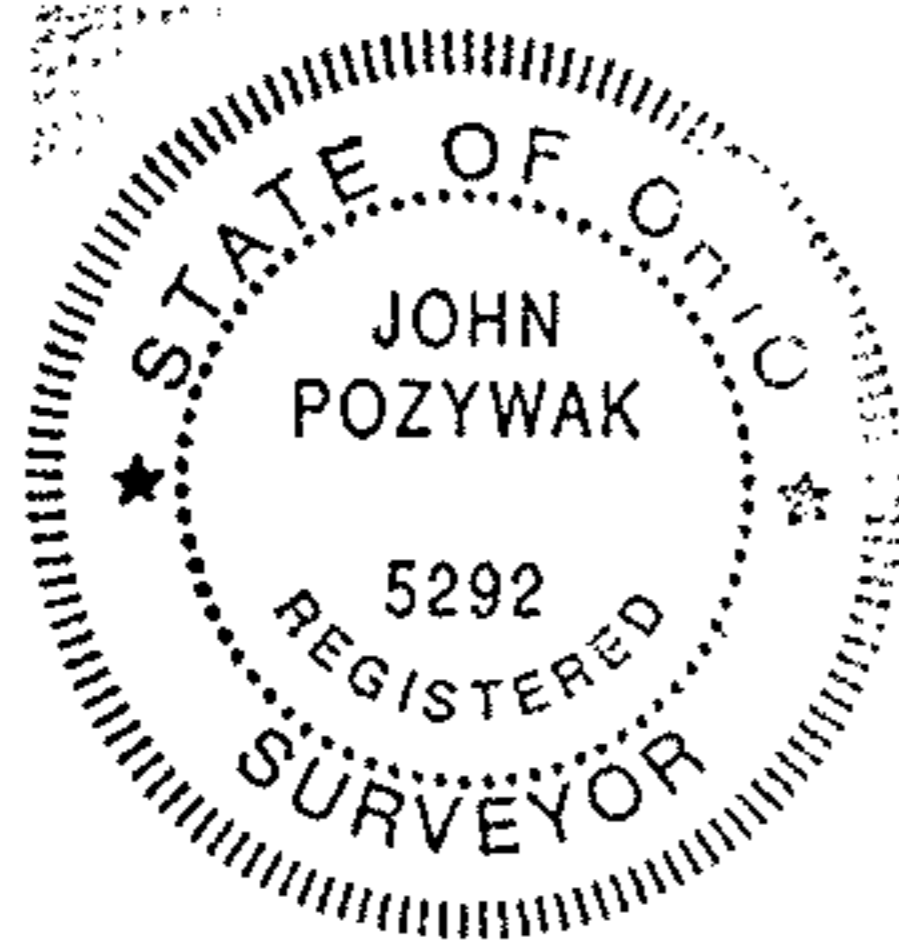

See Pgs 8 Pg 21
1377

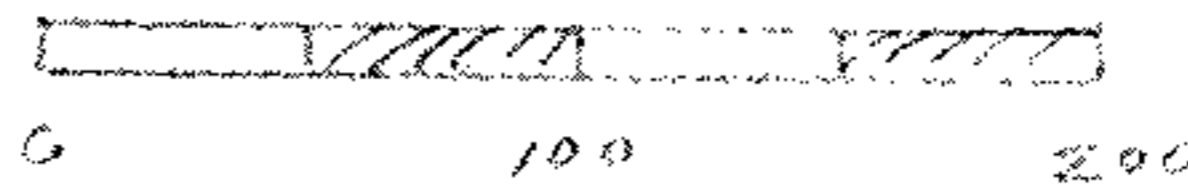

P.P. NO. 15-00-068-000- 068-000-034, 053	
SPLIT # 19897 [Signature]	DATE OF SURVEY
MAP PAGE 15-H	
SURVEYOR JOHN. POZYWAK	