

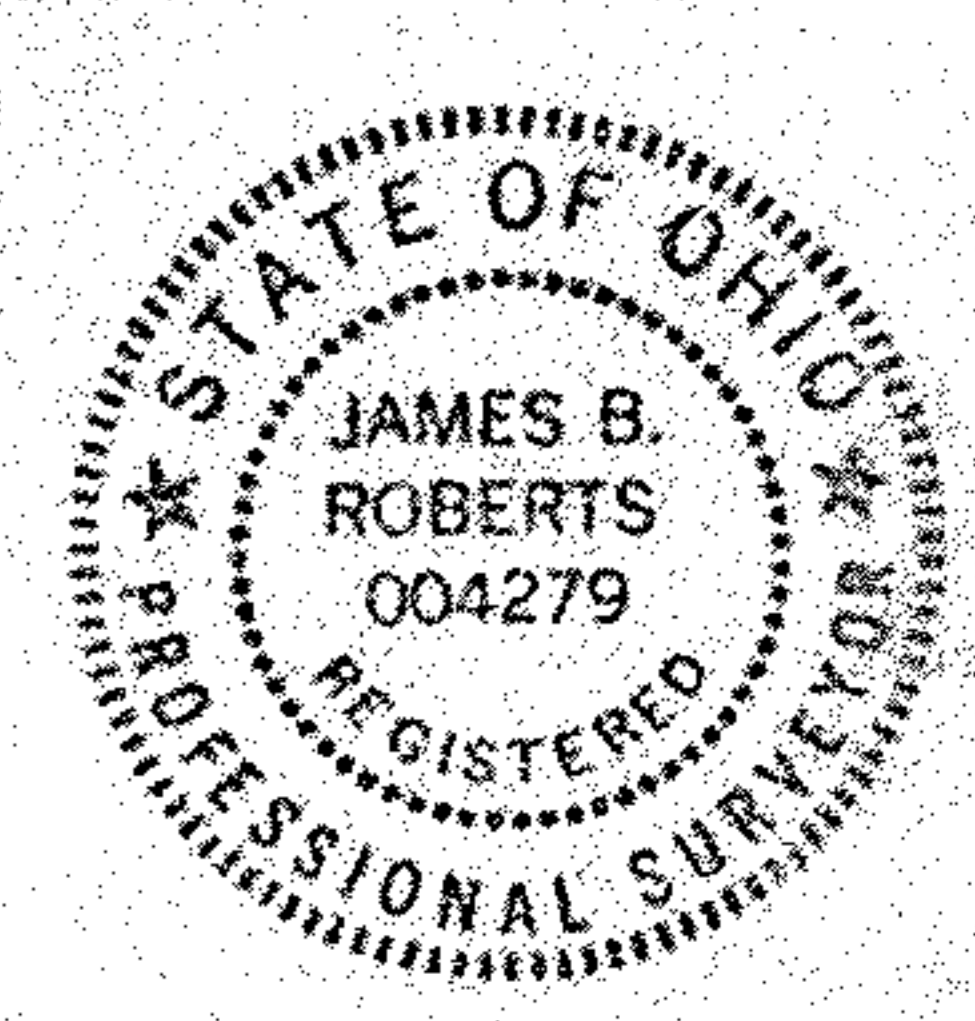

SCALE: 1"=50'

NOTE: DEPTHS OF SUBLOTS ON NORTH SIDE OF WEST MARTIN STREET EXCEED PLATTED DIMS. BASED ON EXISTING MONUMENTATION NOTED HEREON.



#18551-A

APPROVED	
LORAIN CO. MAP DEPT.	
DATE 7-28-89	
PAGE 5-00-018-B	
BY T. McMain	
VOID AFTER	18551-A

05-00-018-104-037, 038, 039, 041, 042, 043

MAP of BOUNDARY SURVEY
 PREPARED FOR MIDLAND TITLE SECURITY INC.
 PARTS OF SUBLOT NOS. 463 & 464 OF GEORGE
 ASHENBACH'S ADDITIONAL TOWN PLAT OF NORTH AMHERST - PLAT VOL. 2, PG. 10
 PART OF ORIGINAL AMHERST TOWNSHIP LOT No. 23
 NOW IN CITY OF AMHERST, LORAIN COUNTY, OHIO

K.E. MCCARTNEY & ASSOCIATES
 PROFESSIONAL ENGINEERS & SURVEYORS
 ELIZA, OHIO
 JULY, 1989 #892701