

Adam Subdivision

06-23-027-101-036,035

06-23-027-101-

⑨ outdoor Graphics Inc

149.94°
155.55'
155.55'

0.534 Ac
0-036
149.09

N 89°46'E 25.03 Hurd Drive
25.03 N 89°46'E

20260

APPROVED
LORAIN CO.
MAP DEPT.

DATE 2-18-93

PAGE 6-27

CAROLYN
BY FRANCIS

VOID # 20260
AFTER



20260

Robert P. Graham

752.23'

N 2°12'E 596.68'

2.018 Acres
Outdoor Graphics Inc

035

596.83

West line of
All't Billy & Glenna
Morrow

S 2°31'W
Schaden's All't
P. Vol 7 P. 19

Schaden's All't
P. Vol 7 P. 19

Survey of a parcel split
Original Lot 13
Brace Tract
Elyria Township
Lorain County Ohio
Scale 1"=100' Jan 20, 93

0.13
0.15

145.78'
S 89°46'W

John Pozzywak
Reg Surveyor
5292

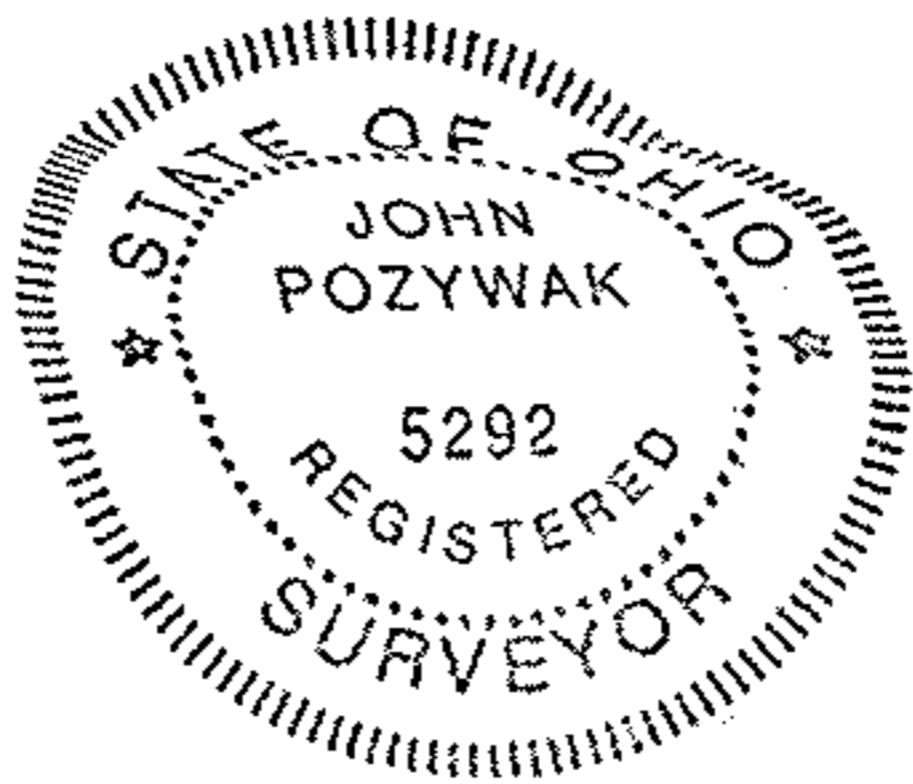

- x PK nail
- iron pipes fd
- o iron pipes set
- Ⓢ subplot numbers

6-27