

De-22-007-000-098

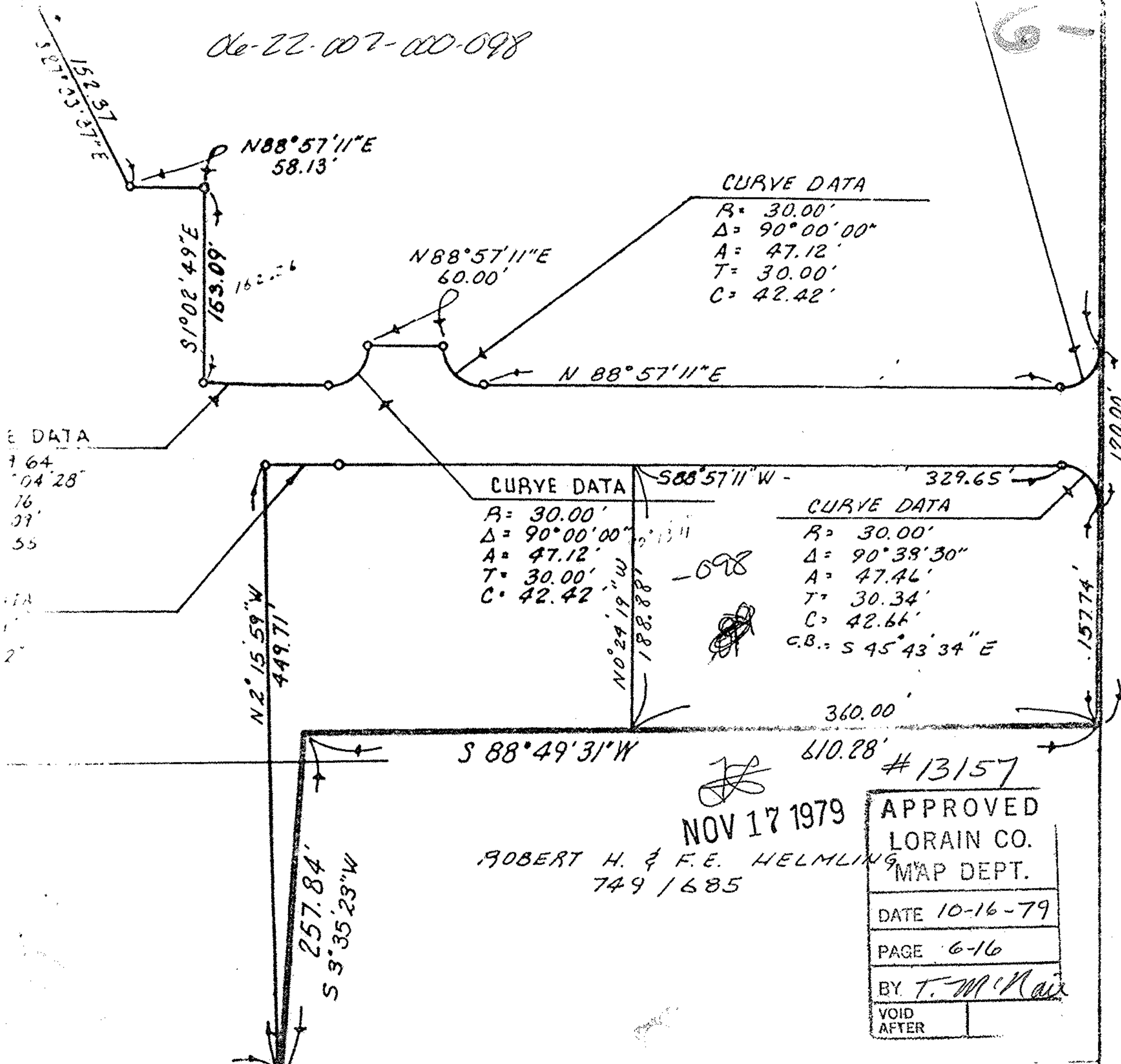

CURVE DATA

$R = 30.00'$
 $\Delta = 90^{\circ}00'00''$
 $A = 47.12'$
 $T = 30.00'$
 $C = 42.42'$

CURVE DATA

$R = 30.00'$
 $\Delta = 90^{\circ}00'00''$
 $A = 47.12'$
 $T = 30.00'$
 $C = 42.42'$

CURVE DATA

$R = 30.00'$
 $\Delta = 90^{\circ}38'30''$
 $A = 47.46'$
 $T = 30.34'$
 $C = 42.66'$
 $C.B. = S 45^{\circ}43'34'' E$

E DATA
 164
 04'28"
 76
 09'
 55

6-1-007

S 0° 24' 19" E

ABBE

NOV 17 1979
 ROBERT H. & F.E. HELMLING
 749 / 685

#13157
 APPROVED
 LORAIN CO.
 MAP DEPT.
 DATE 10-16-79
 PAGE 6-16
 BY T. M. Kair
 VOID AFTER