

MORTGAGE LOAN IDENTIFICATION

ALL of 5/L 3 & WLY. 3.00' of 5/L 4 in JENNIE BEHM'S SUBN N#1
 PV. 16 P 27A

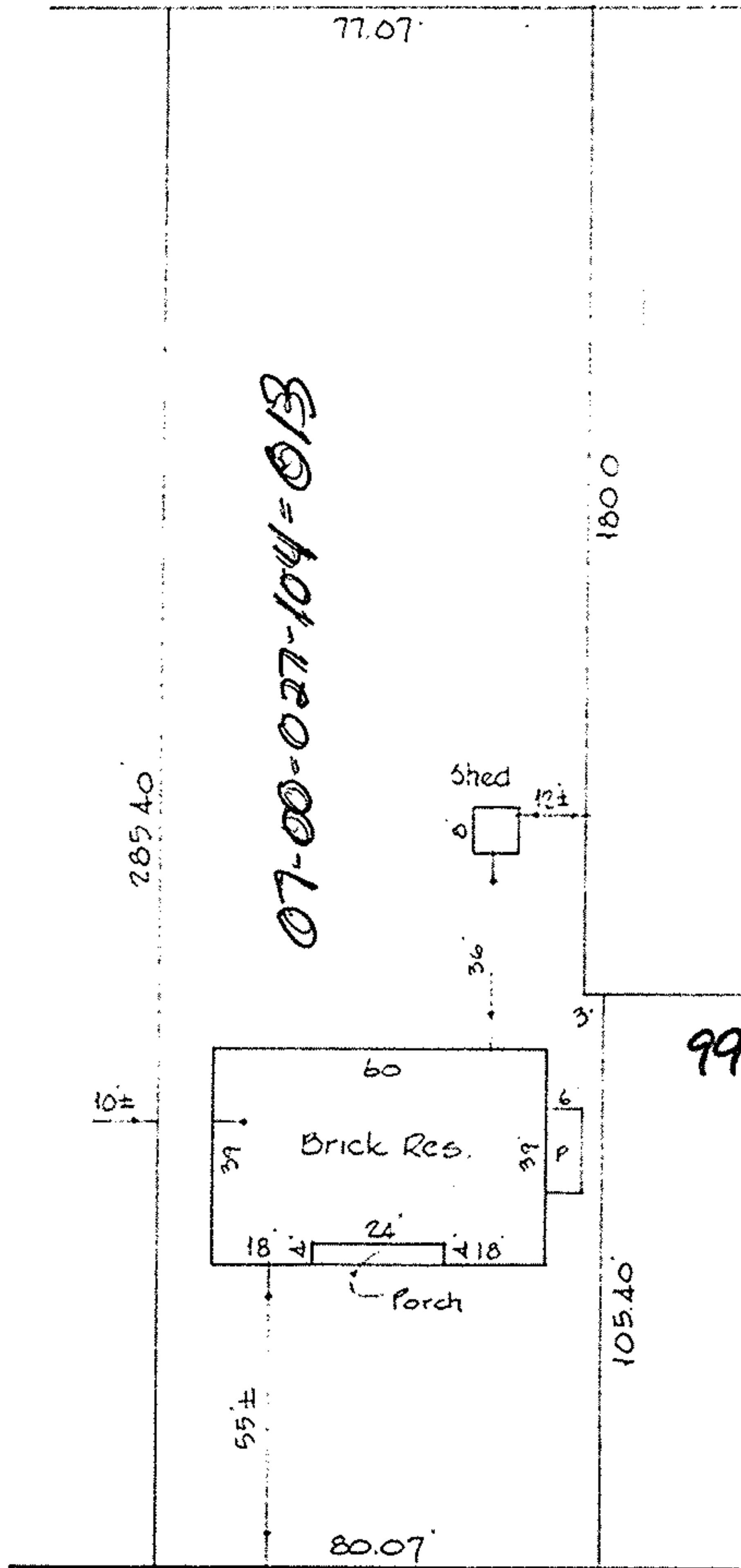
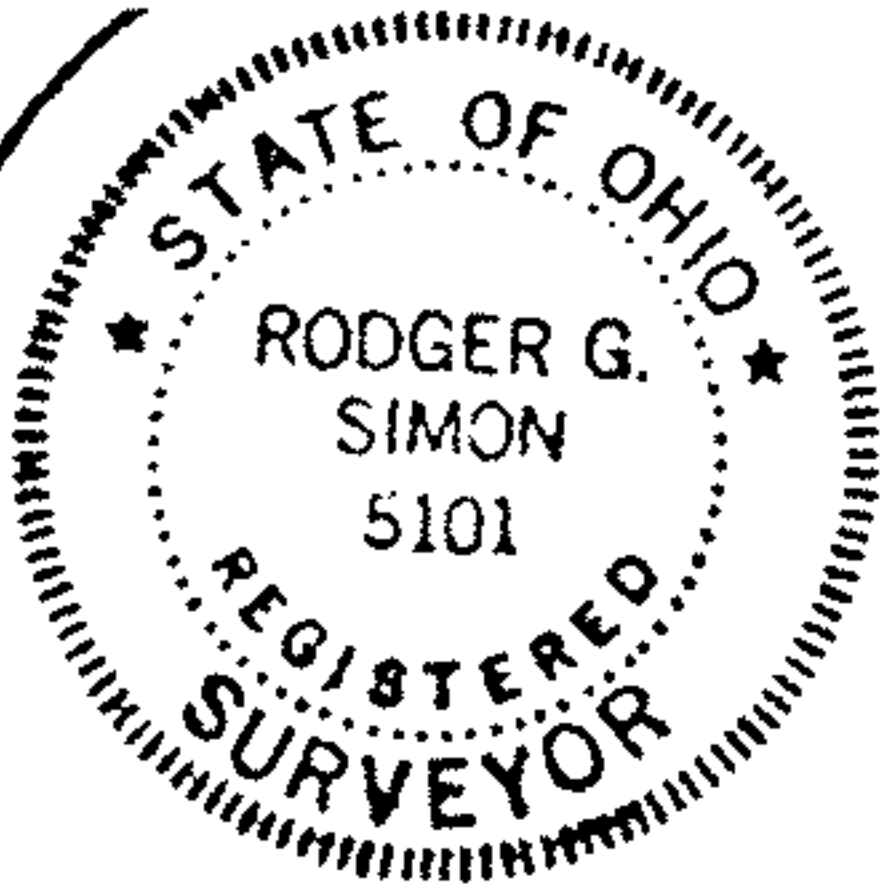

99 #00163-X

APPROVED
LORAIN CO.
MAP DEPT.
DATE 8-16-99
PAGE 7-00-027-B
BY T. Spillman
VOID CAPTION 99 00163-X

AURENSEN DR. 60'

Rodger Simon



LAUNDON . SIMON . CAHL & ASSOC. INC.
 CONSULTING ENGINEERS & SURVEYORS
 219 COURT ST. ELYRIA, OHIO 44035

SCALE 1" = 40' DATE 8-19-87
 FOR MORTGAGE PURPOSES ONLY
 NOT A PLAT OF SURVEY