

Split No. 14285

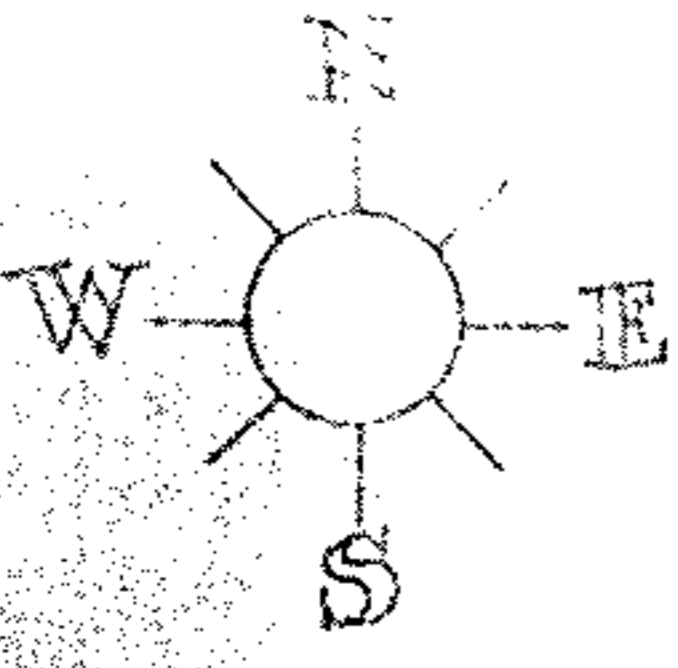

MARY IVES
922 41 V. 313, 614

TR. 13 OL 1
TR. 13 OL 20

IRON PIN SET

N 86° 42' W 344.01'

IRON PIN FOUND

N 86° 42' W
181.59'

- 026
3.11 ACRES

N 88° 33' W
181.50'

N 88° 33' W
181.50'

N 88° 33' W
181.50'

19.70'

19.470'

19.70'

120.00'

19.70'

120.00'

19.70'

N 107° 17' E

GORE-ORPHANAGE RD.

APPROVED
LORAIN CO.
MAP DEPT.
DATE 7-10-81
PAGE B-E
BY T. McMan
VOID AFTER

PERIMETER SURVEY
perm. parcel
acreage 3.11

MICHAEL G. HURA & ASSOCIATES
3409 LIBERTY AVE. VERMILION, OHIO

drawn FAZ
date 4-20-81
scale 1" = 100 ft

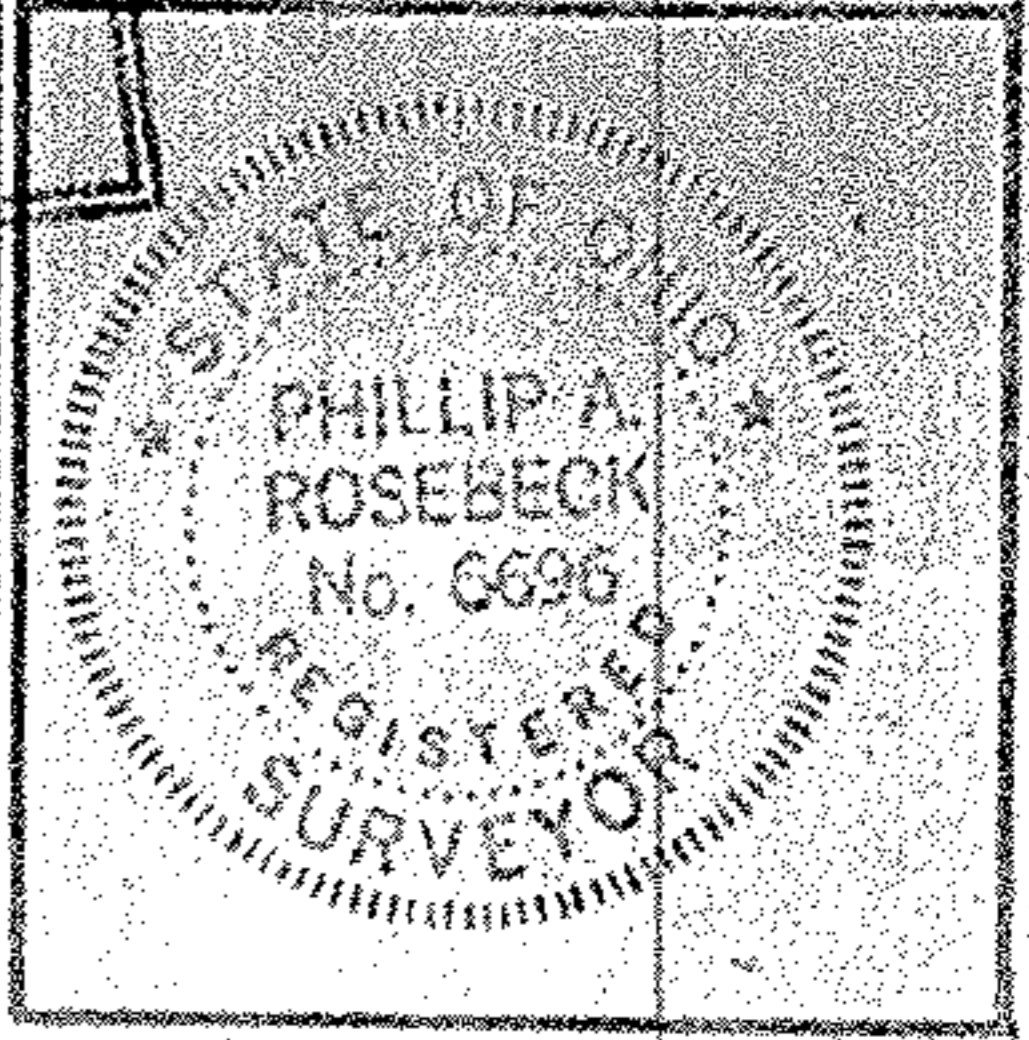

SUBLOT _____ of _____
as recorded in Plat Vol. _____ Page _____

PART of Original Lot 20, Tract 13 Section _____ of _____
Township LORAIN County _____ OHIO

#14285
8-E
08-13-020-000-026