

LAUNDON - HUFFMAN - SIMON  
 CIVIL ENGINEERS - SURVEYORS  
 200 ROBINSON BUILDING ANNEX  
 401 W. BROAD ST. ELYRIA, OHIO

THOMAS W. LAUNDON, P.E.  
 DAVID C. HUFFMAN, P.E.  
 RODGER G. SIMON, R.S.

MUNICIPAL ENGINEERING  
 SUBDIVISIONS  
 LAND SURVEYS

9-00-087-A

# 3316

09-00-087-112-

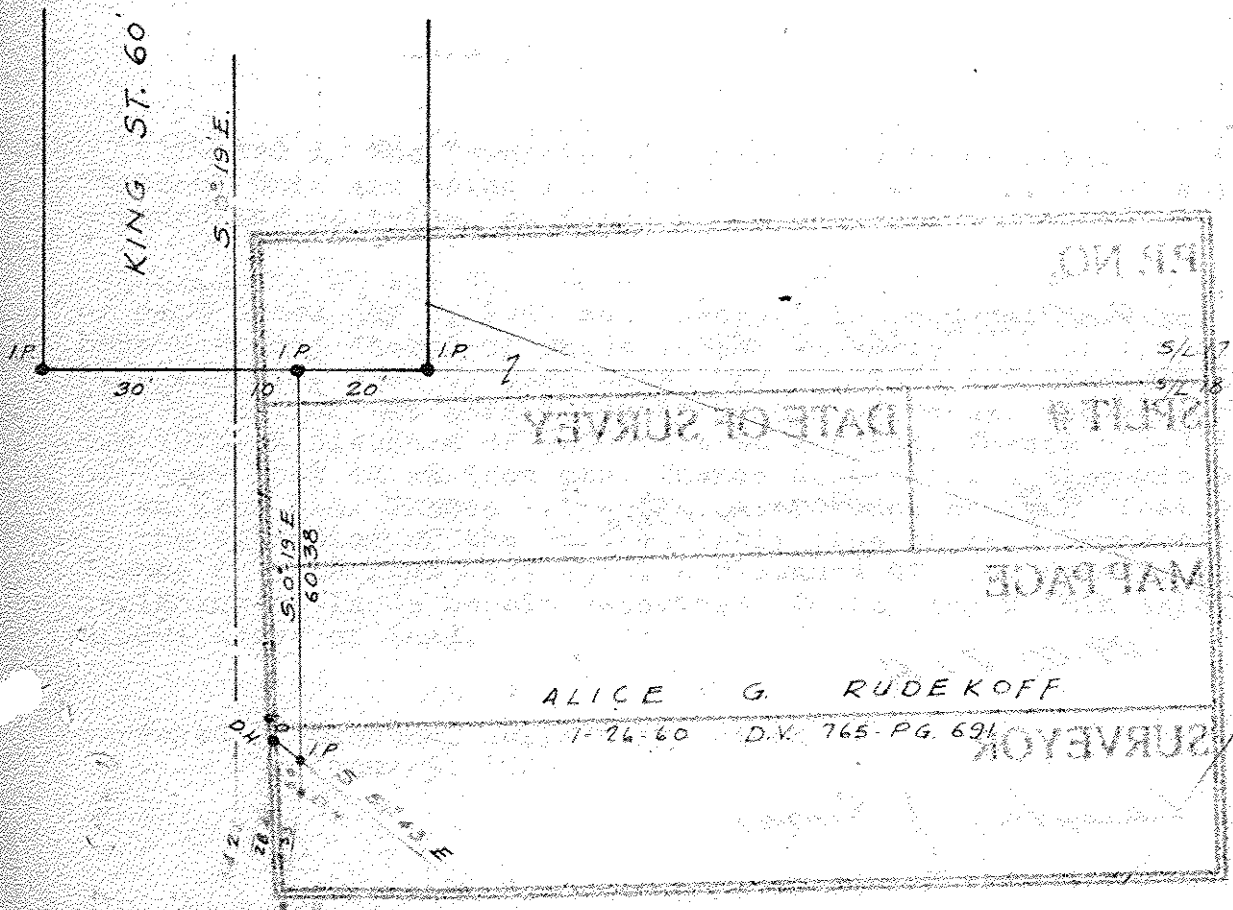

L. A. & R. S. ROSS  
 5-29-50 D.V. 527-PG 5  
 N 8° 10' 41" E 25.77  
 S 86° 00' 09" W 34.86  
 S 8° 33' W 54.19

SURVEY FOR H.A. BROADWELL  
 TWP. 23 S. R. 10 E. S. 34  
 CITY OF BERLIN, LOR. CO., OHIO  
 APR. 1968  
 LAUNDON, HUFFMAN & SIMON - SURVEYORS