

SURVEY FOR

NACSCORP INC.

PART OF O.L. 77 RUSSIA TOWNSHIP
CITY OF OBERLIN COUNTY OF LORAIN STATE OF OHIO

MARCH, 1990 SCALE 1"=60'

LAUNOON • SIMON • CAHL & ASSOC.
ENGINEERS SURVEYORS
106 MIDDLE AVE. ELYRIA, O. 44035
(216) 322-7625

RONALD GORDON &
ANDREW BALUNEK
V.1164 P.874

RONALD & BEVERLY BARKACS
V.986 P.915-917

RR TIE POST

130 REC.

1.P.Fd.

5.89° 23' 47" E.

540.10'

488.75' E

1.P.Fd.

30'

51.35'

1.P.Fd.

N.1° 24' 03" E.

443.54'

1.P.Fd.

N.45° 24' 07" E.
99.81'

1.P.Fd.

N.1° 24' 03" E.

182.34'

1.P.Fd.

N.89° 31' 10" W.

1052.48'

558.11'

S.1° 24' 03" W. 695.51'

OBERLIN ROAD 60'

PCL. No 2
4.5713 Ac.

PCL. No 1
8.1553 Ac.
#19149-A

1012

1013

10-1-90
#19149-A
#19121

APPROVED
LORAIN CO.
MAP DEPT.
DATE 9-11-90
PAGE 9-00-077-3
BY CAROLYN
FRANCIS
VOID
AFTER # 19121

1.P. IN M.B. Fd. & Used

EAST LORAIN STREET 60'



MAR 22

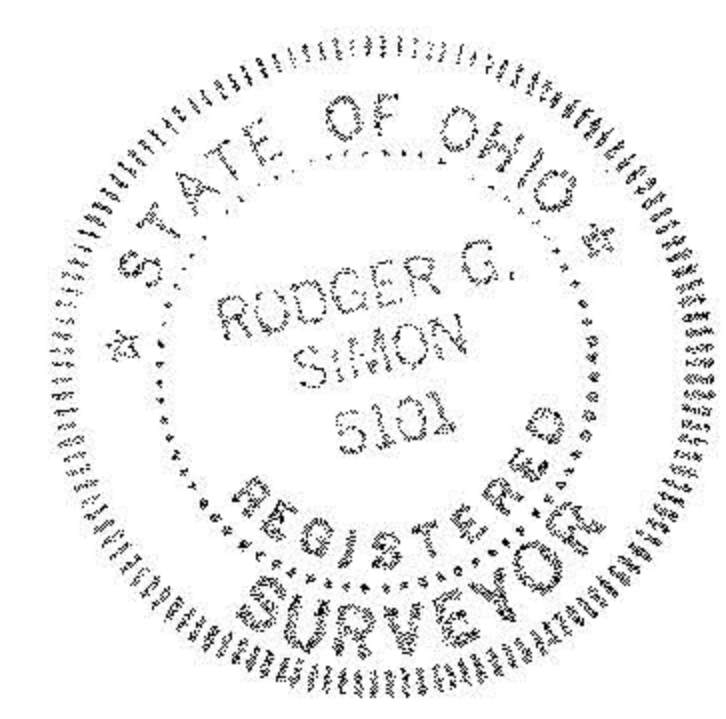

Rodger Simon

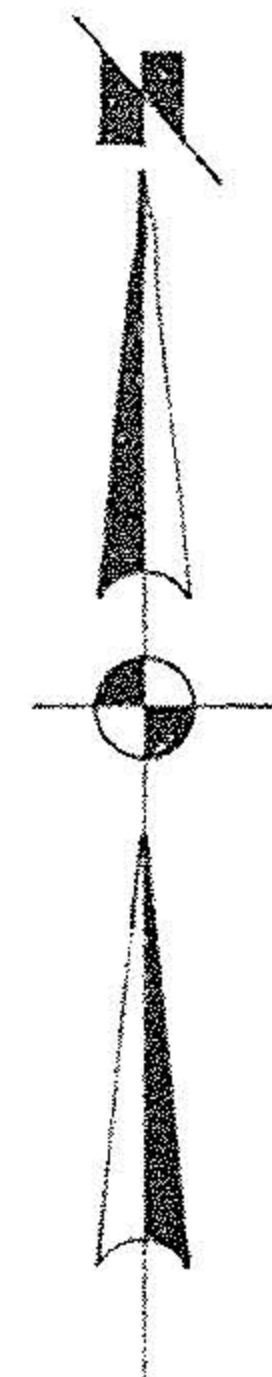

CITY OF OBERLIN
(FORMERLY PENN CENTRAL RR.)
V.1198 P.579
N.37° 24' 32" E.
871.39' E

1.P.Fd.

37.53'

494.37'

30'

