

KLEINOEDER-SCHMIDT

AND ASSOCIATES

ENGINEERS — SURVEYORS — CONSULTANTS IN LAND PLANNING
OHIO

ELYRIA - NORWALK - MEDINA

SURVEY

Sublot(s) _____

Subd'n _____

Township CARLISLE

Tract PART OF SECTION 3

Orig. Lot(s) _____

State of Ohio

County of LORAIN

Corporation _____

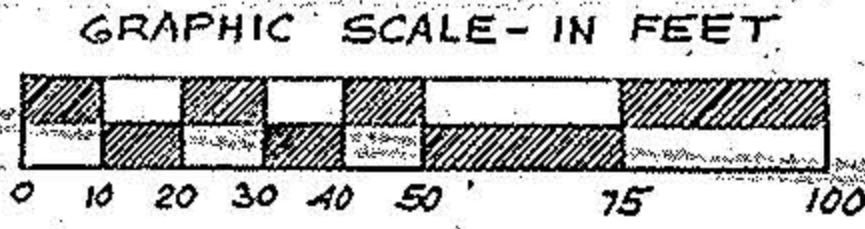

SCALE: 1"=50'

KANE IMPLEMENT & SUPPLY COMPANY
D.V. 408 P. 241

PAUL W. & MILDRED A. COFFIN
D.V. 1308 P. 111
(2nd. PCL.)

0.7268 AC.

(1st. PCL.)

PAUL W. & M.A. COFFIN
D.V. 925 P. 774

AMELIA SUNDERLAND
D.V. 156 P. 494



SEE DETAIL BELOW

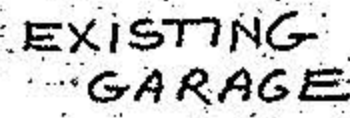

R=490.87 - STATE USED
Δ=11°55'09"
A=102.11'
T=51.24'
C=101.93'
C.B. N-24°39'21"-E

R=497.42'
Δ=5°34'17"
A=48.37'
T=24.20'
C=48.35'
C.B. N-34°38'17"-E

#16638

APPROVED
LORAIN CO.
DETAIL
SCALE: 1"=20'
3-14-86
10-00-003-F
BY C. FRANCIS
VOID AFTER

Prepared for:

PAUL W. COFFIN
701 OBERLIN ROAD
ELYRIA, OHIO

Scale: 1"=50'

Date: 11-19-85

Dr. by: K.V.S.

Job No 85-250

10-00-003-124
10-00-003-F